



# Chalklands, Howe Green, CM2 7TH

Council Tax Band G (Chelmsford City Council)

 5  5  4

£1,395,000 Freehold



This stunning five-bedroom family home, set on a south-facing plot of over a quarter of an acre, offers luxurious living and entertaining spaces.

The property has undergone extensive extensions and high-specification improvements, both internally and externally, including the addition of a recently finished outdoor heated pool with an external shower room. With almost 3000 sq ft of accommodation, this home provides the perfect space for modern family living.

Upon entering the property, you are greeted by a large and bright reception hall, which provides access to all the ground floor rooms. The living room, with its dual aspect, is a spacious and inviting space, featuring Korniche bi-fold doors that open onto the pool area and patio. Adjacent to the living room is a games room, also with bi-fold doors opening onto the pool area, creating a seamless indoor-outdoor flow.

The heart of this magnificent family home is the bespoke kitchen by Mason & Co, complete with an island unit, AEG appliances, Quooker hot tap, and CDA wine fridge. The kitchen leads to a separate utility room and opens into a light-filled dining/family space, featuring a large Korniche roof lantern and bi-fold doors that once again connect to the pool and outside entertainment area. The ground floor also includes a cloakroom, gymnasium, and study, providing ample space for work and relaxation.

Upstairs, a stylish returning staircase leads to a galleried landing and five well-appointed bedrooms. The principal bedroom enjoys a south-facing aspect, overlooking the rear garden via a Juliette balcony and boasts a dressing room and en-suite bathroom. Bedroom two also offers a dressing room and en-suite, while the remaining bedrooms are serviced by a family bathroom.

Externally, the property features an extensive driveway with parking for multiple vehicles, leading to a double garage. The fully enclosed rear garden benefits from a southerly aspect and features a new patio area and outdoor air-sourced heated swimming pool, surrounded by fossil mint sandstone paving. Adjacent to the pool area, there is an external shower and changing room, as well as a pool plant room. The rear of the house is adorned with extensive external lighting, creating a perfect environment for outdoor entertaining and relaxation. This exceptional family home offers a luxurious lifestyle with its high-quality finishes, spacious rooms, and the added bonus of an outdoor heated pool. Internal viewing is highly recommended to fully appreciate everything this property has to offer. Don't miss out on the opportunity to make this your new home.

Contact our agents today to arrange a viewing.

## LOCATION

Nestled in the heart of the picturesque Essex countryside, Howe Green Village offers an idyllic setting for those seeking a retreat away from the hustle and bustle of city life. With its rich history, stunning natural beauty, and close-knit community, Howe Green is truly a hidden gem waiting to be discovered. For nature enthusiasts, Howe Green is a paradise. The village is surrounded by lush green fields offering endless opportunities for leisurely walks and exploring the great outdoors. Take a stroll along the scenic footpaths and soak in the breathtaking views of the Essex countryside.

Despite its peaceful ambiance, Howe Green is far from isolated. The village benefits from excellent transport links and is just a few minutes from both A12 and A130 trunk roads and Sandon Park & Ride Station with easy access to the bustling city of Chelmsford, offering a wide range of amenities including shops, restaurants, and entertainment options. The nearby villages of Danbury and East Hanningfield also feature pubs, restaurants and a selection of shops together with Infant and Junior schooling.

If you're looking to make Howe Green your home, you'll be pleased to know that there is a range of properties available to suit different tastes and budgets. From charming cottages to modern family homes, there's something for everyone. Whether you're a first-time buyer, a growing family, or looking to downsize, Howe Green offers a variety of options to cater to your needs. Don't miss the opportunity to experience the charm and tranquility of Howe Green Village. With its rich history, stunning natural beauty, and vibrant community spirit, it's a place where you can truly feel at home. Come and discover this hidden gem in Essex - you won't be disappointed.

- Luxurious five bedroom family home
- Light filled open plan kitchen/dining/family space
- Galleried hall and landing
- Four Bathroom/Shower Rooms
- Quarter of an acre plot with south east facing rear aspect
- 3000 sq ft of high specification and reimagined accommodation
- Three reception rooms
- Spacious principal and guest bedrooms with en-suite and dressing rooms
- Outdoor heated pool with changing/shower room
- Double garage and parking for multiple cars



















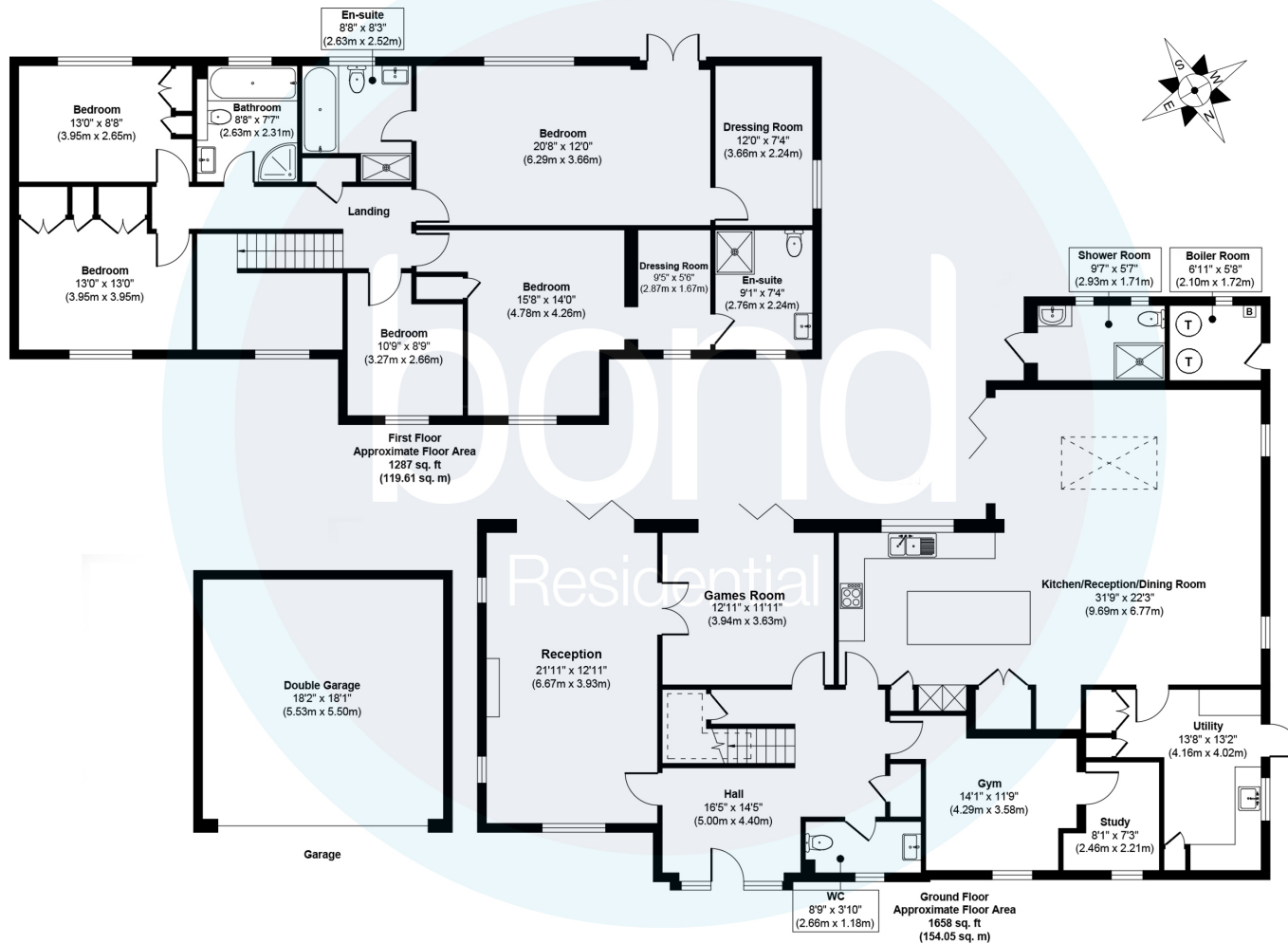

**Approx. Gross Internal Floor Area 2945 sq. ft / 273.66 sq. m**

Illustration for identification purposes only, measurements are approximate, not to scale.

Produced by Elements Property

Consumer Protection from Unfair Trading Regulations 2008 and the Business Protection from Misleading Marketing Regulations 2008. Bond Residential have made every effort to ensure that consumers and/or businesses are treated fairly and provided with accurate material information as required by law. We have not tested any apparatus, equipment, fixture, fitting or any services and as such are unable to verify they are in working order, fit for their purpose, or within the ownership of the seller or landlord. Neither have we been able to check the legal documentation to verify the legal status of the property. We therefore advise potential buyers or tenants to verify these matters with their own solicitors or other advisers.

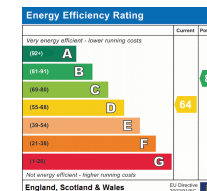

10, Maldon Road,  
Danbury, Essex, CM3 4QQ  
Telephone: 01245 222856  
Website: www.bondresidential.co.uk