



Maples Court is next to a large Waitrose store with a café. In addition, the Butts Close open space is close by and the area served by a local bus services and other facilities; including churches, library and the swimming centre. There is a communal lounge and a Manager together with a guest suite and communal laundry. Viewing recommended.

1 Bedroom Retirement Property £129,950 Leasehold

- Retirement apartment
- For the over 60's
- One bedroom
- Close to town
- Lovely gardens
- Chain free
- Lease and service charge TBC
- EPC rating C. Council tax band C



Maples Court, Bedford Road, Hitchin, Hertfordshire. SG5 1HF



Ground Floor

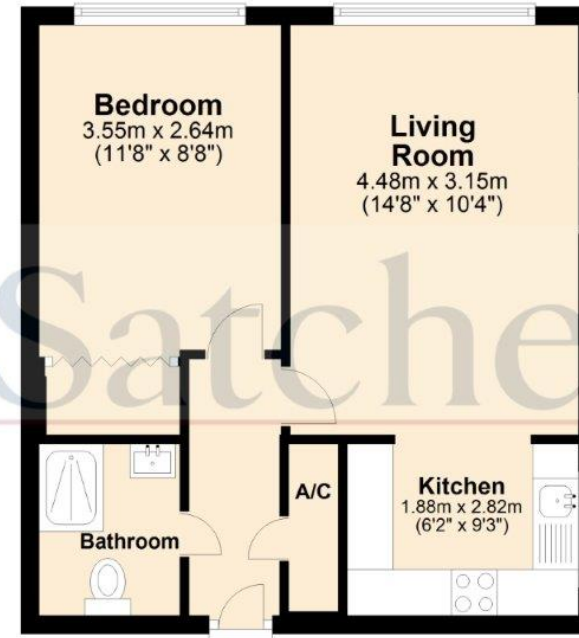

For illustrative purposes only - NOT TO SCALE - Measurements shown are approximate. The size and position of doors, windows, appliances and other features are approximate.
Plan produced using PlanUp.

These particulars are a guide only and do not constitute an offer or a contract. The floor plan is for identification purposes only and not to scale. All measurements are approximate and should not be relied upon if ordering furniture, white goods and flooring etc. We have presented the property as we feel fairly describes it but before arranging a viewing or deciding to buy, should there be anything specific you would like to know about the property please enquire. Satchells have not tested any of the appliances or carried out any form of survey and advise you to carry out your own investigations on the state, condition, structure, services, title, tenure, and council tax band of the property. Some images may have been enhanced and the contents shown may not be included in the sale. Satchells routinely refer to 3rd party services for which we receive an income from their fee. If you would like us to refer you to one of these services please ask one of our staff who will pass your details on. We advise you check the availability of the property on the day of your viewing.