



# Peppermint Road

Hitchin | Hertfordshire | SG5 1RY

[www.stonegate-estates.co.uk](http://www.stonegate-estates.co.uk)





# PEPPERMINT ROAD

## Property Description

Situated in a prime central location, this well-presented first-floor apartment offers stylish and convenient living just moments from Hitchin town centre and mainline train station.

The property features a spacious open-plan living area with a Juliet balcony, creating a bright and airy space ideal for relaxing or entertaining. The modern kitchen is fitted with contemporary units and integrated appliances.

There are two double bedrooms, including a generous master bedroom with ensuite shower room, plus a further well-appointed bathroom.

Additional benefits include a video entry intercom system for added security and an allocated underground secure parking space.

With its fantastic location, just a short stroll from Hitchin's vibrant shops, restaurants, and excellent transport links to London, this apartment is perfectly suited to professionals, downsizers, or investors alike.

**£295,000 Leasehold**





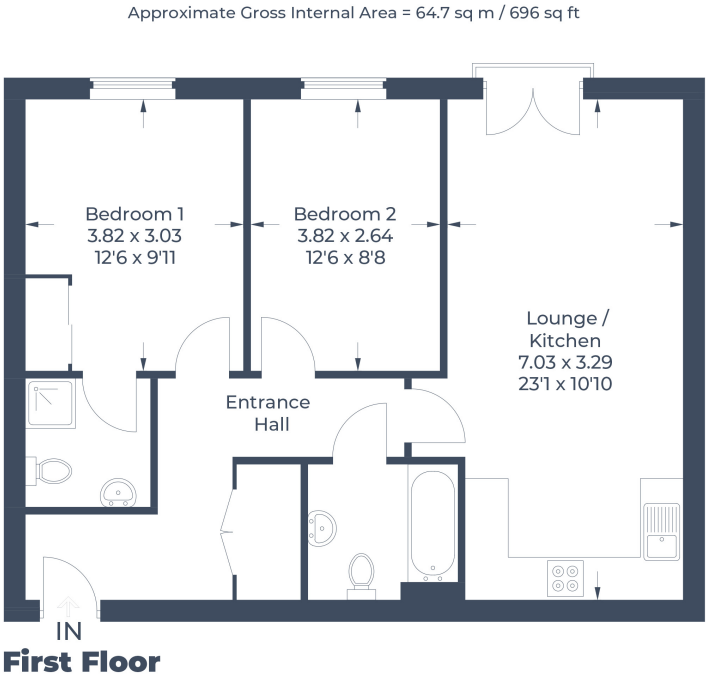

Illustration for identification purposes only,  
measurements are approximate, not to scale.  
© CJ Property Marketing Produced for Stonegate Estates





- Two Bedroom Apartment
- Juliet Balcony
- Under Ground Secure Parking
- No Chain
- Town Centre Location
- En suite to master bedroom
- Ideal First Time Buy or Investment

EPC Rating: C

Stonegate Estate Agents

01462 438979

[sales@stonegate-estates.co.uk](mailto:sales@stonegate-estates.co.uk) | [www.stonegate-estates.co.uk](http://www.stonegate-estates.co.uk)

