

7 Hawthorn Close, Petts Wood, Orpington, Kent, BR5 1LJ

Property Images









Ground Floor

Approx. 66.5 sq. metres (715.9 sq. feet)

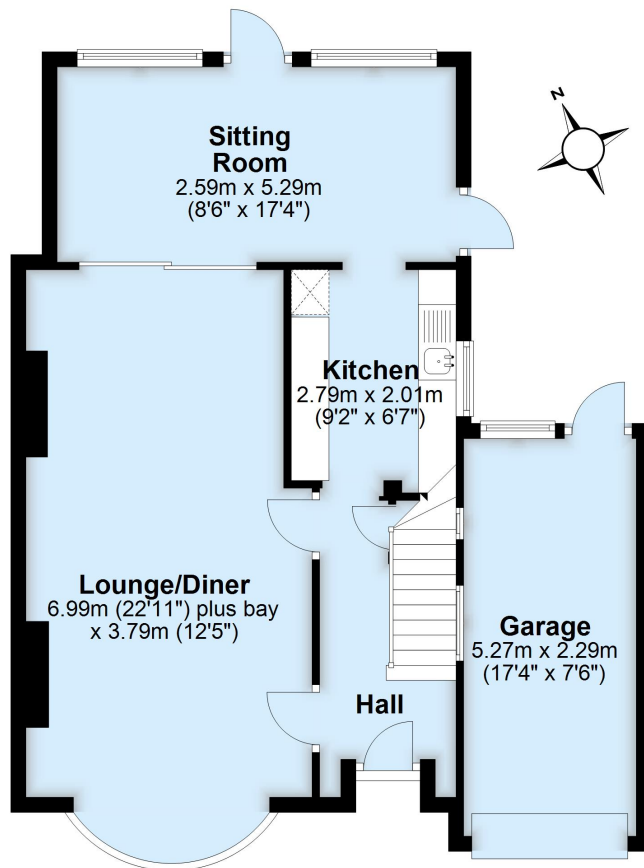

First Floor

Approx. 40.2 sq. metres (432.6 sq. feet)

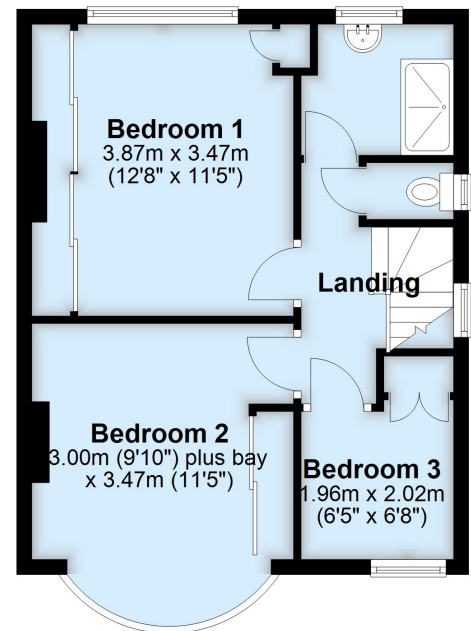

Total area: approx. 106.7 sq. metres (1148.6 sq. feet)

This plan is for general layout guidance and may not be to scale.
Plan produced using PlanUp.