



Amphill Road, Shefford, Bedfordshire. SG17 5BB





3 Bedroom Chalet

Guide Price £525,000 Freehold

This lovely three bedroom detached chalet style bungalow is conveniently located near Shefford's town centre. This property has been beautifully enlarged and is situated on a great corner site plot with fantastic gardens all around.

- Three double bedrooms
- Chalet style bungalow
- Corner plot
- Short stroll into Shefford town centre
- Driveway for multiple vehicles
- Ensuite shower room to principal bedroom
- Modernised throughout - move in condition
- Utility room
- Set off on private road
- EPC rating D. Council tax band F

Ground Floor

Entrance Hallway:

Vast open space with stairs in front and all rooms off too the main entrance. Laid with carpet. Radiator.

Living Room:

Dual aspect room with log burner fireplace and entrance to conservatory.

Conservatory:

Brick built base with tiled flooring and stain glass windows.

Kitchen:

Stone tiled flooring with fitted worktops comprising of a oven with hob built in, stainless steel sink wash basin, overlooking garden and home to a four seater table.

Office:

Laid with carpet. Radiator and fitted curtains.

Dining Room:

Large airy, dual aspect room with multiple uses but currently house six seater table.

Utility Room:

Range of fitted worktops and units either side with radiator.

First Floor

Principal Bedroom:

Substantial room with fitted wardrobes and ensuite shower room which consist of rainfall shower, low level flush WC and wash hand basin.

Bedroom Two:

Double room with built in cupboard storage and radiator.

Bedroom Three:

Double room with fitted wardrobes and radiator.

Family Bathroom:

Modernised suite comprises of fitted bath tub, low level flush WC and wash hand basin.

Outside

Front Garden:

Paved driveway with garage and large frontage mainly laid to lawn. Side access to rear garden

Rear Garden:

Laid mainly with grass lawn with a variety of trees, plants and shrubs.

Agents Note:

Draft particulars yet to be approved by vendor and may be subject to change.





These particulars are a guide only and do not constitute an offer or a contract. The floor plan is for identification purposes only and not to scale. All measurements are approximate and should not be relied upon if ordering furniture, white goods and flooring etc. We have presented the property as we feel fairly describes it but before arranging a viewing or deciding to buy, should there be anything specific you would like to know about the property please enquire. Satchells have not tested any of the appliances or carried out any form of survey and advise you to carry out your own investigations on the state, condition, structure, services, title, tenure, and council tax band of the property. Some images may have been enhanced and the contents shown may not be included in the sale. Satchells routinely refer to 3rd party services for which we receive an income from their fee. If you would like us to refer you to one of these services please ask one of our staff who will pass your details on. We advise you check the availability of the property on the day of your viewing.



Ground Floor



First Floor

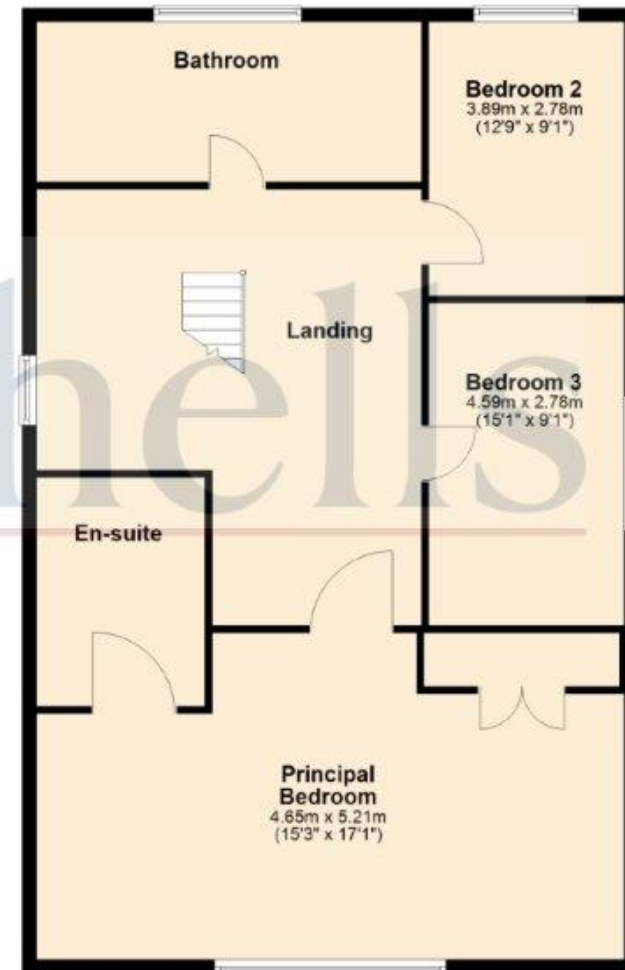

For illustration purposes only - NOT TO SCALE - Measurements shown are approximate. The size and position of doors, windows, appliances and other features are approximate.
Plan produced using PlanUp.