

TO LET

£725 pcm



Brunswick Court, Swansea, West Glamorgan SA1 4HZ

- Two Bedroom Apartment
- Investment Opportunity
- Second Floor
- Central Swansea Location



Bay Estate Agents Ltd
29, Camona Drive, Maritime Quarter, Swansea, SA1 1YJ

01792 645566
mail@bayestateagents.com



PROPERTY DESCRIPTION

Available December 2024.

Bay are pleased to offer for rental this second floor, two bedroom apartment, situated within walking distance of the city centre. The apartment comprises hallway, two bedrooms, bathroom, living room and kitchen with washing machine, oven and hob. Gas central heating. Allocated parking space. Available unfurnished. Virtual viewing video available!

Deposit: £1087.5(£1450 - student lets). Term: 6 Months(+) Council Tax:C EPC -C. Holding Deposit -£166



ROOM DESCRIPTIONS

Ground Floor

Bedroom

Bedroom

Bathroom

Reception

Kitchen



FLOORPLAN & EPC



Duke Street, Swansea, SA1

Approximate Area = 552 sq ft / 51.2 sq m

For identification only - Not to scale

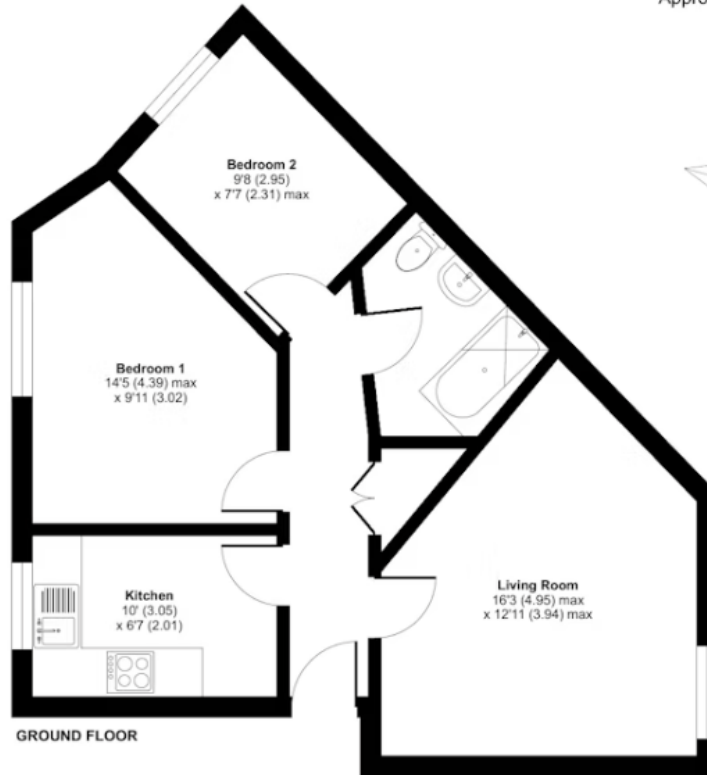

Floor plan produced in accordance with RICS Property Measurement Standards incorporating International Property Measurement Standards (IPMS2 Residential). © ritchecom 2023. Produced for Movewise. REF: 1012556



| Energy Efficiency Rating | | Current | Potential |
|---|--|-------------------------|-----------|
| Very energy efficient - lower running costs | | | |
| (92-100) A | | | |
| (81-91) B | | | |
| (69-80) C | | 76 | 76 |
| (55-68) D | | | |
| (39-54) E | | | |
| (21-38) F | | | |
| (1-20) G | | | |
| Not energy efficient - higher running costs | | | |
| England, Scotland & Wales | | EU Directive 2002/91/EC | |

Bay Estates & Lettings Agents

29, Camona Drive, Maritime Quarter, Swansea, SA1 1YJ

01792 645566

mail@bayestateagents.com