

Haygrove Close

Warminster, BA12 8SL

COOPER
AND
TANNER



£335,000 Freehold

 2  1  1 EPC D

Description

An pleasing two bedroom detached bungalow that is located on the popular Frome side of the town and close to a Co-op and local walks. This lovely bungalow has a fitted kitchen with a range of wall and base units along with integrated appliances. The home benefits from double glazing and gas fired central heating.

Outside, you will find low maintenance gardens incorporating paved patios and gravel areas with some shrubs and planting. To the side a driveway offers parking and access to the single garage. NO CHAIN.

Haygrove Close, Warminster, BA12

Approximate Area = 777 sq ft / 72.2 sq m (includes garage)

For identification only - Not to scale

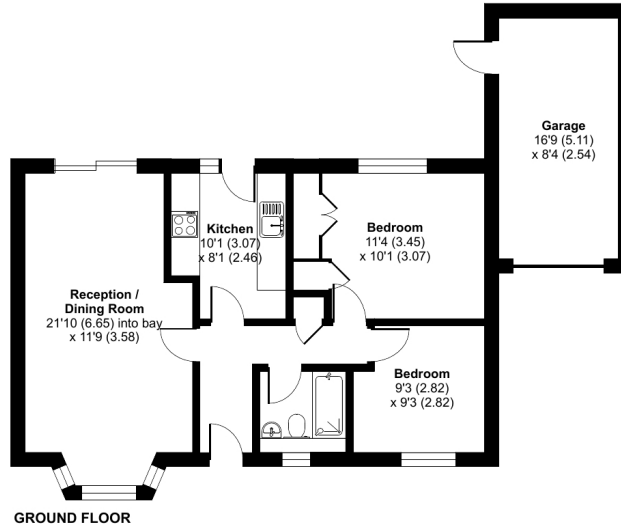

Floor plan produced in accordance with RICS Property Measurement Standards incorporating International Property Measurement Standards (IPMS2 Residential). © richcom 2024. Produced for Cooper and Tanner. REF: 1183743



Features

- No chain
- Two bedrooms
- Detached bungalow
- Gas central heating
- Low maintenance gardens
- Single garage
- Double glazing
- Popular Frome side of the town
- Close to local Co-op shop
- Close to walks and local shop

Local Information

- Council Tax Band D
- Tenure Freehold
- EPC Rating D

WARMINSTER OFFICE

Telephone 01985 215579

48-50, Market Place, Warminster, Wiltshire BA12 9AN

warminster@cooperandtanner.co.uk

**COOPER
AND
TANNER**

Important Notice: These particulars are set out as a general outline only for the guidance of intended purchasers and do not constitute, nor constitute part of, an offer or contract. All descriptions, dimensions, reference to condition and necessary permissions for use and occupation, warranties and other details are given without responsibility and any intending purchasers should not rely on the m as statements or representations of fact but must satisfy themselves by inspection or otherwise as to the correctness of each of them.

