



**4 Wharf Lane, Old Stratford, Milton Keynes,
Northamptonshire, MK19 6AD**

£325,000 Freehold

- Two Double Bedrooms
- Stylish Converted Cottage
- Allocated Parking
- Refurbed Kitchen & Bathrooms
- Sought After Area
- Private Garden & Communal Area
- Chain Free
- EPC Rating





Disclaimer

Whilst we have endeavoured to prepare our sales particulars accurately none of the services, appliances or equipment have been tested. A buyer should satisfy themselves on such matters prior to purchase. Any measurements or distances mentioned in these particulars are for guide reference only. If such particulars are fundamental to a purchase, buyers should rely on their own enquiries. All enquiries should be directed to Elevation Estate Agents in the first instance.

Ground Floor

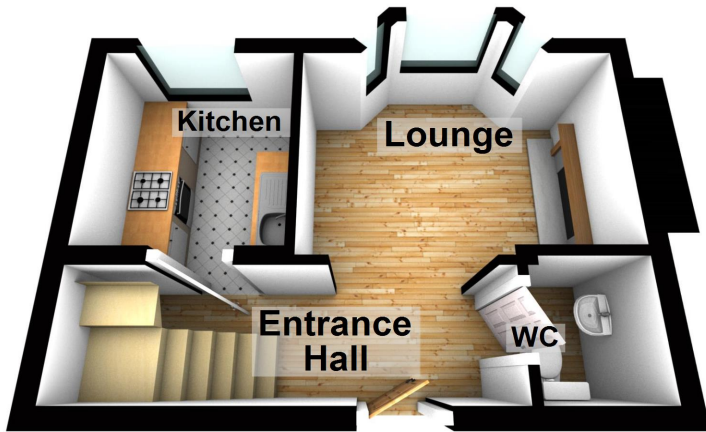

First Floor



Floor plans are for layout purposes only
Plan produced using PlanUp.