

Truuli



Gloucester Road, Croydon, Surrey, CR0 2DW

£375,000 Freehold

- Corridor upon entry
- Tiled bathroom and kitchen
- Desk space on the upstairs landing
- Two double bedrooms
- Close proximity to Selhurst Station & East Croydon Station
- Low maintenance rear garden
- Rear access from the garden
- Chain free

Southbridge Place, Surrey, CR0 4HA

Tel: 0330 043 0002

Email: save@truuli.co.uk Web: www.truuli.co.uk

Gloucester Road, Croydon, Surrey, CR0 2DW

£375,000 Freehold

Vendor's comments: "When I initially looked around this house, I knew it would be the perfect first home. Walking through the front door into a corridor, instead of the living room, was the first sign. The unique upstairs layout and bathroom were second.

The location is great. You're near a Co-op and a few minutes walk from a Lidl. You are a couple of minutes' walk from Selhurst station, which gets you into Victoria and London Bridge. It's also a 15-minute walk into East Croydon, where you can get faster trains into central London and quick trains to Gatwick. Norwood Junction is a short bus ride away, which has the Overground."

Ground Floor
373 sq.ft. (34.6 sq.m.) approx.

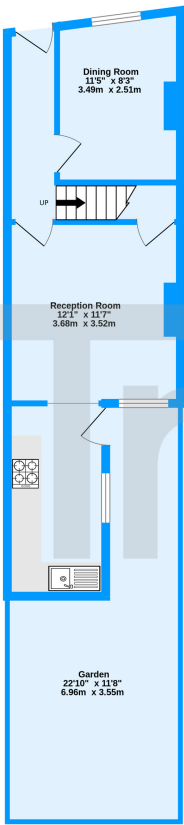

1st Floor
376 sq.ft. (34.9 sq.m.) approx.

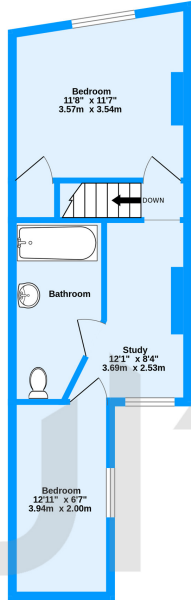

Gloucester Road, Croydon, CR0
TOTAL FLOOR AREA: 749 sq.ft. (69.5 sq.m.) approx.
Measurements are approximate. Not to scale. Illustrative purposes only
Made with Metroplex ©2024

