



Ridge Road, Letchworth Garden City, Hertfordshire, SG6 1PT

O.I.E.O £425,000 Leasehold

Satchells





Step Inside

Ridge Road

This attractive early 20th-century cottage reflects the distinctive architectural style associated with the original Garden City movement and occupies a particularly appealing setting within the development. The accommodation is arranged over two floors and offers comfortable, well-proportioned living space. The ground floor includes a welcoming sitting room providing an ideal space for relaxing or entertaining, while the modern kitchen has been thoughtfully fitted and incorporates a breakfast bar, creating a practical and sociable layout. Also located on the ground floor is a beautifully presented bathroom featuring a freestanding bath, adding a touch of traditional character in keeping with the age of the property. Upstairs, the first floor provides three bedrooms, offering flexible accommodation suited to a variety of lifestyles including families or those requiring home working space. The property has been updated over time whilst retaining its original charm, and further benefits from double glazing and gas-fired central heating.



About Letchworth Garden City

Ridge Road

The property is situated just off Ridge Road within comfortable walking distance of the town centre and mainline railway station. Letchworth Garden City, the world's first Garden City, was designed to combine the advantages of town living with green open spaces. Today it offers a wide range of shops, leisure facilities, schools and parks. The town's railway station provides regular services to London King's Cross railway station in around 29 minutes, with direct services also running to Cambridge. For drivers, Junction 9 of the A1(M) is approximately 1.5 miles away.





Step Outside

Ridge Road

The cottage sits behind a traditional picket fence with a lawned front garden enhanced by established planting and ornamental shrubs, contributing to the attractive street scene. The rear garden extends to approximately 70ft (21.5m) and is accessed via a shared passageway to the side of the terrace. The garden is mainly laid to lawn with a paved seating area, enclosed by fencing and mature hedging to create a private and peaceful outdoor space. A timber garden shed is located at the far end. Residents benefit from parking within the crescent and in nearby lay-bys surrounding the central green.



Ground Floor

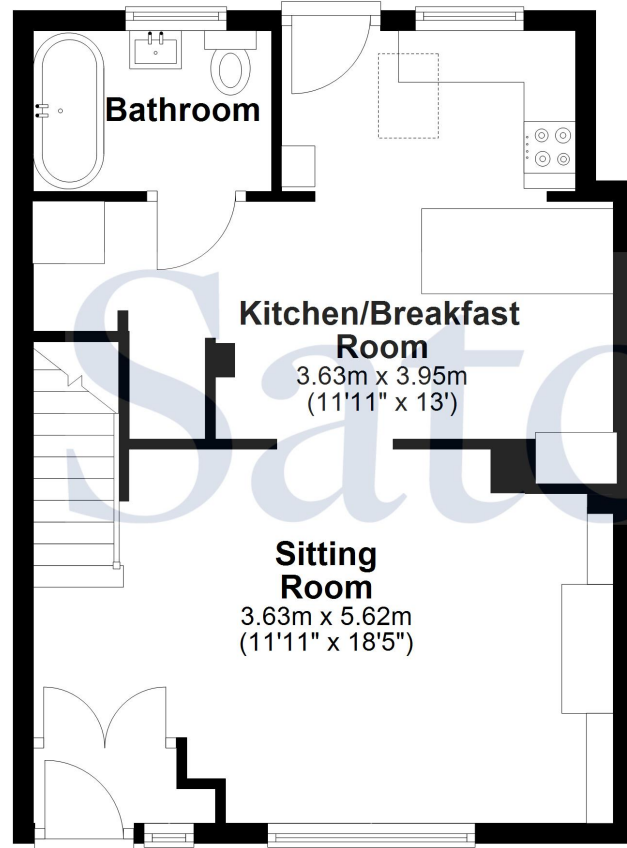

First Floor

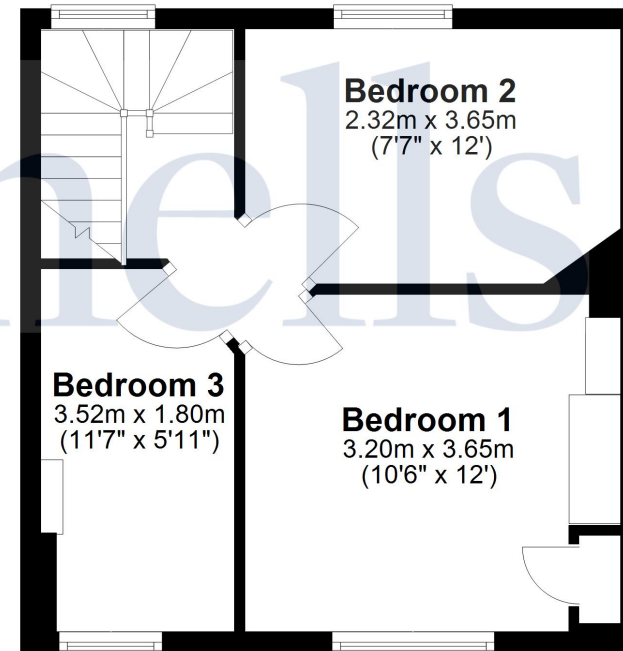

For illustration purposes only - Measurements shown are approximate. The size and position of doors, windows, appliances and other features are approximate.
Plan produced using PlanUp.



These particulars are a guide only and do not constitute an offer or a contract with. The floor plan is for identification purposes only and not to scale. All measurements are approximate and should not be relied upon if ordering furniture, white goods and flooring etc. We have presented the property as we feel fairly describes it but before arranging a viewing or deciding to buy, should there be anything specific you would like to know about the property please enquire. Satchells have not tested any of the appliances or carried out any form of survey and advise you to carry out your own investigations on the state, condition, structure, utilities and services, title, tenure, and council tax band of the property. Some images may have been enhanced and the contents shown may not be included in the sale. Some content may have been created with the use of AI. Satchells routinely refer to 3rd party services for which we receive an income from their fee. If you would like us to refer you to one of these services please ask one of our staff who will pass your details on. We advise you check the availability of the property on the day of your viewing.

Satchells



Station Place, Letchworth Garden City, SG6 3AQ
01462 480077
letchworth@satchells.co.uk
www.satchells.com

Satchells