

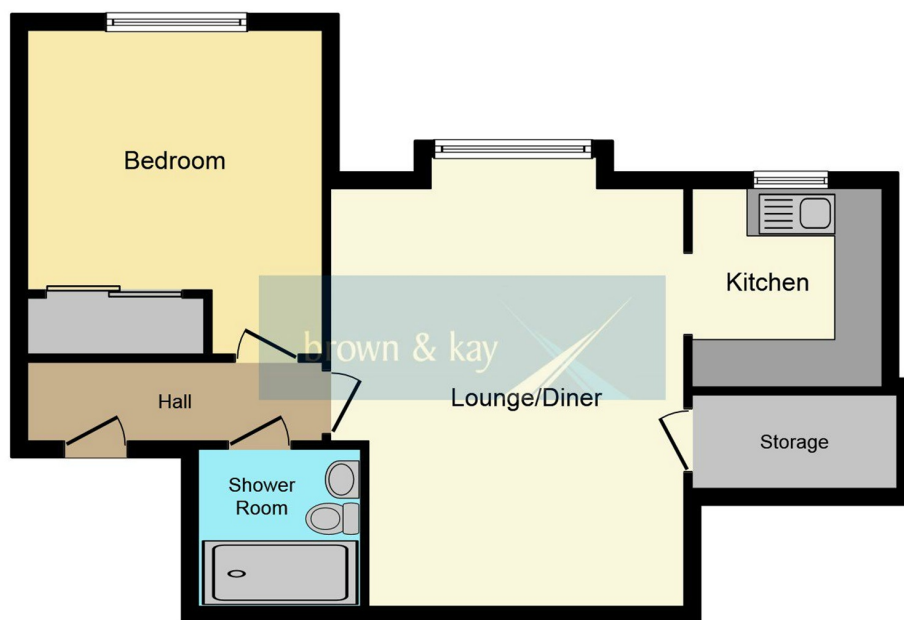

## FLAT 15 GRACE DARLING HOUSE, 9 VALLIS CLOSE, POOLE BH15 1XY

£120,000

- RETIREMENT APARTMENT
- ONE BEDROOM
- SHOWER ROOM
- FIRST FLOOR
- RE-FITTED KITCHEN
- TOWN CENTRE LOCATION



**Floor Plan**

This floor plan is for illustration purposes only and may not be representative of the property. The position and size of doors, windows and other features are approximate. Unauthorized reproduction prohibited. © PropertyBOX

Occupying a brilliant location within Baiter Park this one double bedroom first floor retirement flat is offered with no forward chain. The property also has an on-site house manager, communal lounge and laundry room. Specifically for the over 60's!

### ENTRANCE HALL

Entry system.

### LOUNGE

15' 8" x 13' 8" (4.78m x 4.17m) Double glazed rear window overlooking the communal gardens, electric heater, walk-in storage cupboard.

### KITCHEN

7' 10" x 6' 7" (2.39m x 2.01m) Double glazed window to the rear overlooking the gardens. Re-fitted kitchen with a range of wall and base units, integrated fridge/freezer, inset hob with oven below, integrated dishwasher.

### BEDROOM

14' 10" x 8' 7" (4.52m x 2.62m) Double glazed window to the rear aspect, double wardrobe.

### SHOWER ROOM

Oversized shower cubicle, low level w.c. and wash hand basin, tiled walls, extractor.

### OUTSIDE

There are various communal garden areas including drying and seating areas.

### TENURE - LEASEHOLD

Length of lease - approximately 61 years remain  
Maintenance & Ground Rent - £2,950.14 per annum including water and sewerage rates.

### COUNCIL TAX - BAND C

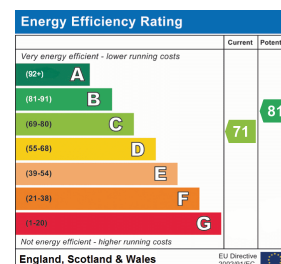

These particulars, whilst believed to be accurate are set out as a general outline only for guidance and do not constitute any part of an offer or contract. Intending purchasers should not rely on them as statements or representation of fact, but must satisfy themselves by inspection or otherwise as to their accuracy. We have not carried out a detailed survey nor tested the services, appliances and specific fittings. Room sizes should not be relied upon for carpets and furnishings. The measurements given are approximate. No person in this firm's employment has the authority to make or give any representation or warranty in respect of the property.