



Stock Road | Billericay | £350,000



# Stock Road

Billericay | Essex | CM12 0RT

The Property Specialists are delighted to offer for sale this immaculate two bedroom ground floor apartment for the over 55's, situated in a convenient location, close to local amenities and on bus routes to Billericay High Street. This modern development benefits from security entry systems and concierge service together with gated access, landscaped communal gardens and secure parking.

Upon entering the flat you are met by a spacious entrance hallway leading to all accommodation, this hallway also offers a good sized storage cupboard alongside an airing cupboard. To your left you find the great sized four piece bathroom, offering a stand alone shower and bath tub, and is finished off by a lovely grey hard wood effect floor with detailed tiling to the walls. Continuing through the property on the freshly laid carpets you soon find the bedrooms. Both of these rooms allow space for double beds, with the master benefitting from large fitted wardrobes.

The wow factor of this property comes from the open plan kitchen/living area which is consumed by natural light from the French doors giving access to a private patio area. The kitchen comprises of a range of integrated appliances including a fridge freezer and dishwasher, and is finished off with base and eye level units and a wood effect worksurface. This Room also offers ample space for a dining table or extra storage units. To the rear of the property you have French doors leading to a sunny west facing patio area giving you your own outside space to enjoy on the sunny days. Residents also have access to communal lounges, kitchen, a games room and there are lifts to all floors.

An internal viewing is highly recommend to see the size and quality on offer, call 01277 654446 to arrange now.





- Spacious Ground Floor Apartment
- Abundance Of Built In Storage
- Open Plan Kitchen / Diner / Living Room
- Four Piece Bathroom
- French Doors Opening To Patio Area
- Large Main Bedroom With Fitted Wardrobes
- Communal Lounge And Games Room
- Residents Parking Area
- Secure development offering independent living for the over 55`s
- Close To Local Amenities



## Ground Floor

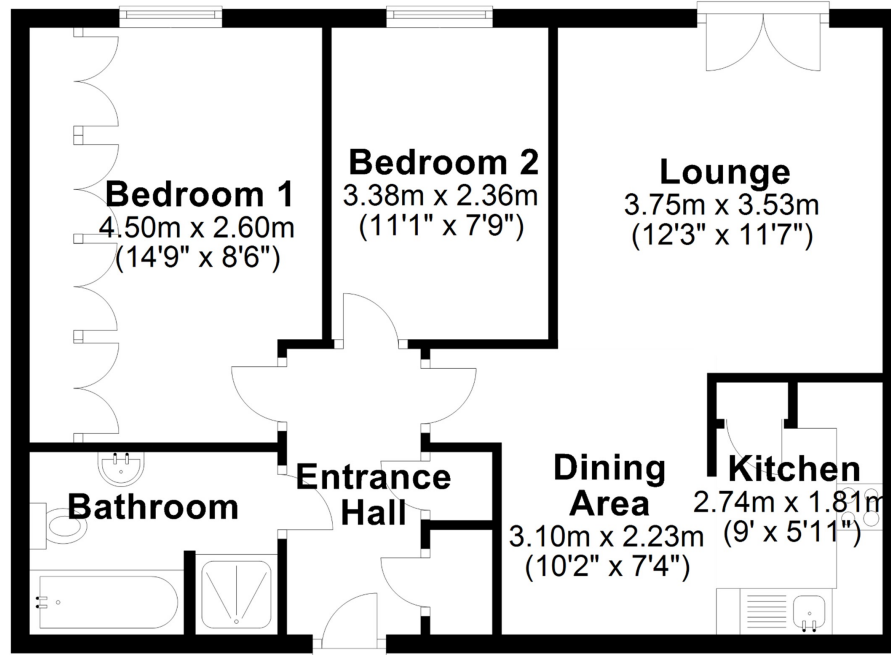

**APPROX INTERNAL FLOOR AREA  
61 SQ M 657 SQ FT**

This plan is for layout guidance only and is  
**NOT TO SCALE**

Whilst every care is taken in the preparation  
of this plan, please check all dimensions,  
shapes & compass bearings before making  
any decisions reliant upon them.

**Copyright The Property Specialists**



Viewing strictly by appointment with The Property Specialists



Making Moving Home  
**Less Stressful**

135 High Street, Billericay,  
Essex, CM12 9AB

**Tel: 01277 654446**

[sales@thepropertyspecialists.co.uk](mailto:sales@thepropertyspecialists.co.uk)