

## Grenville Court, Kent Avenue, London, W13

Approximate Floor Area = 60.1 sq m / 647 sq ft

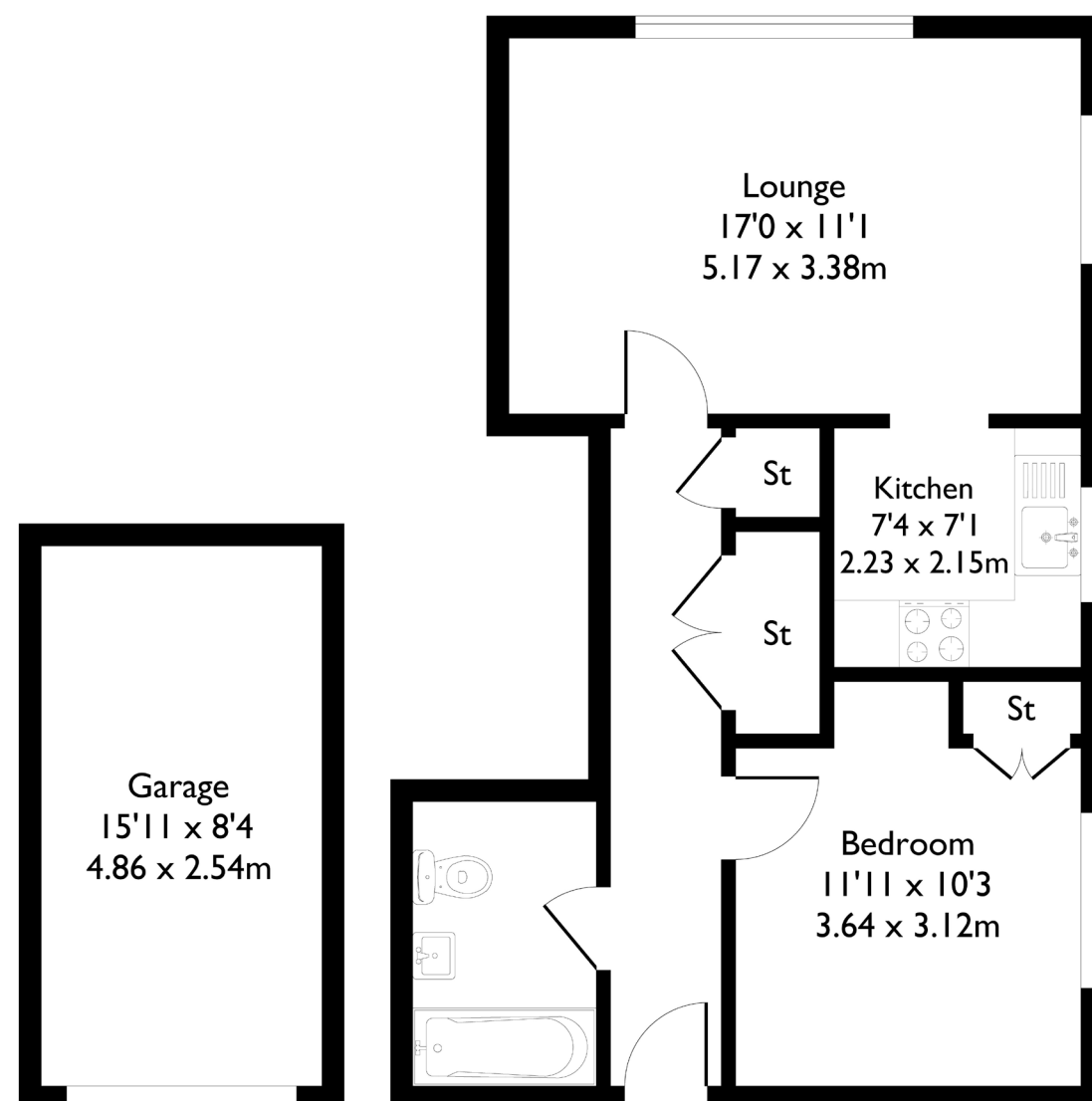
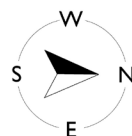

### 1 BEDROOM FLAT

## Kent Avenue, W13

### £399,950

Welcome to this well-presented one-bedroom, one-bathroom ground floor flat, ideally located in the heart of Ealing. The home offers a separate kitchen and living area, along with the added benefit of a garage. The property also has free off street parking.

Conveniently positioned just five minutes from the amenities of Pitshanger Lane, the property also benefits from excellent transport links, with buses providing direct access to Ealing Broadway within approximately ten minutes.

### FEATURES

- Share Of Freehold
- One Bedroom
- One Bathroom
- Large Communal Gardens
- Pitshanger Lane Amenities Closeby
- West Ealing Station (Elizabeth Line) 15 min walk
- North Ealing Primary School
- EPC Rating C



1 BEDROOM FLAT

# Kent Avenue, W13

## £399,950

West Ealing Station (Elizabeth Line) is within a comfortable 15-minute walk, offering swift connections into Central London.

Surrounded by green open spaces, including Pitshanger Lane Park, the property also provides easy access to the A40 for motorists. The area is well served by local schools, with North Ealing Primary School within the catchment.

EPC Rating C.

