



Rosemont Close, Letchworth Garden City,
Hertfordshire, SG6 4XR

£175,000

Leasehold (to be confirmed)

- First Floor Apartment
- No Upward Chain
- Ideal First Time Buy or Investment
- Close Proximity to Town Center
- Easy Access to Main Line Train Station
- Residents & Visitors Parking
- EPC Rating C





Floor Plan

Approx. 31.7 sq. metres (341.5 sq. feet)

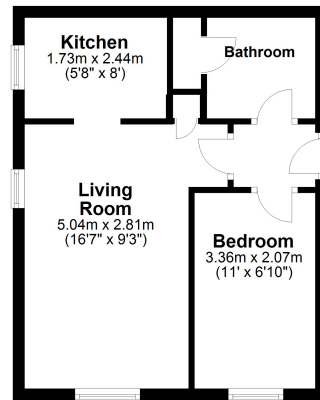

Total area: approx. 31.7 sq. metres (341.5 sq. feet)

All measurements shown are approximate and for guidance only. Garages and workshops are not included in any gross floor areas unless integral to the main building where they will be included. Plan produced using PlanUp.

Energy Efficiency Rating

	Current	Potential
<i>Very energy efficient - lower running costs</i>		
(92-100) A		
(81-91) B		
(69-80) C	77	81
(55-68) D		
(39-54) E		
(21-38) F		
(1-20) G		
<i>Not energy efficient - higher running costs</i>		
England, Scotland & Wales	EU Directive 2002/91/EC	