



**Thurman Lodge
Salisbury Avenue
East Leake
Loughborough
Nottinghamshire
LE12 6NW**

Offers In Excess Of £142,000

bettermove

Salisbury Avenue

Loughborough

Bettermove are proud to present this 2 bedroom retirement flat in Loughborough available with no forward chain.

The property benefits from double glazing, gas central heating throughout and has off street parking available.

The council tax band is B.

This is a leasehold property with 125 years on the lease from 2006; the ground rent is £200pa and the service charge is £226.71pcm.

The interior of this beautifully presented property comprises a spacious living room, fitted kitchen, 2 bedrooms and the bathroom. The exterior boasts communal gardens, perfect for enjoying the summer months.

Located in the popular town of Loughborough, the property is close to a range of amenities, including shops, supermarkets, restaurants and pubs. Excellent transport connections can be found from the M1, A6 and local bus routes.

This exciting opportunity should not be missed! All enquiries can be made through Bettermove on 0330 004 0050.

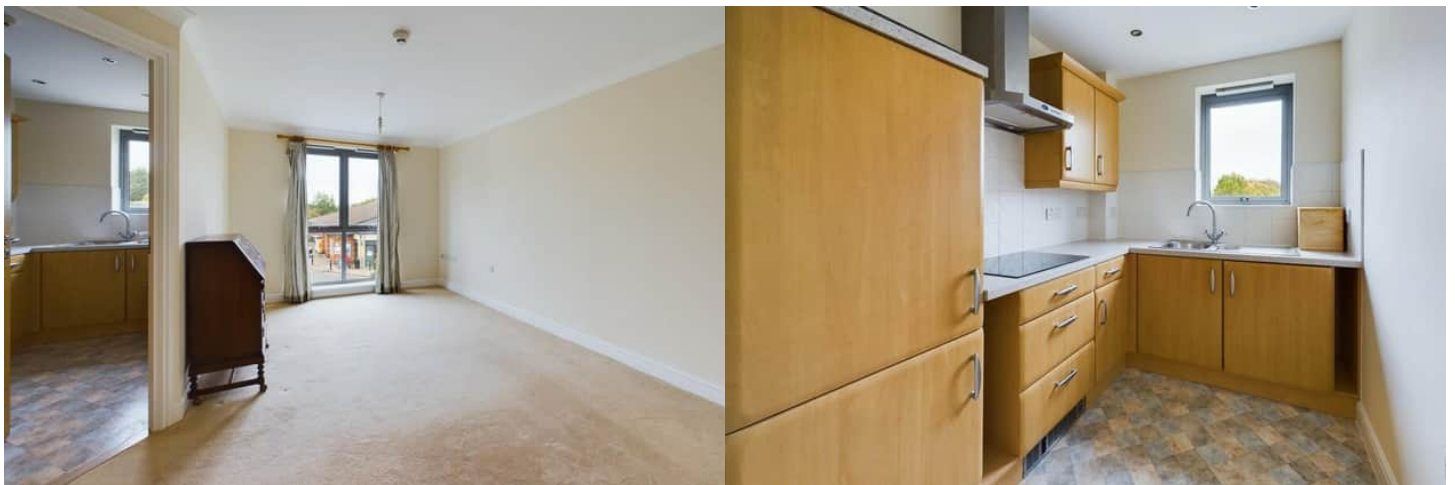

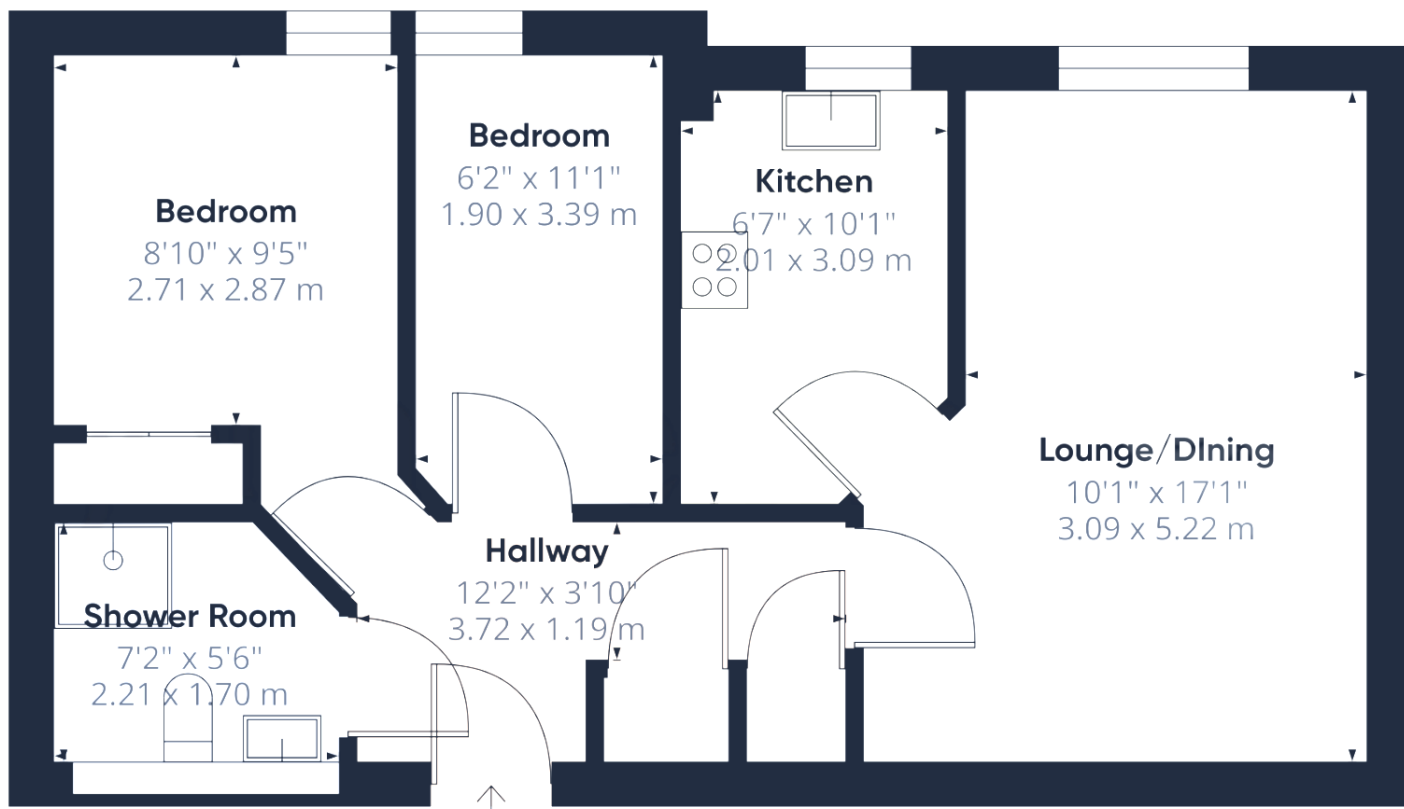



20-22 Bridge End, Leeds, LS1 4DJ
t: 0330 004 0050 e: hello@bettermove.co.uk
www.bettermove.co.uk