



Oulton Crescent, Potters Bar, Hertfordshire, EN6

£639,950

- SEMI DETACHED FAMILY HOME
- OFF STREET PARKING X 3
- L-SHAPE KITCHEN DINER
- TEN MINS WALK TO DAME ALICE OWENS
- WALKING DISTANCE TO POTTERS BAR MAINLINE STATION
- DOWNSTAIRS DOUBLE BEDROOM WITH EN-SUITE SHOWER ROOM
- ELECTRIC CAR CHARGE POINT
- WORKSHOP TO REAR GARDEN WITH ELECTRIC (NOT TESTED)
- GOOD SCHOOL CATCHMENT AREA

Oulton Crescent, Potters Bar, Hertfordshire, . EN6

£639,950 Freehold

This Four bedroom semi detached home is ideally located moments from shops and amenities and Furzefield Leisure Centre. The property benefits from an L shape living room, extension to the rear featuring large kitchen diner, plus a double bedroom with an en- suite shower room on the ground floor. The first floor benefits from two double bedrooms, a single bedroom and fully tiled family bathroom. Externally the home has off street parking for three cars to the front with electric car charging point and a private rear garden with decked area, lawn and workshop with power (not tested) to rear.

Viewing advised

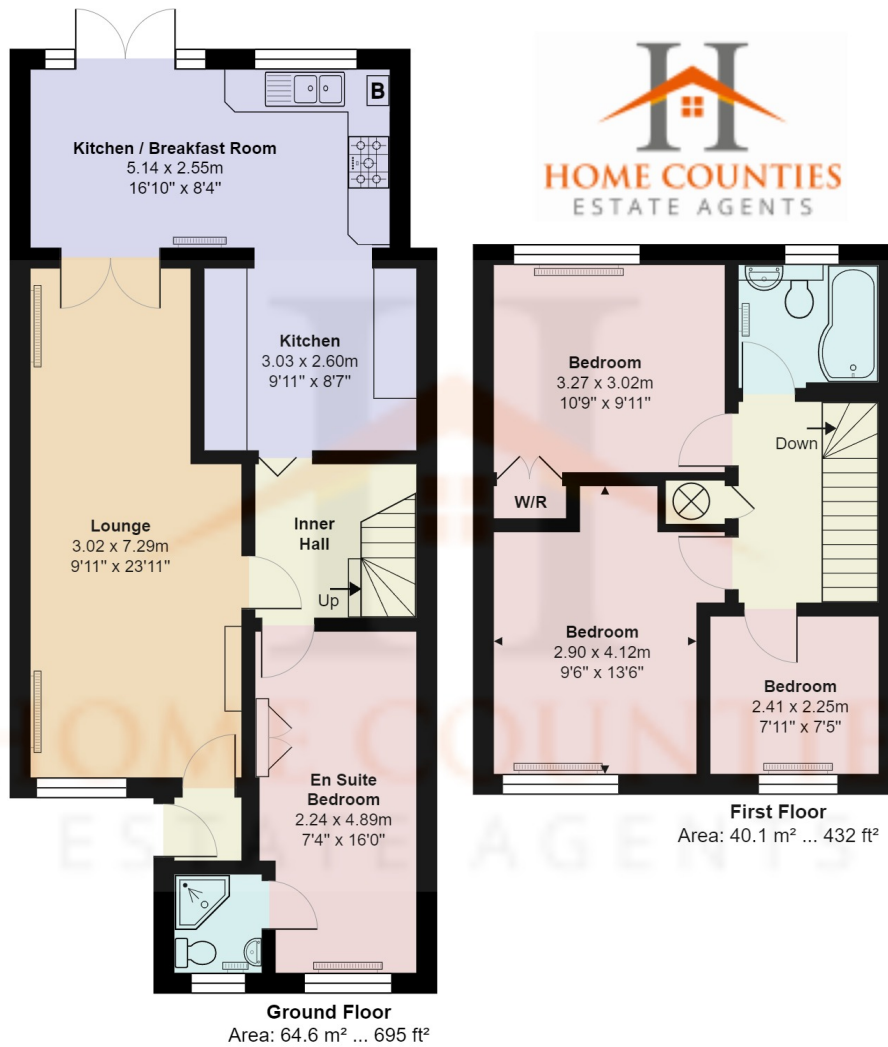

Oulton Crescent, Hertfordshire EN6

Total Area: 104.7 m² ... 1127 ft²

All measurements are approximate and for display purposes only

Energy Efficiency Rating		Current	Potential
Very energy efficient - lower running costs			
(92+)	A		
(81-91)	B		85
(69-80)	C		
(55-68)	D	62	
(39-54)	E		
(21-38)	F		
(1-20)	G		
Not energy efficient - higher running costs			
England, Scotland & Wales		EU Directive 2002/91/EC	

