

23 Firs Lane, Folkestone, Kent, CT19 4QF

Guide Price £285,000

EPC RATING: C

**Extended
Semi
Detached**

This well-appointed home features a rear kitchen extension and a driveway for two vehicles at the front. The delightful enclosed rear garden is beautifully landscaped with a lawn and patio area. The ground floor offers an entrance hall, a spacious living/dining room, and a modern kitchen with French doors opening to the garden. Upstairs, the first floor comprises a landing, two bedrooms with built-in wardrobes, and a bathroom. The property benefits from gas central heating and is situated in a popular residential location. EPC RATING = C



Situation

The property is located on 'Firs Lane' close to Cheriton High Street which offers an array of useful shops and places to eat. Local amenities include; large supermarkets, independent shops, library, Morehall Primary, secondary schools including The Academy and Harvey Grammar School. There is also a good amount of leisure facilities. The mainline railway station near by has a high speed service to London. This property is also within easy reach of the M20 motorway and Channel Tunnel. Approximately 1.5 miles to the East is the ever popular Port town of Folkestone which is the home of 'The Creative Quarter' boasting a thriving collection of Artist's studios and creative businesses, as well as a wide range of amenities such as Shopping centre, Supermarkets, independent shops, restaurants and leisure facilities, Folkestone benefits from the recently restored Harbour Arm which has become an increasingly popular food, drink and entertainment destination for the town and its visitors. Ashford International and Eurostar (approximately 14.5 miles) with services to Paris and Brussels.

The accommodation comprises

Ground floor

Entrance hall

Living/dining room

Living area

12' 4" x 9' 0" (3.76m x 2.74m)

Dining area

13' 5" x 11' 1" (4.09m x 3.38m)

Kitchen

12' 6" x 8' 1" (3.81m x 2.46m)

First floor

Landing

Bedroom one

13' 4" x 9' 4" (4.06m x 2.84m)

Bedroom two

9' 3" x 6' 10" (2.82m x 2.08m)

Bathroom

Outside

Front garden

Driveway for two vehicles

Rear garden

Heating

Gas

Council Tax Band

Folkestone & Hythe - Band C

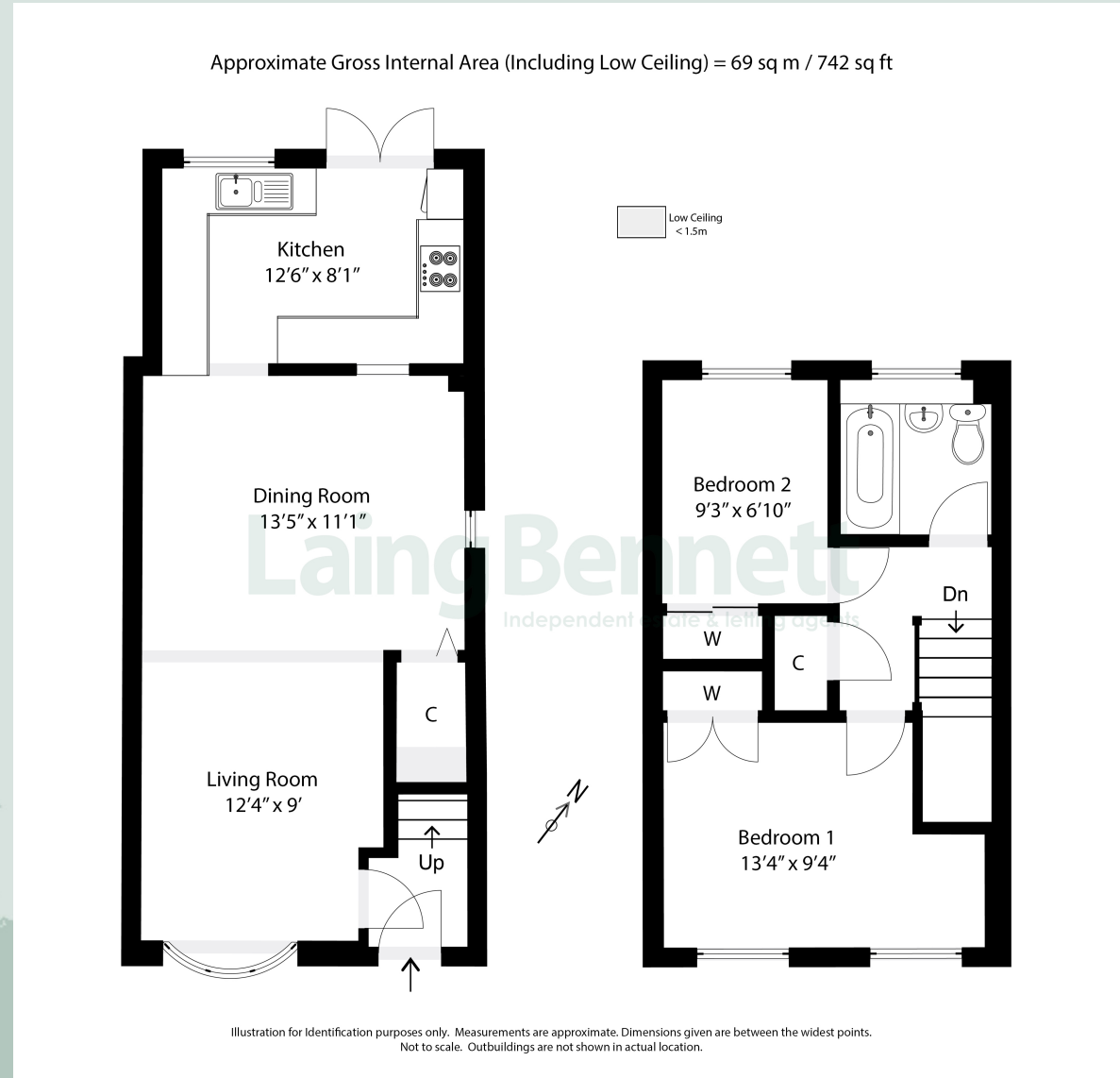



Need to Book a Viewing?

If you would like to view this property please contact our Lyminge branch on 01303 863393 or lyminge@laingbennett.co.uk

Directions

For directions to this property please contact us

Lyminge

01303 863393

lyminge@laingbennett.co.uk

The Estate Office | 8 Station Road | Lyminge | Folkestone | CT18 8HP

www.laingbennett.co.uk



These property details are intended to give a fair description and give guidance to prospective Purchaser/Tenant. They do not constitute an offer or contract of Sale/Tenancy and all measurements are approximate. While every care has been taken in the preparation of these details neither Laing Bennett Ltd nor the Vendor/Landlord accept any liability for any statement contained herein. Laing Bennett Ltd has not tested any services, appliances, equipment or facilities, and nothing in these details should be deemed to be a statement that they are in good working order or that the property is in good structural condition or otherwise. We advise all applicants to commission the appropriate investigations before Exchange of Contracts/entering into a Tenancy Agreement. It should not be assumed that any contents/furnishing, furniture etc. photographed are included in the Sale/Tenancy, nor that the property remains as displayed in the photographs. No person in the employment of Laing Bennett Ltd has authority to make or give any representation or warranty whatever in relation to this property.