



**Day & Co**  
ESTATE AGENTS

**28 Cavendish Street**  
**Keighley**  
**BD21 3RG**



**12 Clayton Terrace,**  
**Cullingworth, Bradford, West**  
**Yorkshire, BD13 5DR**

**£195,000**

**T: 01535 664609**

**W: [www.dayandcoestateagents.co.uk](http://www.dayandcoestateagents.co.uk)**

**E: [keighley@dayandcoestateagents.co.uk](mailto:keighley@dayandcoestateagents.co.uk)**



- WELL PRESENTED TERRACE
  - MODERN KITCHEN DINER
  - PARKING, ENCLOSED PATIO YARD
- TWO DOUBLE BEDROOMS
  - FOUR PIECE BATHROOM
  - EPC RATING C

SUMMARY

\*\* WELL PRESENTED TERRACE, MODERN KITCHEN DINER, FOUR PIECE MODERN BATHROOM, TWO DOUBLE BEDROOMS, DESIREABLE VILLAGE LOCATION, STREET PARKING, NO ONWARD CHAIN, EPC RATING C \*\*

FULL DESCRIPTION

A well presented, character terrace with stylish decor and modern fittings. Offering two double bedrooms a desirable location and no-onward chain, an early viewing is strongly encouraged to avoid any disappointment. This property is situated in the desirable village of Cullingworth, has parking, a delightful private patio yard, no-onward chain, an early viewing is strongly recommended to fully appreciate this delightful home. In brief the accommodation briefly comprises-

Ground Floor - Spacious living room with multi fuel stove fire. Well appointed kitchen diner which boasts stylish wall and base units, complementary worksurfaces, breakfast island with seating for four, double oven, hob, fridge freezer, dishwasher, plumb for washing machine, under floor heating, useful utility cupboard.

First Floor - Landing with study area, two double bedrooms which both offer fitted wardrobes. There is a contemporary house bathroom featuring bath, shower, vanity wash hand basin, w.c.

Gas central heating and double glazing.

Externally the property has a frontage garden along with a lovely enclosed patio yard to the rear which makes for a wonderful relaxation and entertaining space. Parking.

EPC Rating C

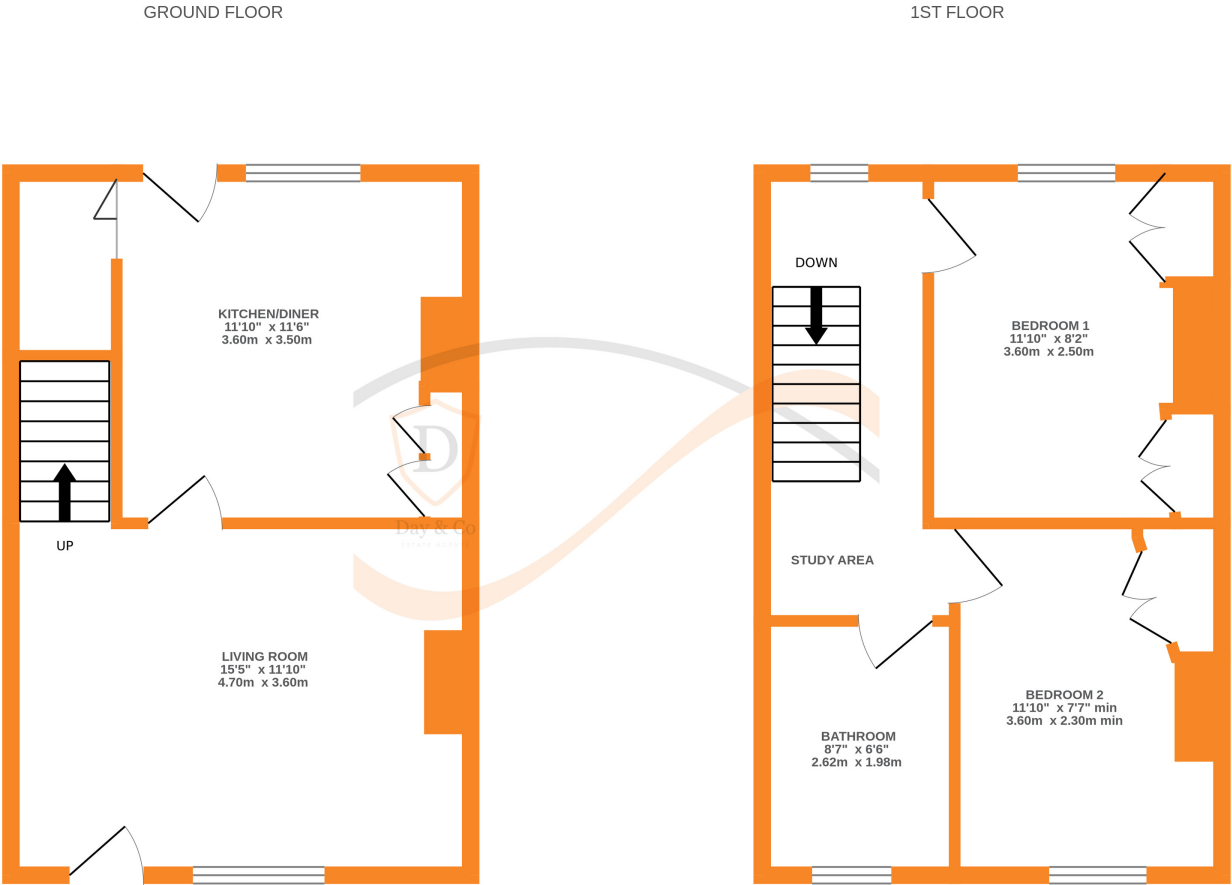

Whilst every attempt has been made to ensure the accuracy of the floorplan contained here, measurements of doors, windows, rooms and any other items are approximate and no responsibility is taken for any error, omission or mis-statement. This plan is for illustrative purposes only and should be used as such by any prospective purchaser. The services, systems and appliances shown have not been tested and no guarantee as to their operability or efficiency can be given.  
Made with Metropix ©2025