



Three Bedroom Semi-Detached House
Shanklin Close, Princes Park, Chatham, Kent, ME5 7QL

Offers Over £310,000
Freehold

Shanklin Close, Princes Park, Chatham, Kent, ME5 7QL

Offers Over £310,000

Freehold

Description

This extended house is situated in a popular cul de sac location. Well presented throughout, the property would make an ideal first time purchase or great family home. Accommodation comprises: entrance porch, lounge with staircase to first floor. To the rear is an extended kitchen/dining room with door to the downstairs cloakroom and door the utility area.

Upstairs are three bedrooms and a bathroom. Externally, the rear garden has tiers with seating areas. Ample parking to the front with driveway for 2+ vehicles and a garage.

Key Features

- Three Bedrooms
- Extended
- Semi-Detached House
- Downstairs Cloakroom
- Utility Area
- Garage
- Driveway
- Garden approx 44" x 22'6"

Local Area

Walderslade is within reach of local primary and secondary schools, shopping parades, doctors surgery and dentist. Being close to Chatham and Maidstone town centres, Capstone Valley Ski and Snowboard Centre, Historic Rochester and Dockside centre plus Bluewater Shopping Centre being approximately 20 minutes away by car. The area offers good transport links to the A2/M2, M20 and M25 plus Ebbsfleet International.

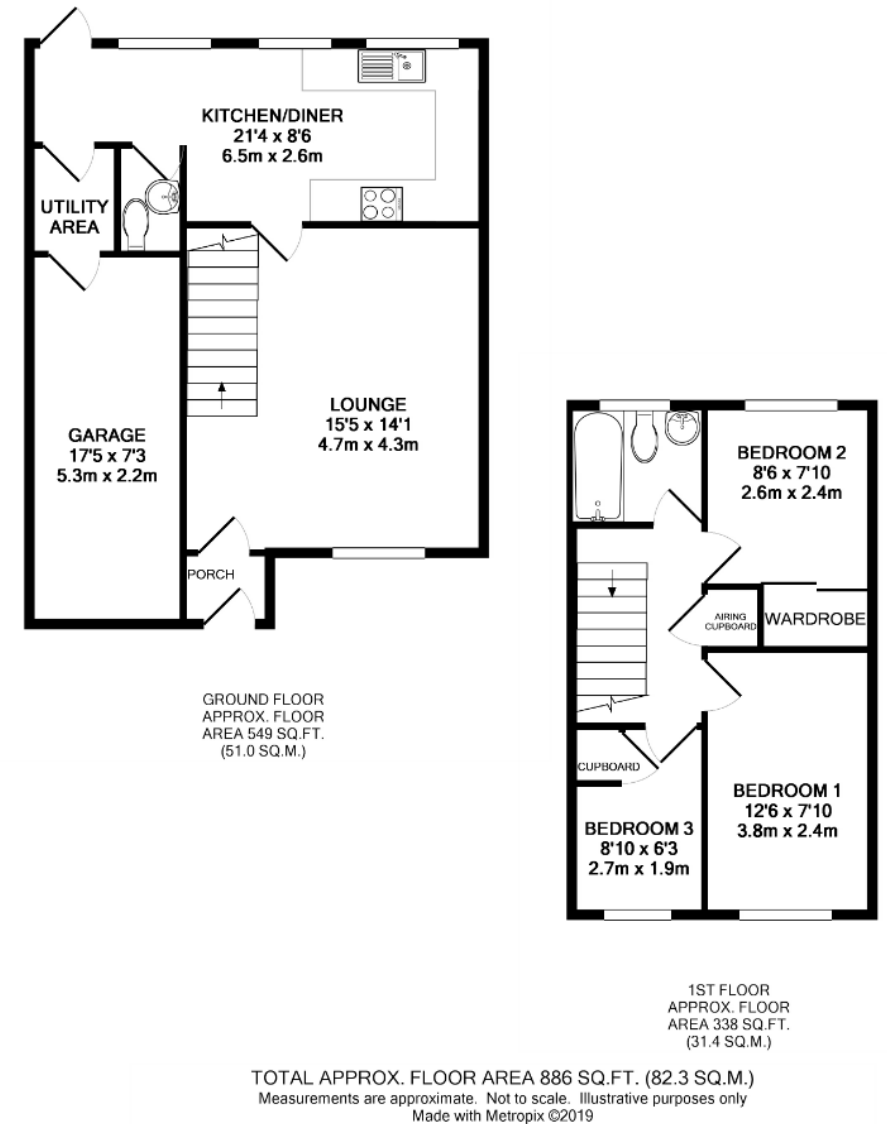



Property Location

Shanklin Close, Princes Park, Chatham, Kent, ME5 7QL

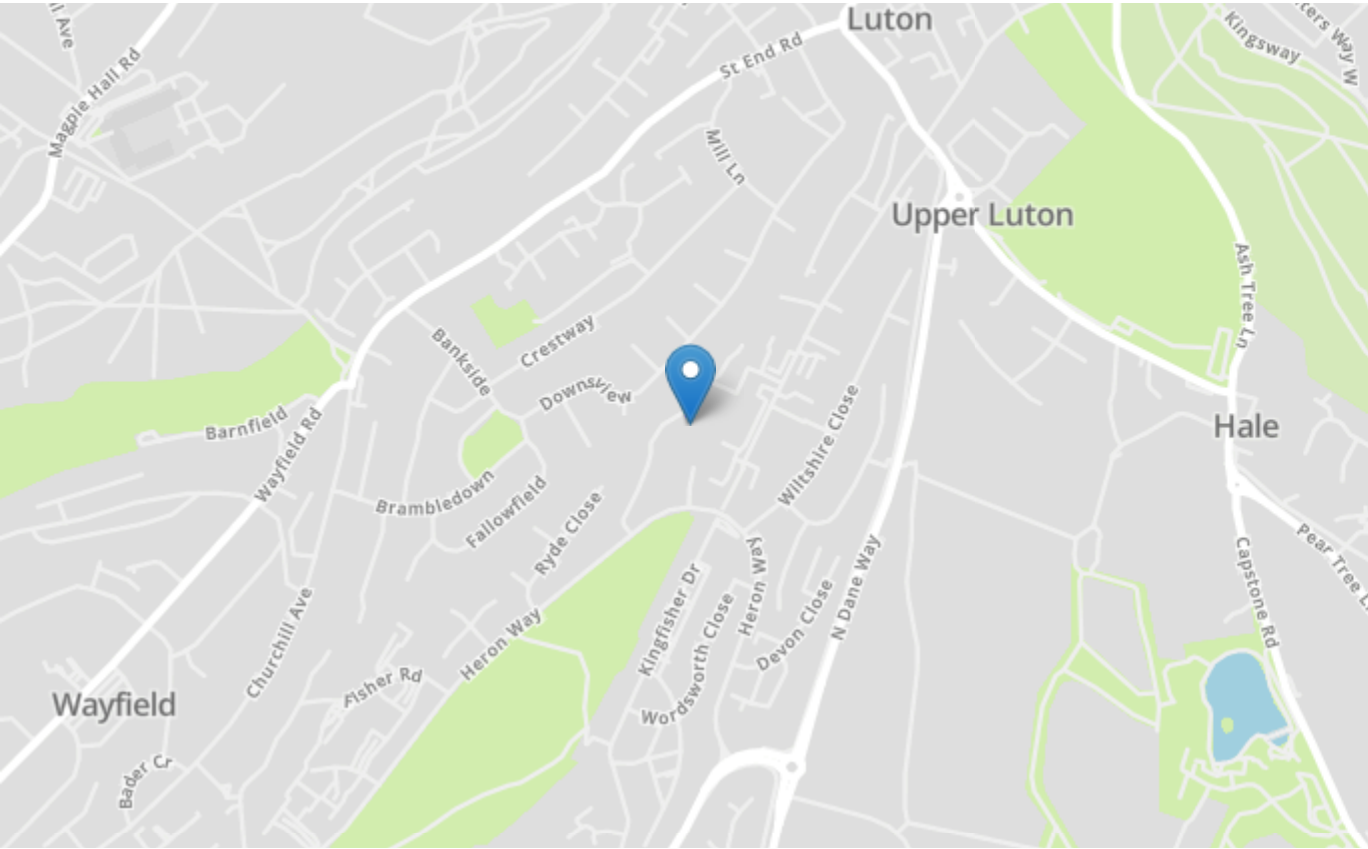

Energy Efficiency Rating		Current	Potential
Very energy efficient - lower running costs			
(92+)	A		
(81-91)	B		86
(69-80)	C	70	
(55-68)	D		
(39-54)	E		
(21-38)	F		
(1-20)	G		
Not energy efficient - higher running costs			
England, Scotland & Wales		EU Directive 2002/91/EC	

Tenure	Freehold
Lease Term	N/A
Ground Rent	N/A
Service Charge	N/A
Local Authority	Medway
Council Tax	Band C

Greyfox Walderslade

Unit 2, Thetford House
Walderslade Village Centre
Walderslade Road
Chatham
Kent
ME5 9LR
Tel: 01634 672227 Email:
walderslade@greyfox.co.uk

Greyfox Rainham

67C High Street
Rainham
Kent
ME8 7HS
Tel: 01634 377737 Email:
rainham@greyfox.co.uk

Agent Notes

These particulars are prepared as a general guide to a broad description of the property and should not be relied upon as a statement or representation of fact and do not constitute part of an offer or contract. The seller does not make or give nor do our employees or Greyfox have authority to make or give any representation or warranty to the property. We have not carried out a structural survey and the services, appliances and specific fittings have not been tested. All photographs, measurements, floorplans and distances referred to are given as a guide only and should not be relied upon for the purchase of carpets or any other fixtures or fittings. Lease details, service charges and ground rent (where applicable) and council tax are given as a guide only and should be checked and confirmed by you on inspection and your solicitor prior to exchange of contracts. If there are any points of particular importance to you we will be pleased to check the information for you and to confirm that the property remains available. This is particularly important should you be travelling some distance to view and where statements have been made by us to the effect that the information has not been verified. The copyright of all details, photographs and floorplans remain exclusive to Greyfox. For details of our privacy policy and referral fee arrangements with any of our selected partner companies please visit <https://www.greyfox.co.uk/legal/privacy> and <https://www.greyfox.co.uk/referral-fees>.