

SOLE  
AGENT

## Mayfield

Les Landes Clos | Landes Du Marche | Vale |

This detached bungalow sits central to a quiet clos which is conveniently located near shops, sits on a bus route and Saumarez Park is within comfortable walking distance. The property is has been upgraded and decorated throughout to a high standard including a new bathroom. Accommodation comprises lounge, kitchen/diner, two double bedrooms and a bathroom. To the rear of the property is a good-sized low-maintenance garden. In addition to the garage/workshop, the driveway provides parking for multiple vehicles. Regret no smokers or pets. Available immediately.

---

2 BEDROOMS

---

1 BATHROOM

---

1 RECEPTION

---

**£2,200 pcm**



PHOTOS





PHOTOS



# SPECIFICATIONS

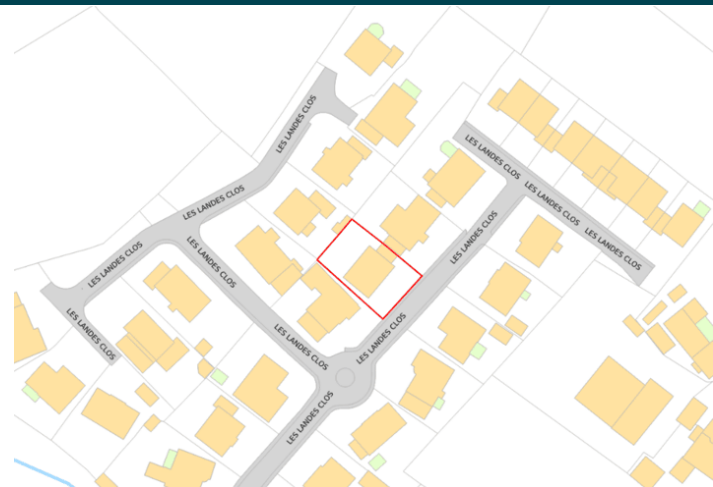

**Entrance Hall**

4.64m x 1.36m (15' 3" x 4' 6")

**Lounge**

3.95m x 4.24m (13' 0" x 13' 11")

**Kitchen/Diner**

4.07m x 3.65m (13' 4" x 12' 0")

**Rear Porch**

0.91m x 0.84m (3' 0" x 2' 9")

**Bedroom 1**

3.94m x 3.64m (12' 11" x 11' 11")

**Bedroom 2**

3.93m x 3.34m (12' 11" x 10' 11")

**Shower Room**

2.42m x 2.14m (7' 11" x 7' 0")

**Garage/Workshop**

4.91m x 2.76m (16' 1" x 9' 1")

**Garden**

To the rear of the property is a good-sized low-maintenance garden.

**Parking**

In addition to the garage/workshop, the driveway provides parking for at least two vehicles.

**PRICE INCLUDES**

Curtains, carpets and light fittings.

**SPECIAL FEATURES**

- uPVC double glazed
- Cavity construction
- Quiet Clos
- Light and spacious

**SERVICES**

Mains water, electricity and drainage. Oil fired central heating.

**APPLIANCES INCLUDED**

- Tricity Bendix four ring hob
- Creda plan double oven

**SCHOOL CATCHMENT**

Hautes Capelles Primary School and St Sampson High School



GROUND FLOOR

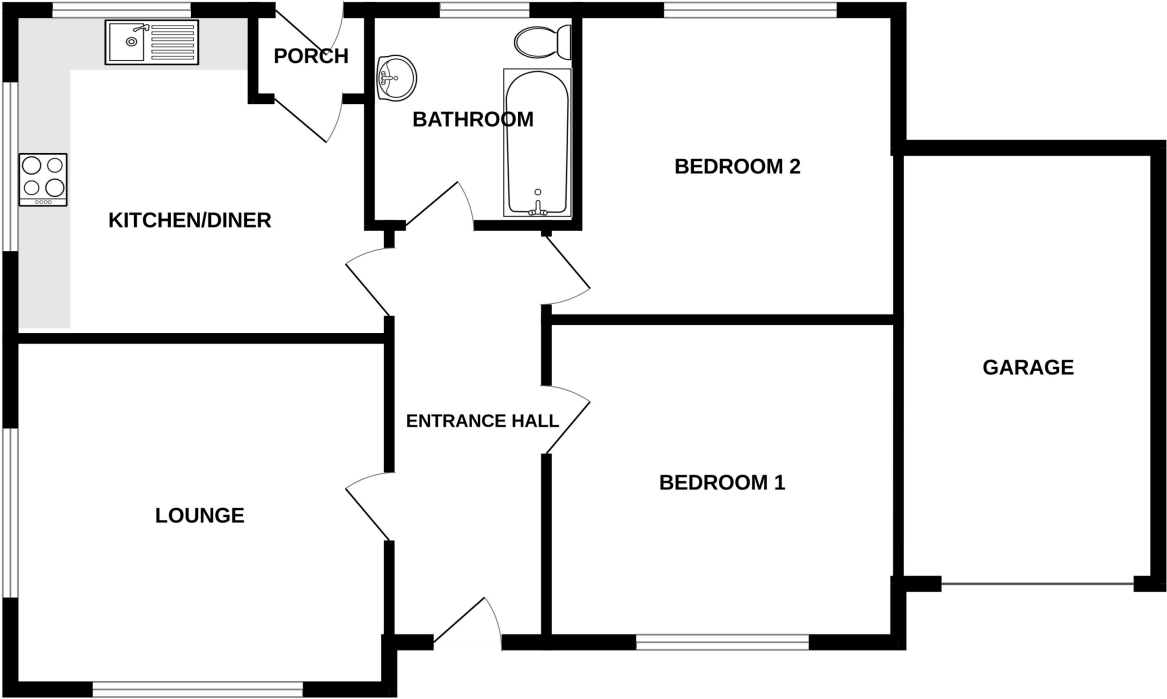

MAYFIELD

Whilst every attempt has been made to ensure the accuracy of the floorplan contained here, measurements of doors, windows, rooms and any other items are approximate and no responsibility is taken for any error, omission or mis-statement. This plan is for illustrative purposes only and should be used as such by any prospective purchaser. The services, systems and appliances shown have not been tested and no guarantee as to their operability or efficiency can be given.  
Made with Metropix ©2023