



**1 Vine Street  
Wallsend  
Tyne and Wear  
NE28 6JD**

**Offers in Excess of £63,000**

**bettermove**

# Vine Street Wallsend

Bettermove are proud to present this 3 bedroom first floor flat in Wallsend available with no forward chain.

The property benefits from double glazing and gas central heating throughout. The council tax band is A.

This property is currently tenanted - rental yields can be obtained through Bettermove.

This is a leasehold property with 109 years remaining on the lease; there is no ground rent and service charge.

The interior of this well presented property comprises a spacious living room, fitted kitchen, 3 bedrooms and the family bathroom with private access from the ground floor.

Located in the popular town of Wallsend, the property is close to a range of amenities, including shops, supermarkets, restaurants and pubs. Excellent transport connections can be found from the A19, Hadrian Road Metro and many local buses.

This exciting opportunity should not be missed! All enquiries can be made through Bettermove on 0330 004 0050.

You can secure the purchase today by paying an exclusivity fee of £1,000 which gives you the rights to purchase within a given timeframe.

Paying this fee ensures that the seller takes their property off the market and reserves it exclusively for you, therefore eliminating the risk of gazumping and aborted costs.

The exclusivity fee is returned to you upon successful completion of the property.



# First Floor

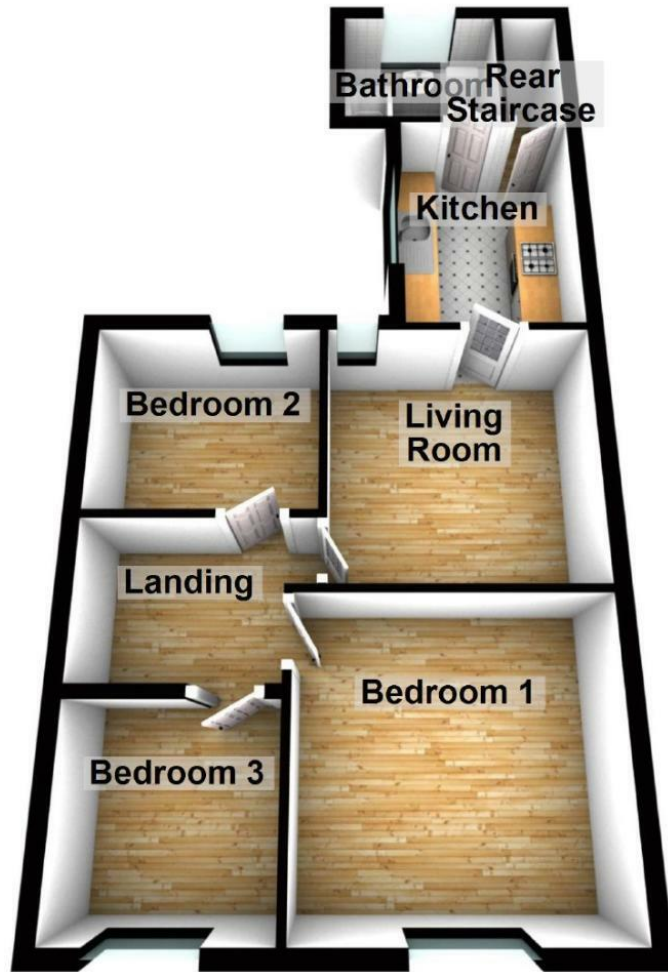



20-22 Bridge End, Leeds, LS1 4DJ  
t: 0330 004 0050 e: hello@bettermove.co.uk  
[www.bettermove.co.uk](http://www.bettermove.co.uk)