



- Four Bedroom House
- Semi Detached
- Outskirts Of Cressing
- Generous Rear Garden
- Ground Floor Cloakroom
- Complete Onward Chain
- Guide Price £380,000-£400,000
- Easy Access To A120 & A131
- Well Presented Throughout
- Garage With Power Connected
- Small Development

50 Stilemans Wood, Cressing, Braintree, Essex. CM77 8GR.

Michaels Property Consultants are delighted to present to the market this contemporary and deceptively spacious four bedroom semi detached house, occupying a fantastic position within this family orientated development. New to the market and offered for sale with a complete onward chain, this stylish family home is also conveniently positioned within easy reach of the A120, the mainline railway station, and the Braintree Designer village which also hosts an excellent array of restaurants.



Call to view 01376 337400



Property Details.

Ground Floor

Cloakroom

Kitchen/Diner



5.17m x 4.46m (17' 0" x 14' 8")

Living Room



5.18m x 4.22m (17' 0" x 13' 10")

First Floor

Bedroom One



3.58m MAX x 2.91m (11' 9" x 9' 7")

Property Details.

En Suite Shower Room



Bedroom Two



3.79m x 3m (12' 5" x 9' 10")

Bedroom Three



4.62m x 2.99m (15' 2" x 9' 10")

Bedroom Four

2.64m x 2.1m (8' 8" x 6' 11")

Family Bathroom



Outside

Rear Garden



Garage & Driveway

Property Details.

Floorplans

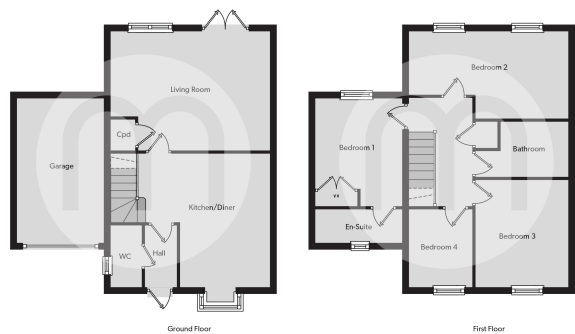

Location

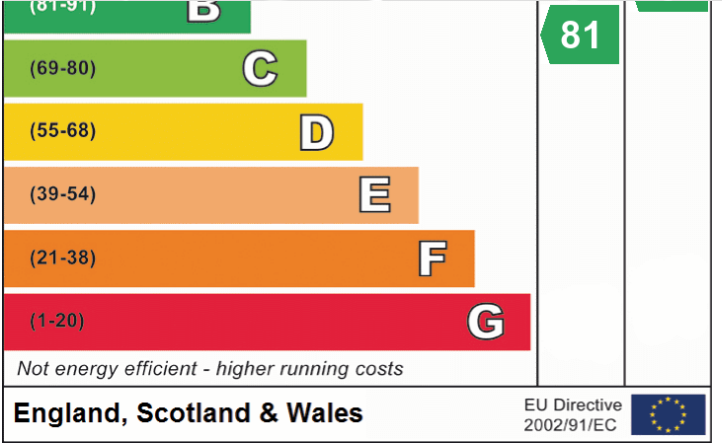
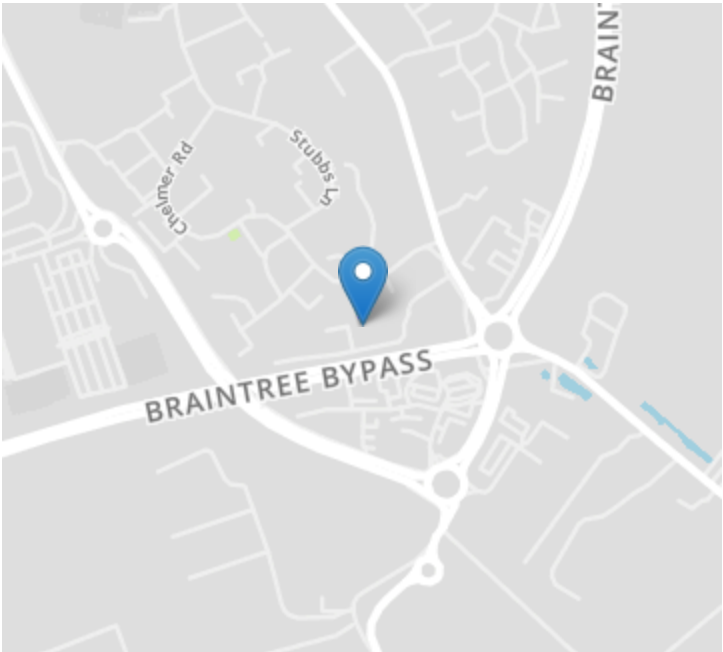

We have not carried out a structural survey and the services, appliances and specific fittings have not been tested. All photographs, measurements, floor plans and distances referred to are given as a guide only and should not be relied upon for the purchase of carpets or any other fixtures or fittings. Gardens, roof terraces, balconies and communal gardens as well as tenure and lease details cannot have their accuracy guaranteed for intending purchasers. Lease details, service ground rent (where applicable) are given as a guide only and should be checked and confirmed by your solicitor prior to exchange of contracts.