



Three Bedroom End of Terrace House
Clandon Road, Lordswood, Chatham, Kent, ME5 8UG

Guide Price £325,000
Freehold

Clandon Road, Lordswood, Chatham, Kent, ME5 8UG

Guide Price £325,000

Freehold

Description

Guide Price £325,000 - £340,000

Corner plot with potential to extend subject to relevant planning permissions. This lovely three bedroom end of terrace house is situated in the popular area of Lordswood and is beautifully presented throughout. Lordswood benefits from schools, leisure centre and convenient access to Chatham and M2/M20 links.

On entering the property you will get a feeling of light and space in the good sized lounge/dining room. The kitchen is adjacent to the lounge with an open plan feel, a great social area for friends and family to gather. Upstairs are three bedrooms and a bathroom. The external corner plot is laid to lawn to the side and gravel paved to the rear with access from the garden into the garage. Whether you are enjoying the large garden or looking into the future to extend, then this property ticks all the boxes.

Key Features

- Three Bedroom House
- Superb Corner Plot
- End of Terrace
- Potential to Extend STRPP
- Well Presented Throughout
- Lordswood Area
- Garage & Parking
- Garden to Rear & Side

Local Area

Lords Wood is a suburb of Chatham, located approximately 3 miles outside of Chatham Town Centre. With local amenities including local shops, schools and a sports leisure centre. With frequent bus services in to the main town centres and mainline railway stations. For those who need to commute, the property is close to Kings Ferry commuter coach pick up points and both the M2/M20 motorways servicing the coast and London.

GROUND FLOOR
540 sq.ft. (50.1 sq.m.) approx.

1ST FLOOR
382 sq.ft. (35.5 sq.m.) approx.

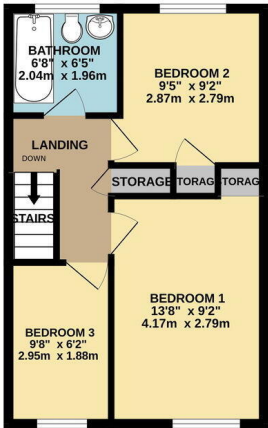
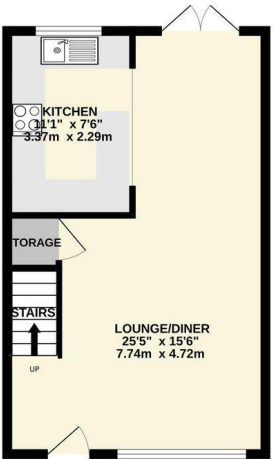
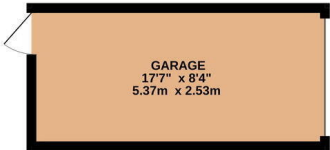

TOTAL FLOOR AREA: 922 sq.ft. (85.6 sq.m.) approx.

Whilst every attempt has been made to ensure the accuracy of the floorplan contained here, measurements of doors, windows, rooms and any other items are approximate and no responsibility is taken for any error, omission or mis-statement. This plan is for illustrative purposes only and should be used as such by any prospective purchaser. The services, systems and appliances shown have not been tested and no guarantee as to their operability or efficiency can be given.
Made with Metropix ©2025





Property Location

Clandon Road, Lordswood, Chatham, Kent, ME5 8UG

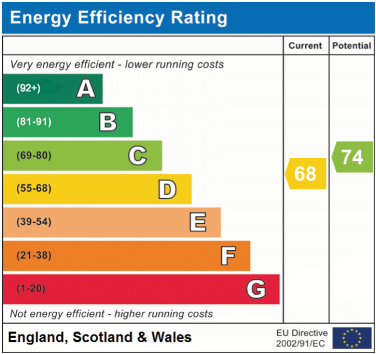
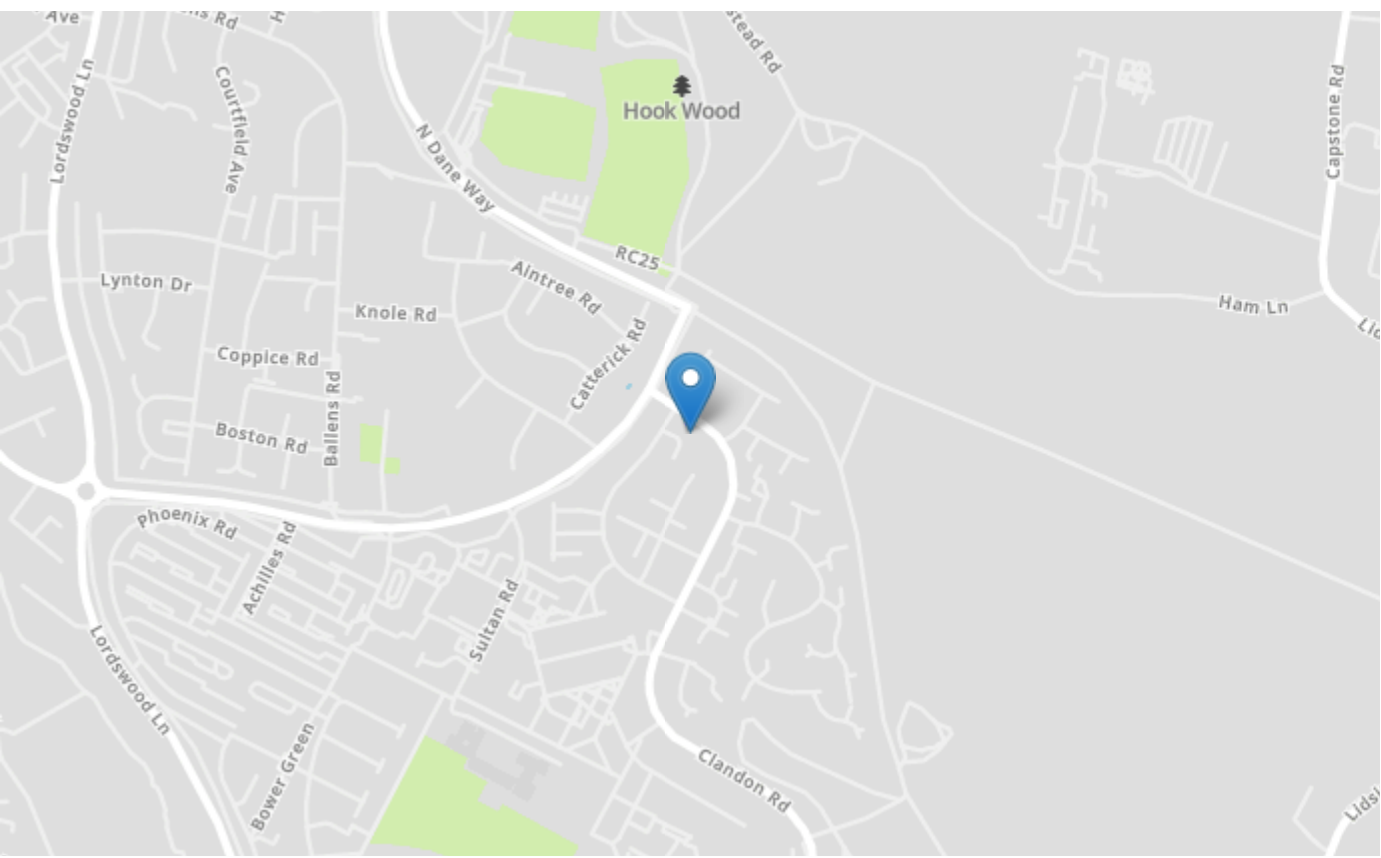

Tenure	Freehold
Lease Term	N/A
Ground Rent	N/A
Service Charge	N/A
Local Authority	Medway
Council Tax	Band C

Greyfox Walderslade

Unit 2, Thetford House
Walderslade Village Centre
Walderslade Road
Chatham
Kent
ME5 9LR
Tel: 01634 672227 Email:
walderslade@greyfox.co.uk

Greyfox Rainham

67C High Street
Rainham
Kent
ME8 7HS
Tel: 01634 377737 Email:
rainham@greyfox.co.uk

Agent Notes

These particulars are prepared as a general guide to a broad description of the property and should not be relied upon as a statement or representation of fact and do not constitute part of an offer or contract. The seller does not make or give nor do our employees or Greyfox have authority to make or give any representation or warranty to the property. We have not carried out a structural survey and the services, appliances and specific fittings have not been tested. All photographs, measurements, floorplans and distances referred to are given as a guide only and should not be relied upon for the purchase of carpets or any other fixtures or fittings. Lease details, service charges and ground rent (where applicable) and council tax are given as a guide only and should be checked and confirmed by you on inspection and your solicitor prior to exchange of contracts. If there are any points of particular importance to you we will be pleased to check the information for you and to confirm that the property remains available. This is particularly important should you be travelling some distance to view and where statements have been made by us to the effect that the information has not been verified. The copyright of all details, photographs and floorplans remain exclusive to Greyfox. For details of our privacy policy and referral fee arrangements with any of our selected partner companies please visit <https://www.greyfox.co.uk/legal/privacy> and <https://www.greyfox.co.uk/referral-fees>.