



Knutton Lane,
Newcastle-under-Lyme



OneAgency

01782 970222

hello@oneagencygroup.co.uk



Offers in Region of £89,950

A three bedroom mid town house with tenants currently in situ. Ideal for buy to let within close proximity to Newcastle under Lyme Town Centre. We understand the current tenant is paying £480 per calendar month and the property will be sold with the tenants in situ.





Ground Floor

Hall

Entered through a UPVC front door, radiator and carpet flooring.

Lounge

3.92m x 3.39m (12' 10" x 11' 1") A double glazed window to the front elevation, storage cupboard, radiator and carpet flooring.

Kitchen/Diner

4.40m x 2.94m (14' 5" x 9' 8") A range of wall and base units with worktops, oven with electric hob and hood over, plumbing for a washing machine, space for a fridge/freezer, tiled splashbacks, storage cupboard, double glazed window, access to rear lobby with back door to the garden and tiled flooring.

Guest W/C

A useful ground floor w/c, window and tiled flooring.

First Floor

Bedroom One

3.40m x 2.87m (11' 2" x 9' 5") A double glazed window to the rear, radiator and carpet flooring.

Bedroom Two

3.35m x 3.01m (11' 0" x 9' 11") A double glazed window to the front, radiator and carpet flooring.

Bedroom Three

A double glazed window to the rear, radiator and carpet flooring.

Shower Room

3.02m x 1.24m (9' 11" x 4' 1") A walk in shower unit, pedestal hand wash basin, w/c, towel radiator, window to the front, storage space and tiled flooring.

External

Front - Steps leading up to a paved path to access the property, front garden area.

Rear - A paved area for seating and lawned section.

GROUND FLOOR

1ST FLOOR

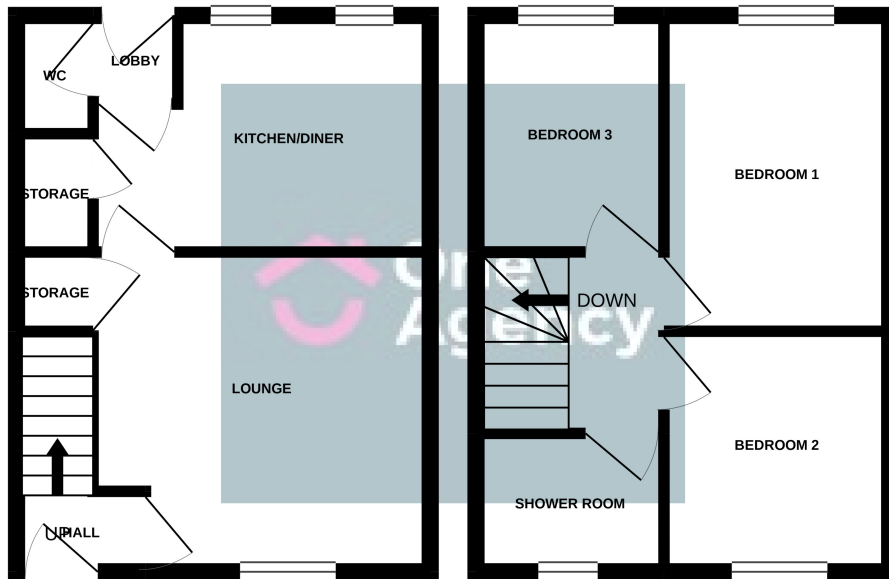

Whilst every attempt has been made to ensure the accuracy of the floorplan contained here, measurements of doors, windows, rooms and any other items are approximate and no responsibility is taken for any error, omission or mis-statement. This plan is for illustrative purposes only and should be used as such by any prospective purchaser. The services, systems and appliances shown have not been tested and no guarantee as to their operability or efficiency can be given.
Made with Metropix ©2021

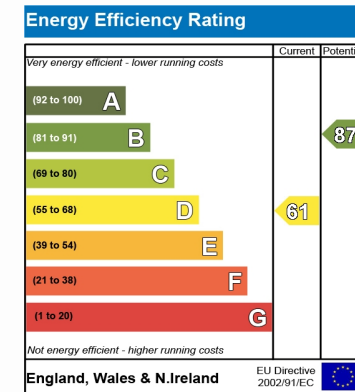

OneAgency, 9 & 10 Ridge House Drive, Festival Park, Stoke-on-Trent, ST1 5SJ

01782 970222

hello@oneagencygroup.co.uk

Every attempt has been made to ensure accuracy, however, all measurements are approximate and for illustrative purposes only. **Not to scale.**

In accordance with The Consumer Protection from Unfair Trading Regulations 2008 the following particulars have been prepared in good faith and they are not intended to constitute part of an offer or contract. We have not carried out a structural survey and the services, appliances and specific fittings have not been tested. All photographs, measurements, floor plans and distances referred to are given as a guide only and should not be relied upon for the purchase of carpets or any other fixtures and fittings. Lease details, service charges and ground rent (where applicable) are given as a guide only and should be checked and confirmed by your Solicitor prior to exchange of contracts.