

Jack Taggart & Co

RESIDENTIAL SALES

EATON GARDENS, BN3 3TN

GUIDE PRICE £400,000

EATON GARDENS, BN3 3TN

Jack Taggart & Co are delighted to offer the market this contemporary two bedroom apartment. This property is perfect for a first time buyer. This generous flat is situated in a popular area with lots of local shops and the beach nearby. The city centre shopping districts and parks are also within easy reach, and this apartment also offers easy access to Hove Station and the A23/A27 which have direct and fast links to the universities, airports and London. This property is a MUST SEE!!

The kitchen is the perfect mix of elegant and sleek. With spacious countertops, top of the range appliances and plenty of cupboard space. This is the perfect place for a foodie to unwind and cook up a feast. The kitchen benefits from a hatch through to the lounge so you can still have that open plan feel.

The lounge is the perfect space for entertaining, or having a quiet night in. The spacious layout allows room for a dining table and plenty of space for a snug area. The room benefits with access to the balcony, the modern door and double window complete the room with lots of natural light.

The master bedroom has a grand wall to wall built in wardrobe, with charming french doors leading to the picturesque west facing balcony. Also benefiting from a beautiful ensuite. comprising a modern walk in shower with elegant tiling and modern shower attachments, wash basin, WC and towel radiator. The second bedroom is a roomy double with soft carpet underfoot.

The main bathroom is the perfect place to relax with its deep seated bath, beautiful and modern tiling. Wash basin, WC and towel radiator.

With the property's separate storage and airing cupboards there is plenty of space to hide things away.

Hove mainline station provides convenient commuter links to London and Gatwick, and regular bus services travel all across the city and up to Devil's Dyke. Popular local schools include Hove Junior School, Brunswick Primary School and St Andrew's C of E Primary School

Eaton Gardens

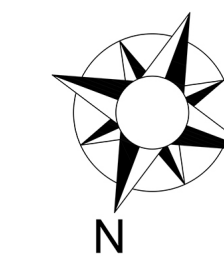
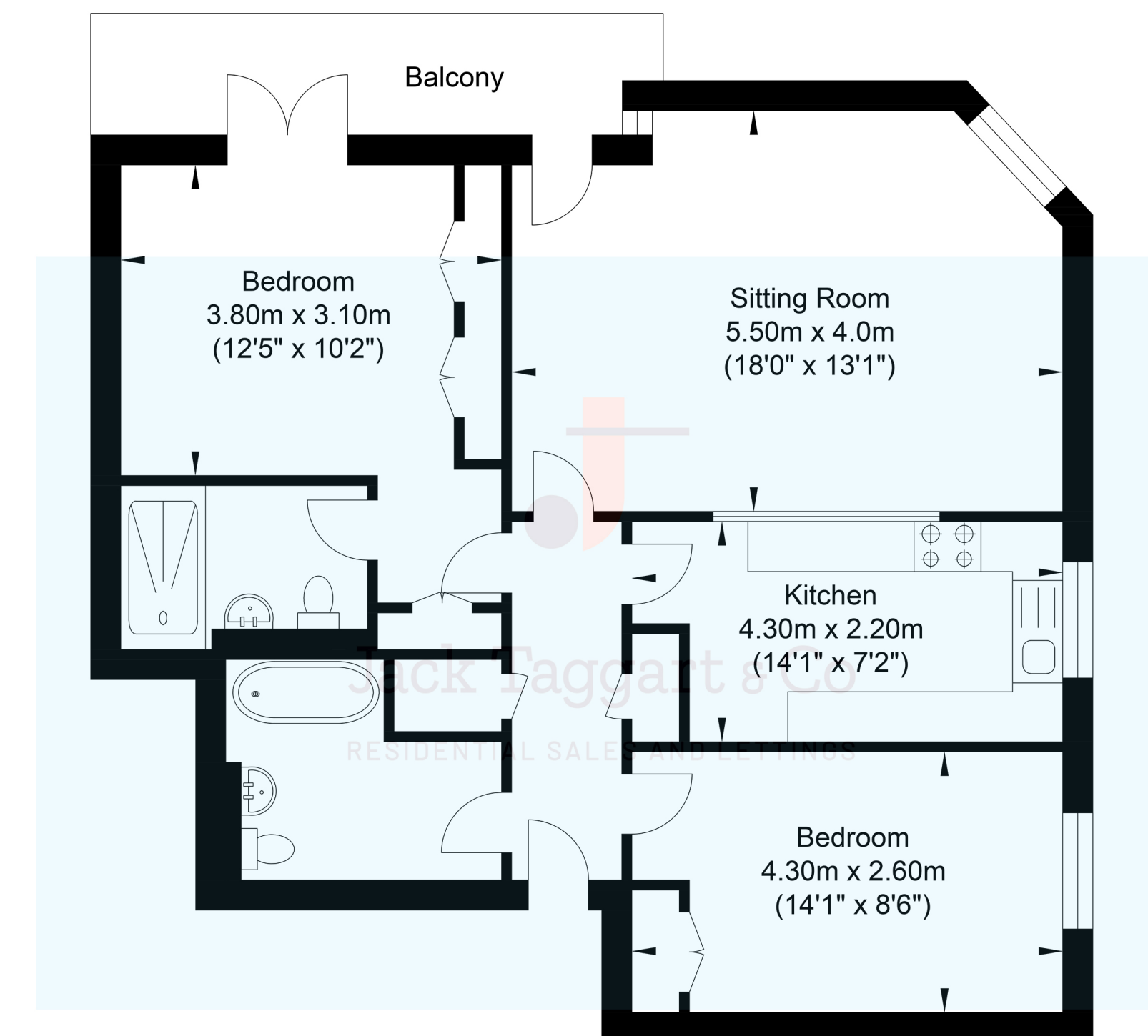

Ground Floor
Approximate Floor Area
774.46 sq ft
(71.95 sq m)

Approximate Gross Internal Area = 71.95 sq m / 774.46 sq ft
Illustration for identification purposes only, measurements are approximate, not to scale.



Jack Taggart & Co

RESIDENTIAL SALES