

Stanmore is a leafy, tranquil suburb in North-West London situated between Edgware and Bushey. The last stop on the Jubilee line, a journey to Bond Street from Stanmore takes 31 minutes. It is one of North West London's most desirable areas due to its boutique cafes, shopping facilities, and location to prominent state and private schools which include Haberdashers' Aske's, North London Collegiate, St. Margaret's, and Stanmore College.

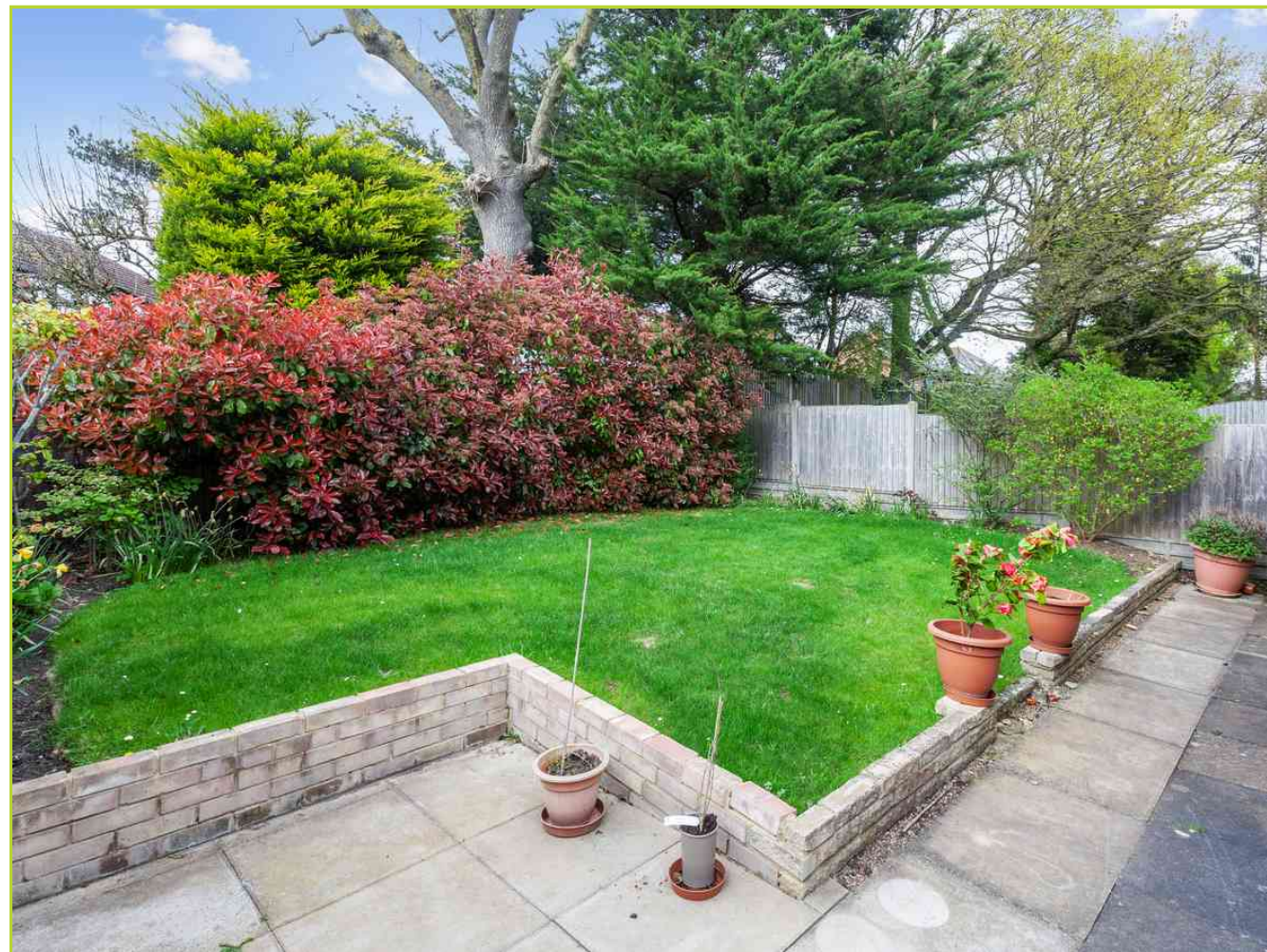
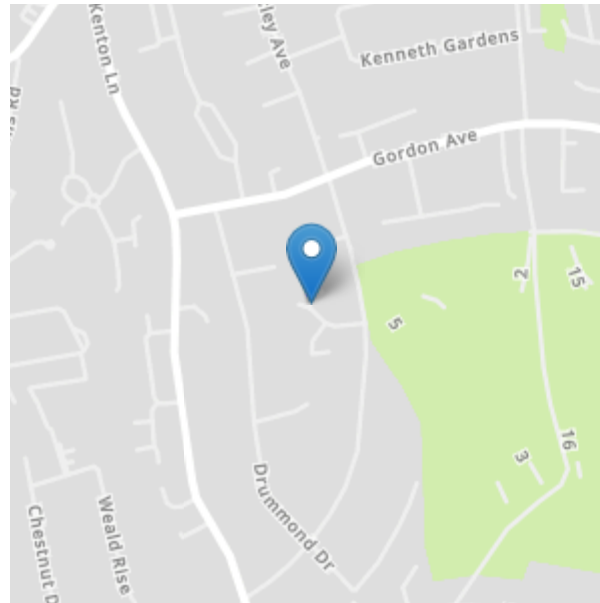

Daventer Drive, Stanmore, Middlesex. HA7 3TJ. £650,000 Freehold

A Well Presented 3 Bedroom Detached House extended across the rear of the property to create a delightful family home in a quiet cul de sac location. Other features include utility room, attached garage with off street parking, double glazed windows and recently installed bathroom. The property has been subject to recent improvements and we recommend internal viewing to be fully appreciated.

- Detached Property
 - Cul De Sac Location
 - Internal Viewing Highly Recommended
 - Attached Single Garage
 - Double Glazed Replacement Windows
- Extended To The Rear
 - Newly Installed Bathroom
 - Utility Room
 - Modern Fitted Kitchen/ Breakfast Room
 - Lounge & Dining Area

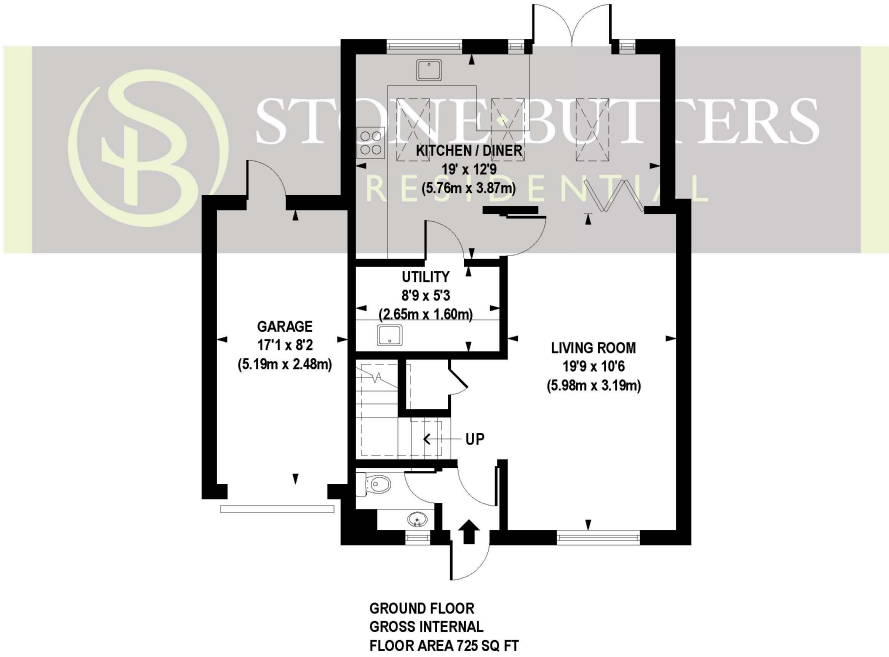
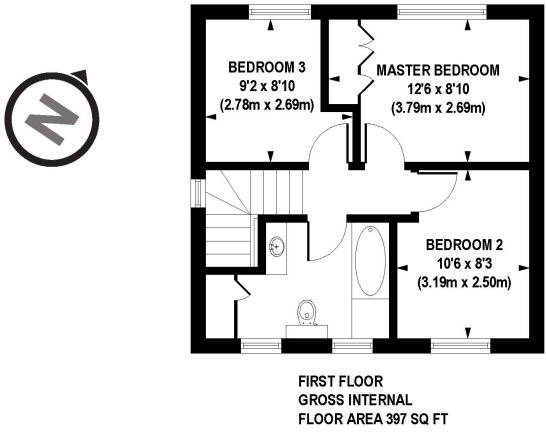

APPROX. GROSS INTERNAL FLOOR AREA 1121 sq. ft / 104.18 sq. m (Including Garage)
APPROX. GROSS INTERNAL FLOOR AREA 975 sq. ft / 90.55 sq. m (Excluding Garage)

Floorplan is for illustrative purposes only and is not to scale. Every attempt has been made to ensure the accuracy of the floorplan shown, however all measurements, fixtures, fittings and data shown are an approximate interpretation for illustrative purposes only. Liability for errors, omissions or mis-statement through negligence or otherwise is hereby excluded.

CPCREATIVE
PROPERTY MARKETING

(Floor plans are not to scale and measurements are given for guidance only)

