

FOR  
SALE



12 Upper Court, Eardisley, Hereford HR3 6PW

£450,000 - Freehold

22, Broad Street, Hereford, HR4 9AP 01432 355455 [hereford@flintandcook.co.uk](mailto:hereford@flintandcook.co.uk)



## PROPERTY SUMMARY

Situated in this popular village location, a 4-bedroom detached home offering ideal family accommodation and being sold with the added benefit of no onward chain. The property also benefits from wraparound gardens, 4 bedrooms, garage, driveway parking and we highly recommend an internal inspection.

Within Eardisley there is a primary school, village shop, church and tennis club.

## POINTS OF INTEREST

- *4 bedrooms (master with en-suite)*
- *Detached house*
- *Popular village location*
- *No onward chain*
- *Ideal family home*
- *Garage, garden and driveway parking*



## ROOM DESCRIPTIONS

### Reception hall

Wooden flooring, carpeted stairs leading up, useful understairs storage cupboard, radiator, fusebox, gas central heating thermostat, doors leading to

### Downstairs WC

Low flush WC, wash hand basin with tiled splashback, tiled floor, radiator, window, extractor, recessed spotlights.

### Dining room/snug

Carpet, radiator, window to front.

### Kitchen/breakfast room

Fitted with matching wall and base units with worksurfaces and tiled splashbacks, 1 1/2 bowl sink and drainer units, integrated appliances to include 5-ring gas hob with extractor over, electric double oven, microwave, fridge, freezer and dishwasher, breakfast bar, tiled floor, 2 windows, recessed spotlights, radiator, door to

### Utility room

Fitted base units with worksurfaces, integrated washing machine, Belfast sink with tiled splashback, tiled floor, extractor, window, recessed spotlights.

### Living room

Carpet, 2 radiators, window to front, French doors leading onto the rear patio area, coal-effect gas fireplace with feature surround.

### First floor landing

Carpet, loft hatch, smoke alarm, radiator, doors leading into

### Bedroom 1

Carpet, radiator, window to front, built-in double wardrobe with hanging rail and fitted shelf, built-in single wardrobe with fitted shelving, door to En-suite shower room with fitted shower cubicle with mains fitment shower over with tiled surround, low flush WC, wash hand basin with storage under, heated towel rail, tiled floor, recessed spotlights, window.

### Bedroom 2

Carpet, radiator, window to rear.

### Bedroom 3

Carpet, radiator, window to front, built-in double wardrobe with hanging rail and fitted shelf.

### Bedroom 4

Carpet, radiator, window.

### Bathroom

3 piece suite comprising P-shape panel bath, low flush WC and wash hand basin with storage under, tiled splashback, heated towel rail, tiled floor, extractor, window.

### Outside

The property is approached via a shared tarmac driveway leading to the paved driveway providing off-road parking for several vehicles, leading to the front door and opening garage doors. There is a paved path leading to the side access door and personnel door to the rear of the garage. The gardens are wraparound and mostly laid to lawn enclosed by hedging and fencing with a paved pathway leading round the entirety of the property with rear patio area and access gate leading down into the village.

### Services

Mains water, electricity and drainage are connected. Gas (LPG) central heating.

### Outgoings

Council tax band E, payable 2024/25 £2804.83. Water and drainage - metered supply.

### Agent's note

There is a management company for Upper Court and each property has a share of the ownership. There is a maintenance charge for the shared access road into the properties.

### Viewing

Strictly by appointment through the Agent, Flint & Cook, 01432 355455.

### Directions

Proceed west out of Hereford on Whitecross Road heading to Monument roundabout taking the 2nd exit onto Kings Acre Road. Continue along this road towards Brecon continuing straight into the village of Eardisley heading out the other side and then taking the right-hand turn just outside of the village for Upper Court. The property is then situated on the right-hand side as indicated by the Agent's FOR SALE board.

### Money laundering regulations

Prospective purchasers will be asked to provide address verification, identification and proof of funds at the time of making an offer.

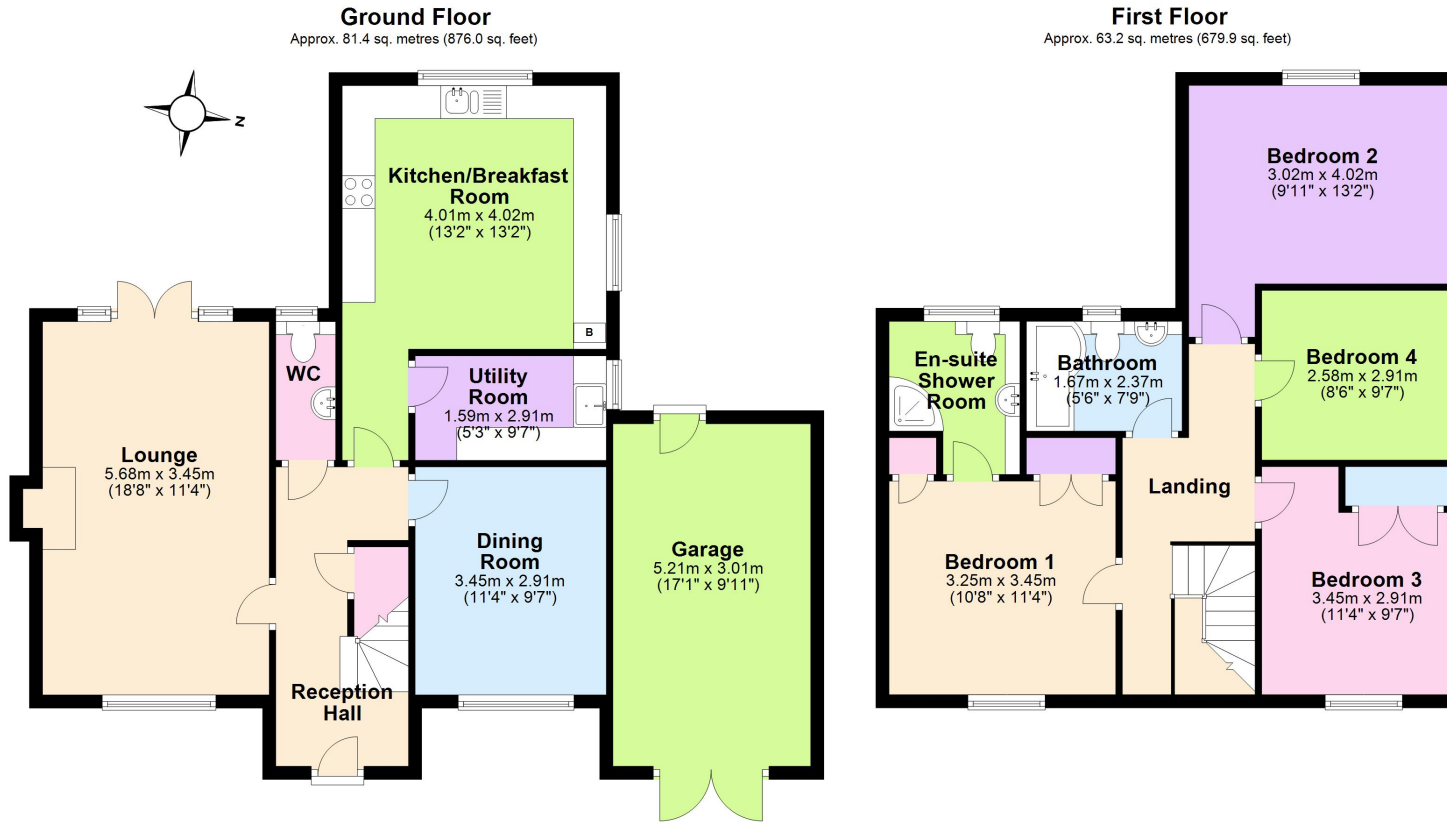

Total area: approx. 144.6 sq. metres (1555.9 sq. feet)

These plans are for identification and reference only.  
Plan produced using PlanUp.

**12 Upper Court, Eardisley, Hereford**

These particulars are prepared for the guidance only of prospective purchasers. They are intended to give a fair and overall description of the property and do not constitute the whole or any part of an offer or contract. Any information contained herein (whether in text, plans or photographs) is given in good faith but should not be relied upon as being a statement or representation of fact. Any plans provided by the agents and/or with the sales particulars are intended for guidance purposes only; we cannot guarantee the accuracy and scale of any plans, and they do not form any part of the sales contract. Nothing in these particulars shall be deemed to be a statement that the property is in good condition or otherwise nor that any services or facilities are in good working order. Any movable contents, fixtures and fittings, (whether wired or not) referred to in these property particulars (including any shown in the photographs) are, unless the particulars say otherwise, excluded from the sale. In the event that the buyer proposes to purchase any movable contents or include them in any offer for the property, the buyer cannot in any respect imply any such inclusion from the property particulars. Any areas, measurements or distances referred to herein are approximate only and may be subject to amendment. It should not be assumed that the property has all necessary planning, building regulation or other consents and these matters must be verified by an intending purchaser. The information in these particulars is given without responsibility on the part of the agents or their clients and neither the agents nor their employees have any authority to make or give any representations or warranties whatever in relation to this property.

**Flint & Cook Privacy Statement:** We take your privacy very seriously. Your data will not be shared with any other parties without your express permission. Our Data protection Policy can be read in full on the Flint & Cook website, [www.flintandcook.co.uk](http://www.flintandcook.co.uk)