



**DP** DERBYSHIRE  
PROPERTIES  
— SALES & LETTINGS —

**DP** DERBYSHIRE  
PROPERTIES  
SALES | LETTINGS | HOLIDAY LETS



The Common, Crich, Matlock, Derbyshire DE4 5BH  
£280,000 - Freehold



## PROPERTY DESCRIPTION

Derbyshire Properties are delighted to present this two double bedroom detached bungalow located in the picturesque village of Crich. The current owners have completely renovated and modernised the property throughout and the accommodation briefly comprises of:- entrance hall, living room, kitchen, shower room, two double bedrooms and an inner hallway. We believe the property would ideally suit first time buyers looking to take their first steps onto the property ladder and investors looking for a holiday let.

## POINTS OF INTEREST

- Detached Bungalow
- 2 Double Bedrooms
- Well Presented Throughout
- Beautiful Modern Shower Room
- Newly Fitted Kitchen
- Central Village Location
- On Street Parking
- Secluded Private Location
- Viewing An Absolute Must
- COUNCIL TAX BAND C

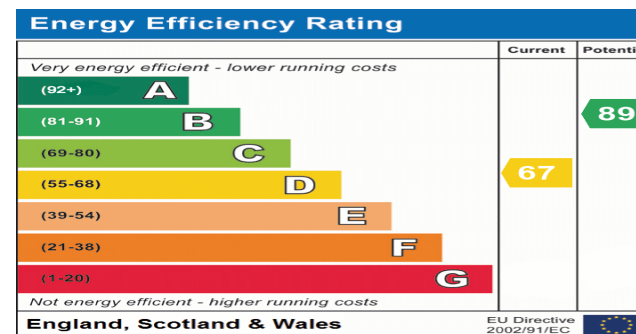

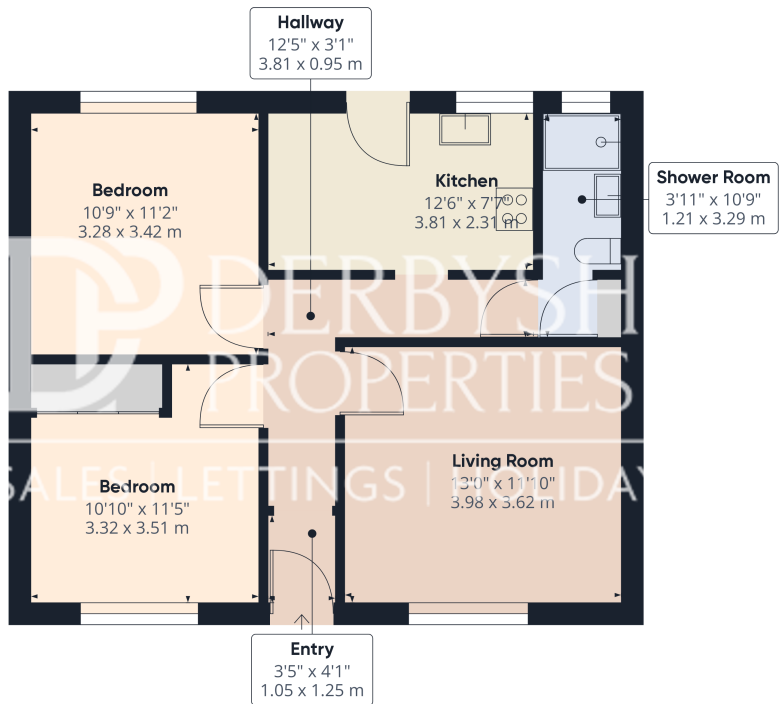

Ground Floor Building 1



Approximate total area<sup>(1)</sup>  
631.13 ft<sup>2</sup>  
58.63 m<sup>2</sup>

(1) Excluding balconies and terraces

While every attempt has been made to ensure accuracy, all measurements are approximate, not to scale. This floor plan is for illustrative purposes only.

GIRAFFE360

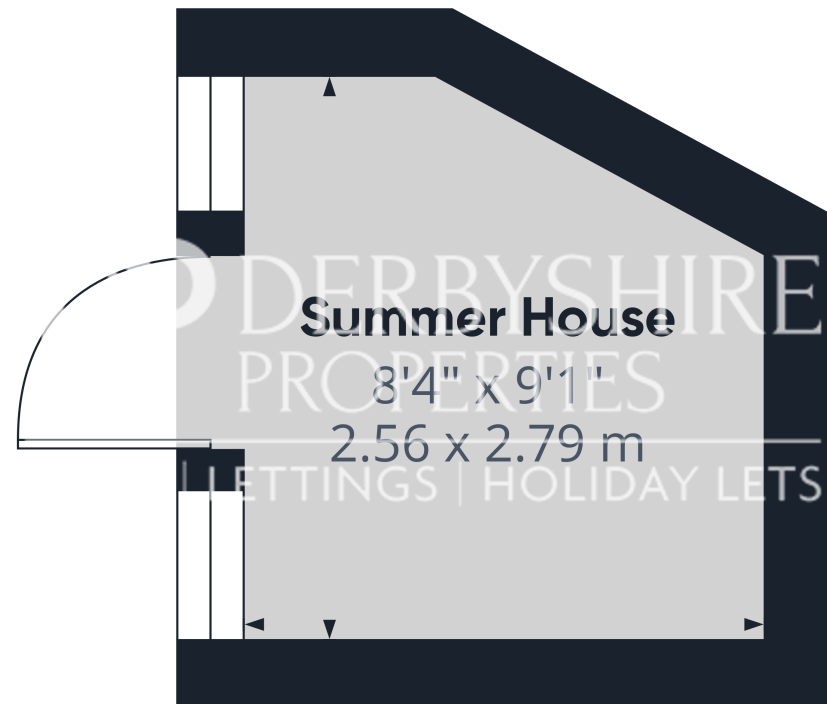

Ground Floor Building 2



Approximate total area<sup>(1)</sup>  
69.51 ft<sup>2</sup>  
6.46 m<sup>2</sup>

(1) Excluding balconies and terraces

While every attempt has been made to ensure accuracy, all measurements are approximate, not to scale. This floor plan is for illustrative purposes only.

GIRAFFE360