



HEARNES

WHERE SERVICE COUNTS

**6D Bridgewater Road, Parkstone,
Poole, BH12 2JL**

6D Bridgewater Road, Parkstone, Poole, Dorset, BH12 2JL

FREEHOLD PRICE £375,000

An attractive 3 bedroom, semi detached home, built in 2011 and set at the end of a cul de sac in Parkstone. This charming and stylish home has been updated by the current owners to include a new kitchen, bathroom, décor and flooring. The property is presented in 'show home' condition and has a generous sitting room with a feature square bay, kitchen/dining room, downstairs cloakroom, garage and off road parking for 2/3 cars.

- An attractive 3 bedroom semi detached home
- Quiet location, set at the end of a cul de sac
- Built in 2011 as a pair of semi detached homes
- Beautifully updated and in 'show home' condition
- Refitted kitchen/breakfast room, fitted in a range of white units with work tops over and fitted with integrated 4 ring gas hob, oven, extractor, dishwasher and space for fridge/freezer and washing machine
- Downstairs cloakroom
- Updated bathroom with feature window, bath with shower over, wc and wash hand basin fitted into a vanity unit
- Bedroom one with fitted wardrobes
- Gas central heating and double glazing
- Single garage with power and light, up and over door, overhead boarded storage and space for tumble dryer
- Enclosed and very private rear garden with patio, area of lawn and access door to the garage
- Driveway with parking for 2/3 cars

Set at the end of a cul de sac, off a well-regarded quiet crescent, the home is within half a mile to Waitrose and the shops on Ashley Road. Branksome Retail Park and Branksome Station is under a mile and Westbourne 2 miles. Bournemouth and Poole Town Centres are within 3 miles.

COUNCIL TAX BAND: B

EPC RATE: C

AGENTS NOTE: The heating system, mains and appliances have not been tested by Hearn's Estate Agents. Any areas, measurements or distances are approximate. The text, photographs and plans are for guidance only and are not necessarily comprehensive.





INCLUDING OUTBUILDING

TOTAL FLOOR AREA : 1154 sq.ft. (107.2 sq.m.) approx.

Whilst every attempt has been made to ensure the accuracy of the floorplan contained here, measurements of doors, windows, rooms and any other items are approximate and no responsibility is taken for any error, omission or mis-statement. This plan is for illustrative purposes only and should be used as such by any prospective purchaser. The services, systems and appliances shown have not been tested and no guarantee as to their operability or efficiency can be given.

Made with Metropix ©2025

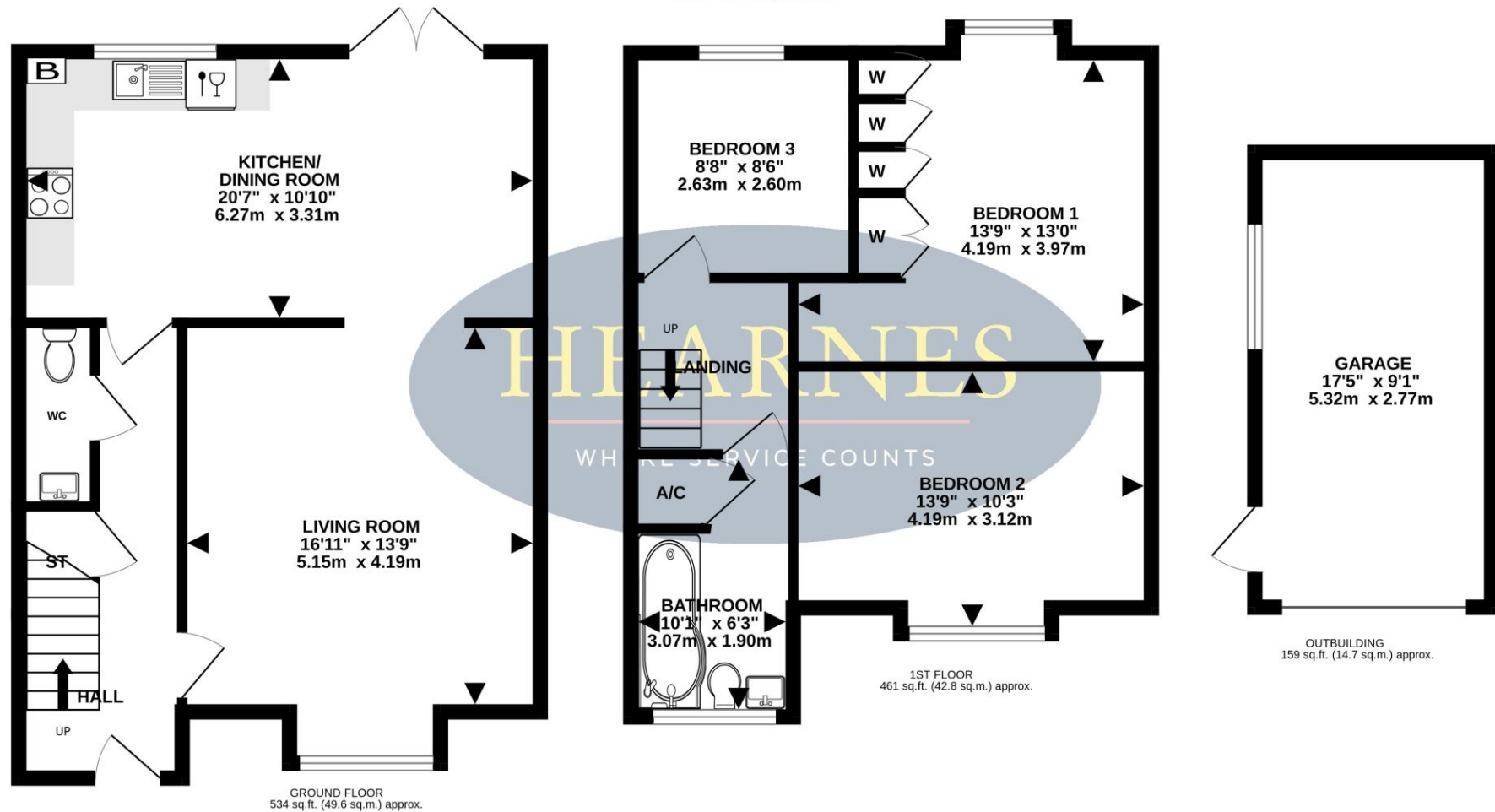





HEARNES

WHERE SERVICE COUNTS

www.hearnes.com

18 - 20 Parkstone Road, Poole, Dorset, BH15 2PG

Tel: 01202 377377 Email: poole@hearnes.com

Offices also at: BOURNEMOUTH, FERNDOWN, RINGWOOD & WIMBORNE