



Established Since 1910

0208 715 0555

*A Name Friends Recommend*



**Gilbey Road, Tooting, SW17 0QQ**

**£1,500 PCM**

**1 Bedroom Flat to Let**



[www.crossprior.co.uk](http://www.crossprior.co.uk)



## PROPERTY DETAILS

- First Floor Flat
- Excellent Location
- Spacious Living Room
- One Large Double Bedroom
- Fully Fitted Kitchen
- Gas Central Heating
- Morden Bathroom
- Double Glazing
- EPC Rating = C



 **St. Georges 1 Minute Walk**

 **Tooting Broadway 1 Minute Walk**

 **Tooting Gardens 3 Minute Walk**

 **Tooting Bec 18 Minute Walk**

 **Tooting 18 Minute Walk**

## FIRST FLOOR

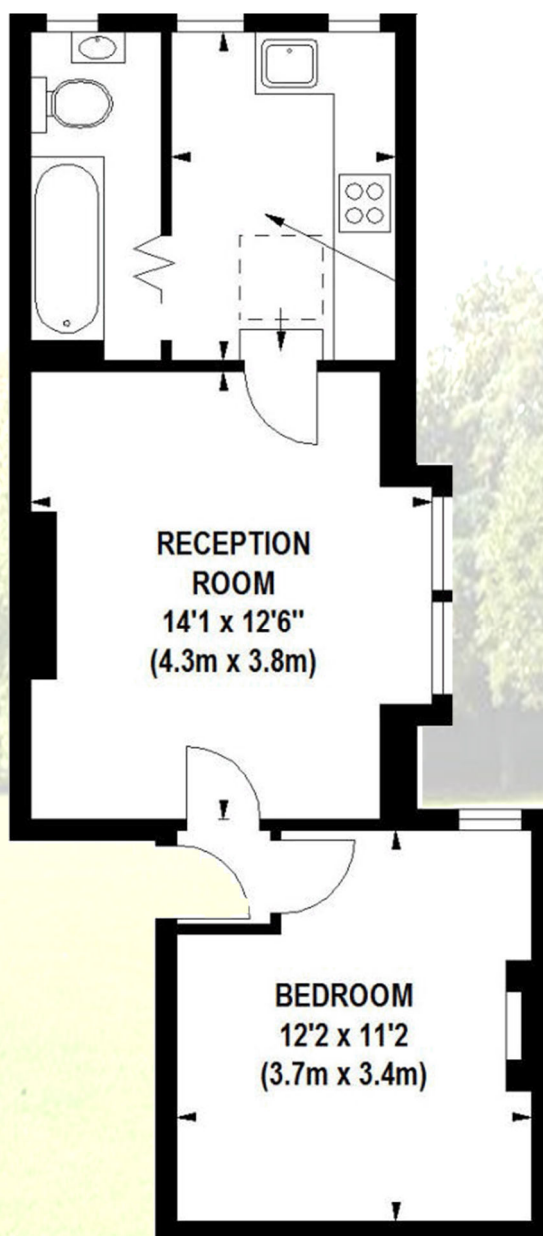

**TOTAL APPROX. FLOOR AREA:**  
**40SQ.M. / 431SQ.FT.**  
(Communal Entrance & Hallway Not Shown)

Cross & Prior endeavour to maintain accurate depictions of properties in Floor Plans and descriptions, however, these are intended only as a guide and purchasers must satisfy themselves by personal inspection.



*Established Since 1910*

### CONTACT

103 High Street, Colliers Wood,  
London SW19 2JF

[enquiries@crossprior.co.uk](mailto:enquiries@crossprior.co.uk)  
[www.crossprior.co.uk](http://www.crossprior.co.uk)

**0208 715 0555**

### VIEWING ARRANGEMENTS

Strictly by appointment with  
Cross & Prior

