

Cowper Road ,W7

Approximate Floor Area = 52.9 sq m / 569 sq ft

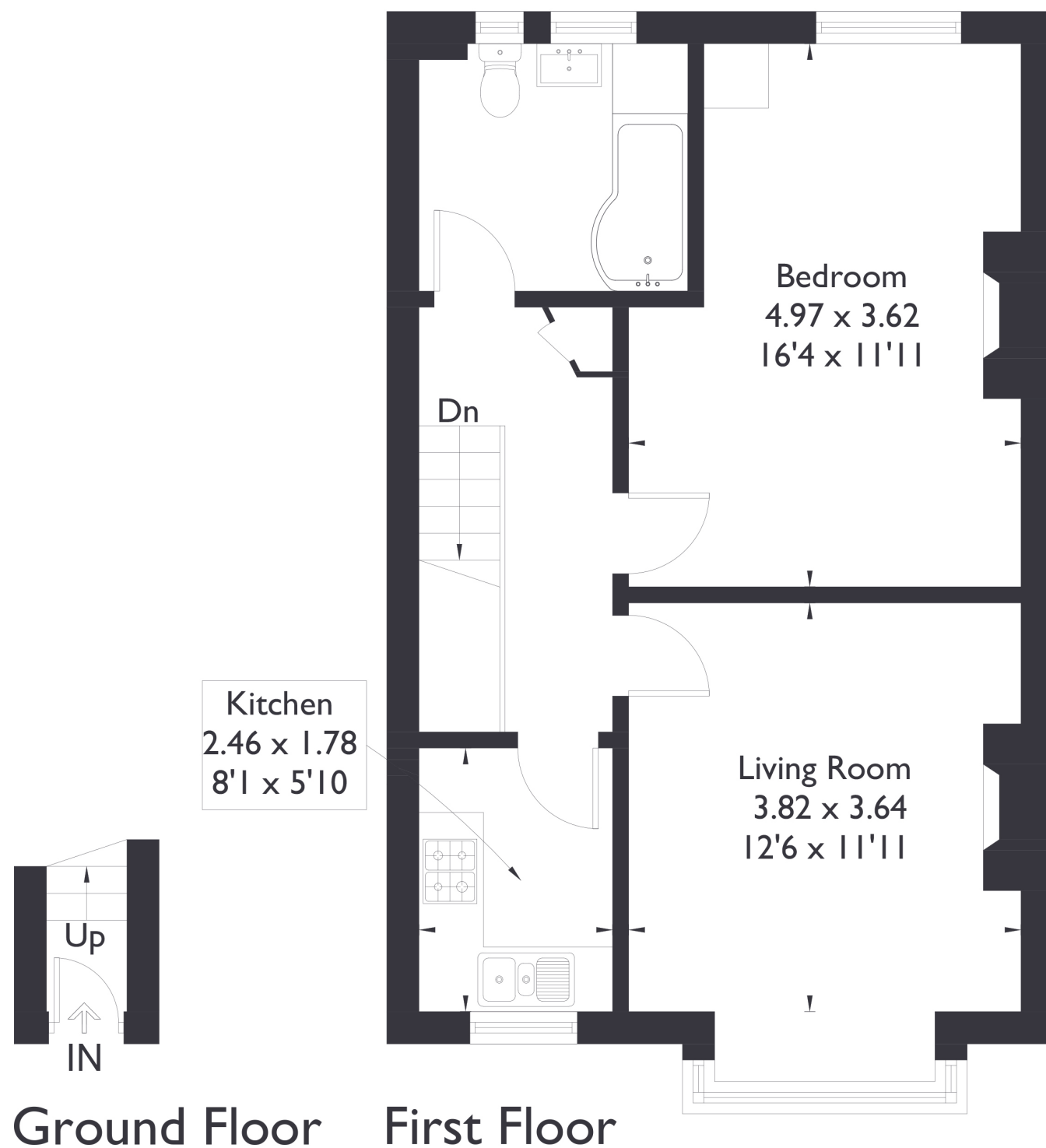

1 BEDROOM FLAT

Cowper Road, W7 £325,000

This delightful one bedroom flat is nestled on a sought after residential road in the Poets Corner area of Hanwell, offering both convenience and charm. Ideally situated within easy reach of Drayton Green and Hanwell Stations (Elizabeth Line), it provides excellent transport links for commuters.

FEATURES

- One Bedroom
- One Bathroom
- Period Features
- Hobayne And Drayton Manor Catchment
- Hanwell Station (Elizabeth Line)
- Greenford Avenue Amenities
- EPC Rating C.

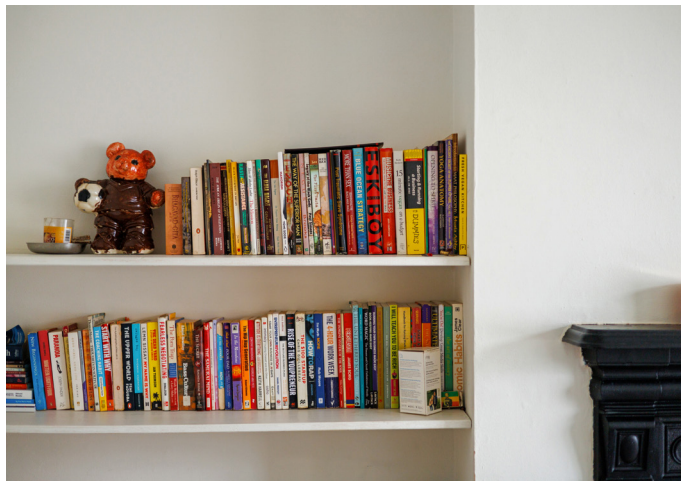

1 BEDROOM FLAT

Cowper Road, W7 £325,000

The property is also just a short distance from the vibrant shops, restaurants, and bus services along Greenford Avenue, ensuring everything you need is close at hand.

Additionally, it falls within the catchment area for Hobbayne Primary School and Drayton High School, making it a fantastic choice for families and professionals alike.

EPC Rating C.

