



Flat 4, 69 De la Warr Road, Bexhill On Sea East
Sussex, , TN40 2JE

£169,950



- Spacious first floor apartment
- Great size South facing Lounge-Diner
- Spacious Good Size Double Bedroom
- Fitted kitchen with ample space for appliances
- Lovely character period building
- Spacious Communal Inner Hall
- Secure Entryphone System
- Central heated & double glazed
- Excellent Scope & Additional Potential
- Communal Off Road Parking
- Sold with NO CHAIN !!
- Communal Garden With Woodland Area
- Call Bexhill 01424 224488 (Option 1)
- Viewing Highly Recommended.



FIRST FLOOR
662 sq.ft. (61.5 sq.m.) approx.

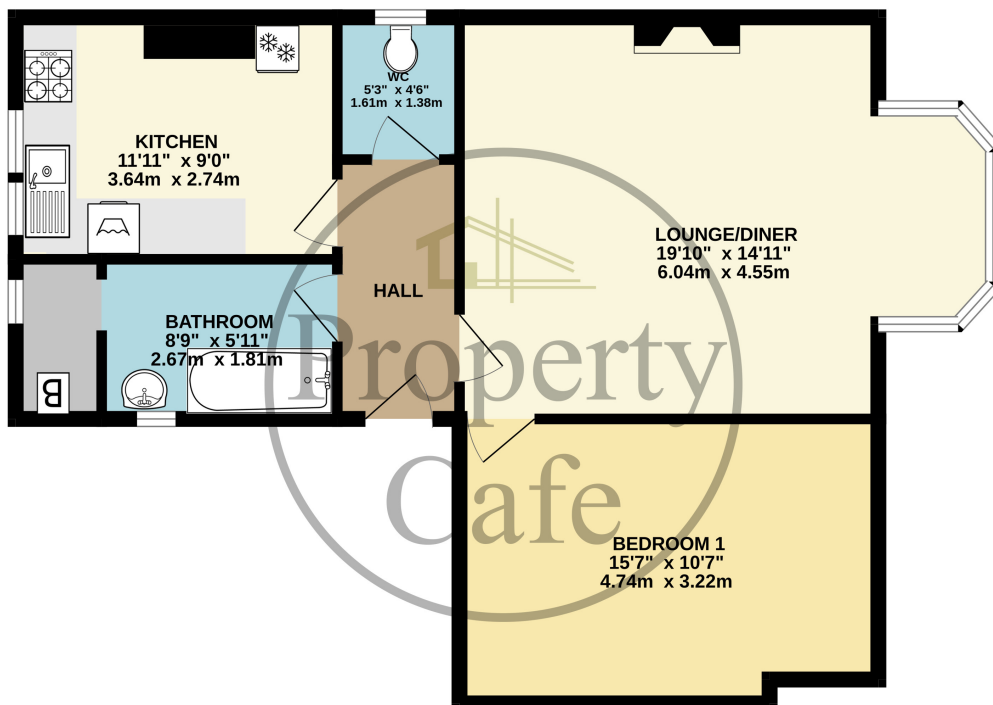

TOTAL FLOOR AREA : 662 sq.ft. (61.5 sq.m.) approx.
Whilst every attempt has been made to ensure the accuracy of the floorplan contained here, measurements of doors, windows, rooms and any other items are approximate and no responsibility is taken for any error, omission or mis-statement. This plan is for illustrative purposes only and should be used as such by any prospective purchaser. The services, systems and appliances shown have not been tested and no guarantee as to their operability or efficiency can be given.
Made with Metropix ©2024.

