

Bell Street, Great Baddow, Chelmsford, Essex, CM2 7JR



Energy Efficiency Rating D



£190,000

Bell Street, Great Baddow, Chelmsford, Essex, , CM2
7JR

ACCOMMODATION

This ground floor maisonette offers an entrance porch, lounge/diner, fitted kitchen with built in oven & hob, double bedroom with walk-in wardrobe and family bathroom with modern white suite. Outside the property also benefits from residents parking to the rear.

LOCATION

Great Baddow is a popular area with homebuyers and offers primary, secondary schools and local shops as well as regular bus services to the city centre. There is also Sandon Park & Ride station and Vineyards Shopping centre. Chelmsford City Centre boasts comprehensive shopping facilities and includes the highly acclaimed Bond Street shopping precinct as well as a wide array of independent and chain restaurants, many bars and leisure facilities including Riverside Ice Rink and leisure centre. Chelmsford railway station provides regular services to London Liverpool Street with journey times of around 40 minutes.

- Ground Floor Maisonette
- No Onward Chain
- Share of Freehold
- Lounge/Diner
- Fitted Kitchen

£190,000

GROUND FLOOR

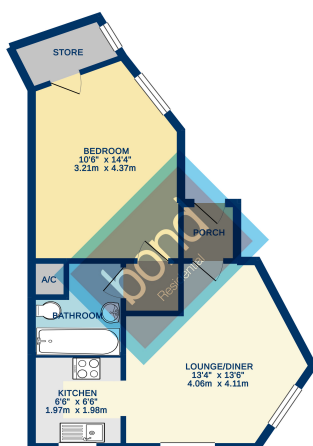

©2018 every effort has been made to ensure the accuracy of the floorplan, including floor composition of blocks, wall thickness, column and any other items on site. However, we do not accept any liability for any errors, omissions or misstatements. This plan is for information only and does not constitute an offer or a contract. The floor plan is subject to change without notice. Please contact the sales team for more information. The floor plan is subject to change without notice. Please contact the sales team for more information.



01245 500599
www.bondresidential.co.uk
43 New London Road, Chelmsford, CM2 0ND



Consumer Protection from Unfair Trading Regulations 2008 and the Business Protection from Misleading Marketing Regulations 2008.
Bond Residential have made every effort to ensure that consumers and/or businesses are treated fairly and provided with accurate material information as required by law. We have not tested any apparatus, equipment, fixture, fitting or any services and as such are unable to verify they are in working order, fit for their purpose, or within the ownership of the seller or landlord. Neither have we been able to check the legal documentation to verify the legal status of the property. We therefore advise potential buyers or tenants to verify these matters with their own solicitors or other advisers.