



Bromyard Avenue, London, W3 7BF

Cow & Co
LONDON

Bromyard Avenue | | W3 7BF

Guide price £275,000



GUIDE PRICE £275000 to £375000 A contemporary and spacious one bedroom apartment located within a desirable residential gated development with 24 hour concierge in West London. The apartment is bright and has modern décor, comprising of a double bedroom, a good sized bathroom and open plan kitchen/living room.

The development has excellent transport links to both the West End and London Heathrow. The nearest tube station is East Acton (Zone 2/ Central Line) and the Elizabeth Line is just a short bus ride away. There are a wide range of local amenities close by along Acton High Street, Askew Road as well as on Uxbridge road and at Westfield shopping centre. The green spaces of Acton Park are also close by.



- Spacious one double bedroom apartment
- Open plan kitchen living area
- Ground Floor
- Good proportions and good sized bedroom
- Secure entrance system
- Contemporary decor
- 24 Hour concierge service
- Easy access to Central Line tube and access to the A40

Bromyard Avenue, London, W3

Approximate Area = 465 sq ft / 43.1 sq m

For identification only - Not to scale

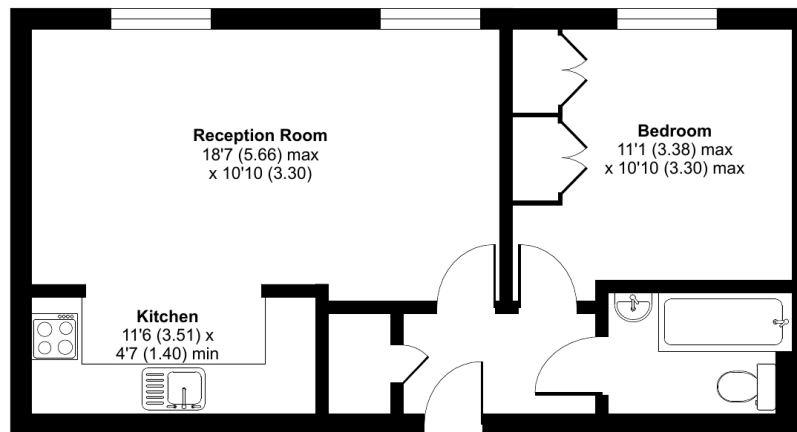

GROUND FLOOR



Floor plan produced in accordance with RICS Property Measurement Standards incorporating International Property Measurement Standards (IPMS2 Residential). © nchecon 2024. Produced for Cow & Co Properties Ltd. REF: 1071371

Tel: 0208 065 0010
Email: thehub@cowandco-london.com
Web: cowandco-london.com

Agents note: All measurements are approximate and whilst every attempt has been made to ensure accuracy they are for general guidance only and must not be relied on. The fixture and fittings referred to have not been tested and therefore no guarantee can be given that they are in working order. Internal photographs are reproduced for general information and it must not be inferred that any item shown is included with the property.

Cow & Co
LONDON