





7 Dudley Place, Stanwell, Staines-upon-Thames, Surrey TW19 7BG
£219,950 - Leasehold



PROPERTY DESCRIPTION

Offered for sale with vacant possession and no onward chain, this modern, ground floor apartment is perfectly located for London Heathrow Airport and offers well presented accommodation throughout including a good size lounge/dining room with pull down double bed for extra sleeping arrangements , spacious double bedroom which has been divided into two smaller rooms but can easily be converted back to one room. Modern fitted kitchen with appliances and a modern shower room. Communal gardens and allocated parking make this an an ideal purchase for the first time buyer or investment buyer with 137 years remaining on the lease. Viewings are highly recommended.

POINTS OF INTEREST

- Modern ground floor apartment
- For sale with no onward chain
- Secure intercom entry system
- Allocated parking space
- Separate kitchen with appliances
- Modern shower room
- Pull down double bed in living room
- Access to communal gardens



GROUND FLOOR
478 sq.ft. (44.4 sq.m.) approx.

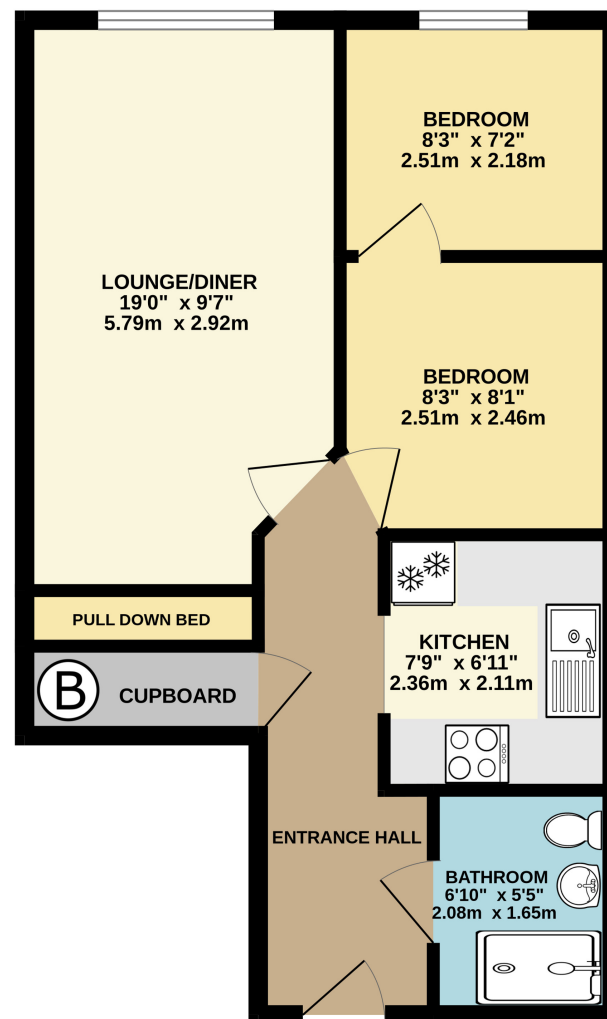

TOTAL FLOOR AREA : 478 sq.ft. (44.4 sq.m.) approx.

Whilst every attempt has been made to ensure the accuracy of the floorplan contained here, measurements of doors, windows, rooms and any other items are approximate and no responsibility is taken for any error, omission or mis-statement. This plan is for illustrative purposes only and should be used as such by any prospective purchaser. The services, systems and appliances shown have not been tested and no guarantee as to their operability or efficiency can be given.
Made with Metropix ©2025