



Two Bedroom Terraced House

Gladstone Road, Penenden Heath, Maidstone, Kent, ME14 2AU

Offers in Excess of £250,000

Freehold

Gladstone Road, Penenden Heath, Maidstone, Kent, ME14 2AU

Offers in Excess of £250,000

Freehold

Description

Being offered with no forward chain and within walking distance to Maidstone is this charming two bedroom Victorian house. This is ideal for the first time buyer, professionals or investors alike.

The property comprises of two reception rooms, the lounge to the front with a feature fireplace. The dining room is a good size with stairs to the first floor. Continuing through the kitchen offers a range of fitted wall and base units, cooker to remain. There is a downstairs bathroom with three piece suite. Upstairs you have two double bedrooms. Externally the rear garden is private and enclosed with fence surround, patio and grass area.

Key Features

- No Forward Chain
- Two Double Bedrooms
- Downstairs Bathroom
- Two Reception Rooms
- Popular Location
- Ideal for First Time Buyers or Investors
- Walking Distance to Town Centre

Local Area

Based in the county of Kent, south of England, Maidstone is partitioned by the meandering River Medway. Within the county, it's the economic and agricultural center. It's also a major English tourist attraction, oozing both historical and contemporary cultures which can be seen reflected in its magnificent architecture and wide array of cultural centers. Transport links are just a stone through away as Maidstone connects to the A2 / M20 and M2 motorways.

GROUND FLOOR
365 sq.ft. (33.9 sq.m.) approx.

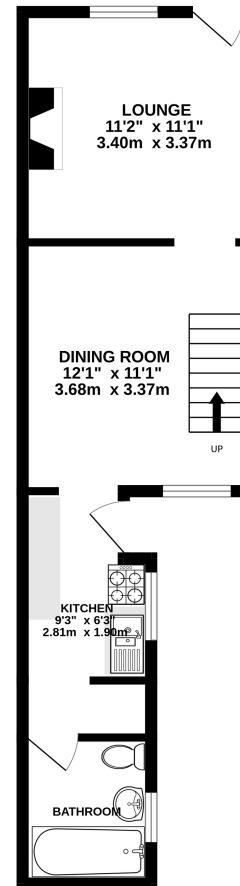

1ST FLOOR
253 sq.ft. (23.5 sq.m.) approx.

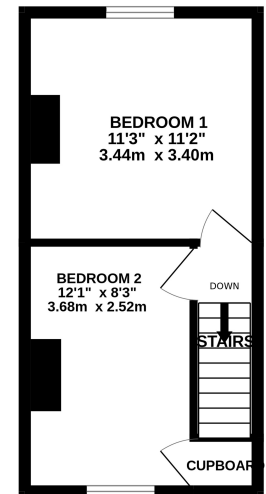

TOTAL FLOOR AREA : 618 sq.ft. (57.4 sq.m.) approx.

Whilst every attempt has been made to ensure the accuracy of the floorplan contained here, measurements of doors, windows, rooms and any other items are approximate and no responsibility is taken for any error, omission or mis-statement. This plan is for illustrative purposes only and should be used as such by any prospective purchaser. The services, systems and appliances shown have not been tested and no guarantee as to their operability or efficiency can be given.

Made with Metropix ©2023



Property Location

Gladstone Road, Penenden Heath, Maidstone, Kent, ME14 2AU

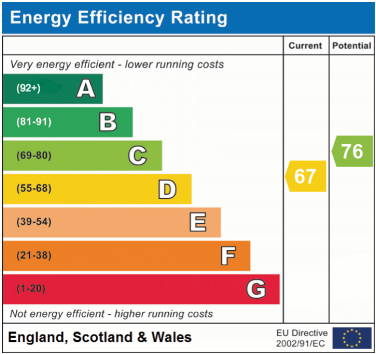
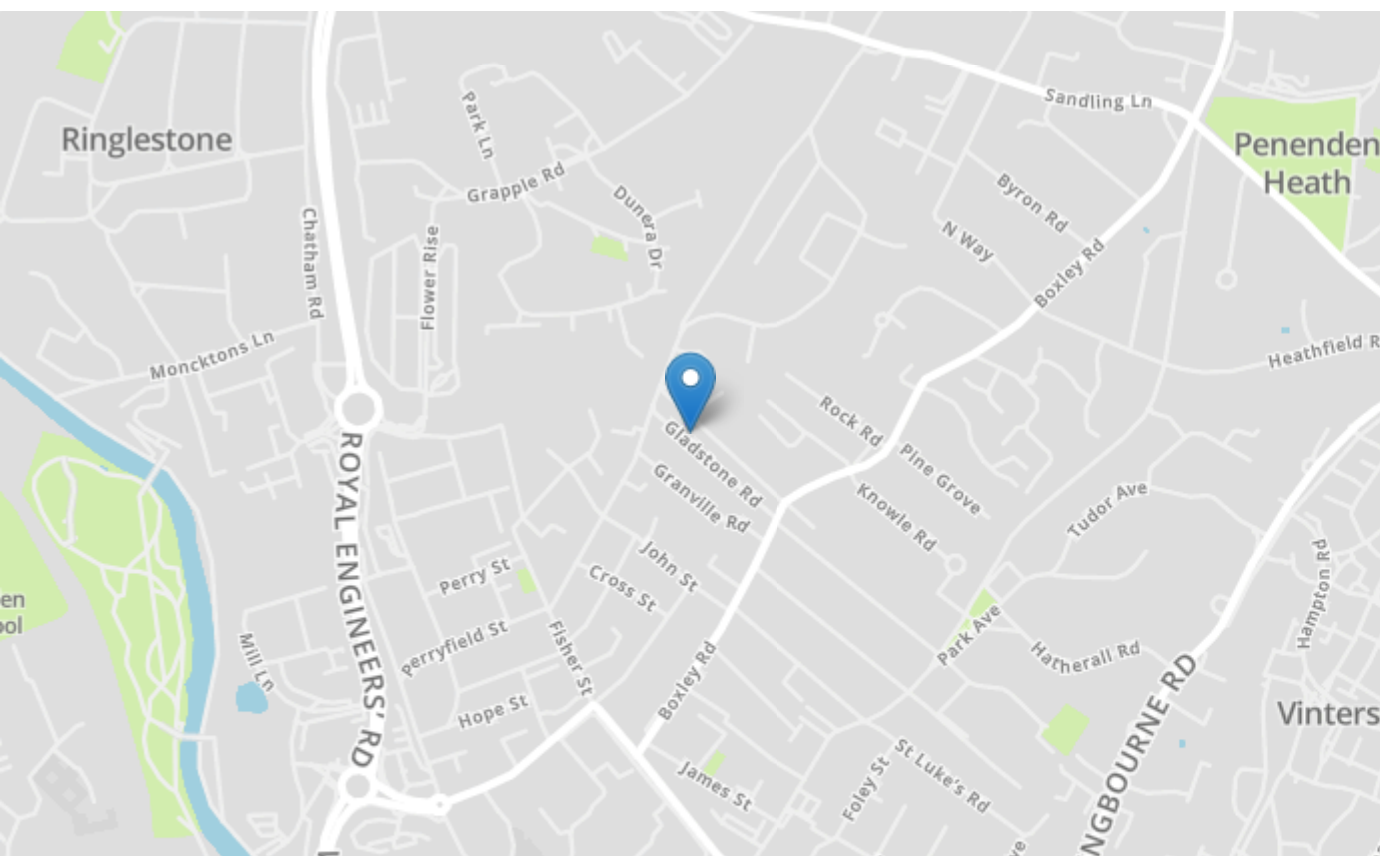

Tenure	Freehold
Lease Term	N/A
Ground Rent	N/A
Service Charge	N/A
Local Authority	Maidstone
Council Tax	Band B

Greyfox Walderslade
Unit 2, Thetford House
Walderslade Village Centre
Walderslade Road
Chatham
Kent
ME5 9LR
Tel: 01634 672227 Email:
walderslade@greyfox.co.uk

Greyfox Rainham
67C High Street
Rainham
Kent
ME8 7HS

Tel: 01634 377737 Email:
rainham@greyfox.co.uk

Agent Notes
These particulars are prepared as a general guide to a broad description of the property and should not be relied upon as a statement or representation of fact and do not constitute part of an offer or contract. The seller does not make or give nor do our employees or Greyfox have authority to make or give any representation or warranty to the property. We have not carried out a structural survey and the services, appliances and specific fittings have not been tested. All photographs, measurements, floorplans and distances referred to are given as a guide only and should not be relied upon for the purchase of carpets or any other fixtures or fittings. Lease details, service charges and ground rent (where applicable) and council tax are given as a guide only and should be checked and confirmed by you on inspection and your solicitor prior to exchange of contracts. If there are any points of particular importance to you we will be pleased to check the information for you and to confirm that the property remains available. This is particularly important should you be travelling some distance to view and where statements have been made by us to the effect that the information has not been verified. The copyright of all details, photographs and floorplans remain exclusive to Greyfox. For details of our privacy policy and referral fee arrangements with any of our selected partner companies please visit <https://www.greyfox.co.uk/legal/privacy> and <https://www.greyfox.co.uk/referral-fees>.