

Truuli



Buller Road, Thornton Heath, Surrey, CR7

£450,000 Freehold

- Bright and deceptively spacious throughout
- Extended kitchen breakfast room
- Double reception room with separate entrances
- Easy access of Thornton Heath mainline station
- Well maintained and presented throughout
- Guide price of £450,000 - £475,000

2, Lansdowne Road, Croydon, Surrey, CR9 2ER

Tel: 0330 043 0002

Email: save@truuli.co.uk Web: www.truuli.co.uk

Buller Road, Thornton Heath, Surrey, CR7

£450,000 Freehold

A deceptively spacious three-bedroom family house that has been well maintained over the years by the current owners. The property is within easy reach of Thornton Heath mainline station.

Ground Floor
654 sq.ft. (60.8 sq.m.) approx.

1st Floor
467 sq.ft. (43.4 sq.m.) approx.

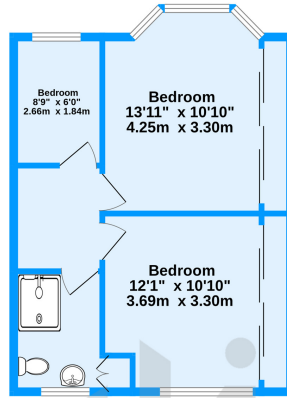
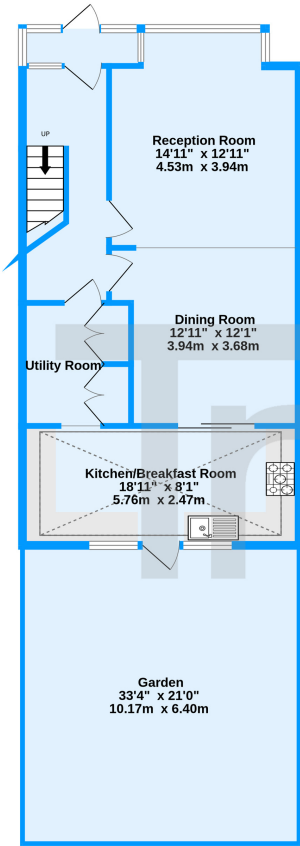

Buller Road, Thornton Heath, CR7

TOTAL FLOOR AREA: 1121 sq.ft. (104.1 sq.m.) approx.
Measurements are approximate. Not to scale. Illustrative purposes only
Made with Metropix ©2023

Energy Efficiency Rating		Current	Potential
Very energy efficient - lower running costs			
(92-100) A			
(81-91) B			88
(69-80) C		75	
(55-68) D			
(39-54) E			
(21-38) F			
(1-20) G			
Not energy efficient - higher running costs			
England, Scotland & Wales		EU Directive 2002/91/EC	

