

FOR SALE

£270,000

Farm Close, Greasby, Wirral. CH49 3GW



Build your dream home! Fantastic opportunity to purchase this well-proportioned two bedroom detached bungalow on the sought after Farm Close in Greasby. Situated in a quiet position in the close, this gem is in need of modernisation but would be the ideal property for a buyer to put their own stamp on and has the added benefit of entering the market with no onward chain.

The bungalow comprises an entrance hallway with a spacious open-plan lounge/diner which has the potential to convert into a third bedroom should the layout should a buyer wish to do so.





Ground Floor

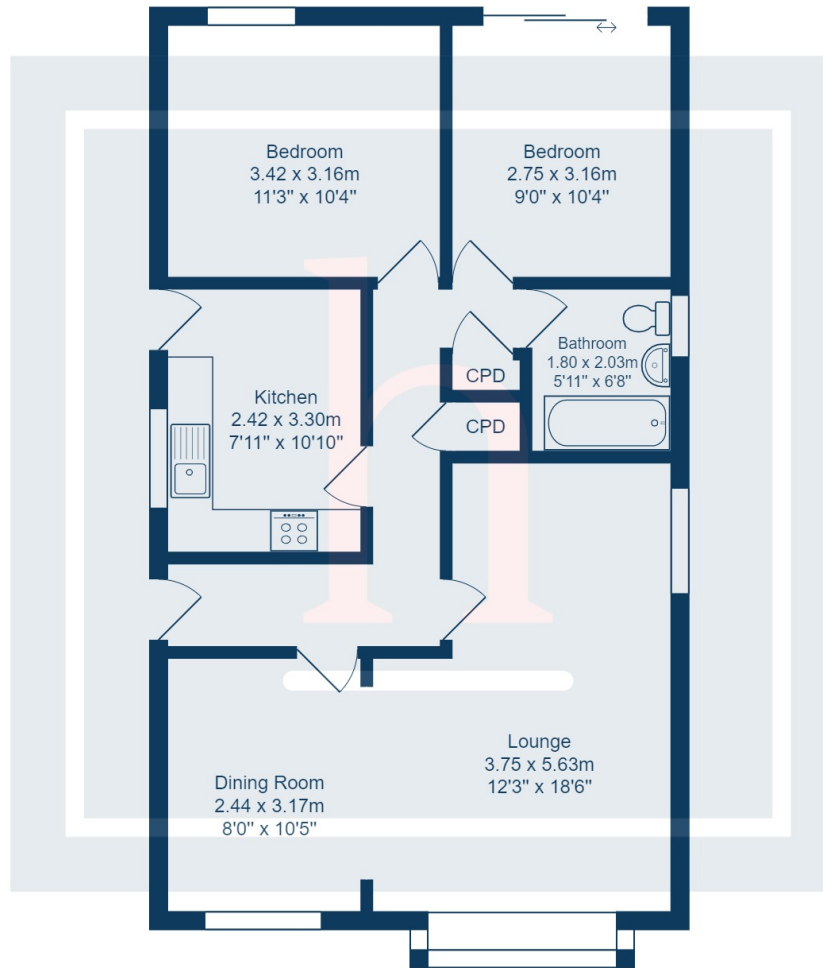

Total Area: 71.6 m² ... 771 ft²

All measurements are approximate and for display purposes only.