

Truuli



Violet Lane, Croydon, Surrey, CR0 4HD

£550,000 Freehold

- No onward chain
- Three bedroom semi detached house
- Parquet flooring
- Garage & off-street parking
- Easy access to both South Croydon and East Croydon train stations
- Close to local amenities, schools, and parks
- Spacious accommodation throughout
- Utility room / shower room

Southbridge Place, Surrey, CR0 4HA

Tel: 0330 043 0002

Email: save@truuli.co.uk Web: www.truuli.co.uk

47 Violet Lane, Croydon, Surrey, CR0 4HD

£550,000 Freehold

Vendor comments "We've loved living in this home and have so many happy memories here.

Upstairs, there are three bedrooms: two larger ones with built-in cupboards that offer plenty of storage, and a smaller bedroom with a lovely balcony overlooking the back garden. There's also a family bathroom with a walk-in shower and generous loft space for extra storage or future use.

This house has been a wonderful place for us and we truly hope the next owners will enjoy it and create their own memories here, just as we have".

Violet Lane

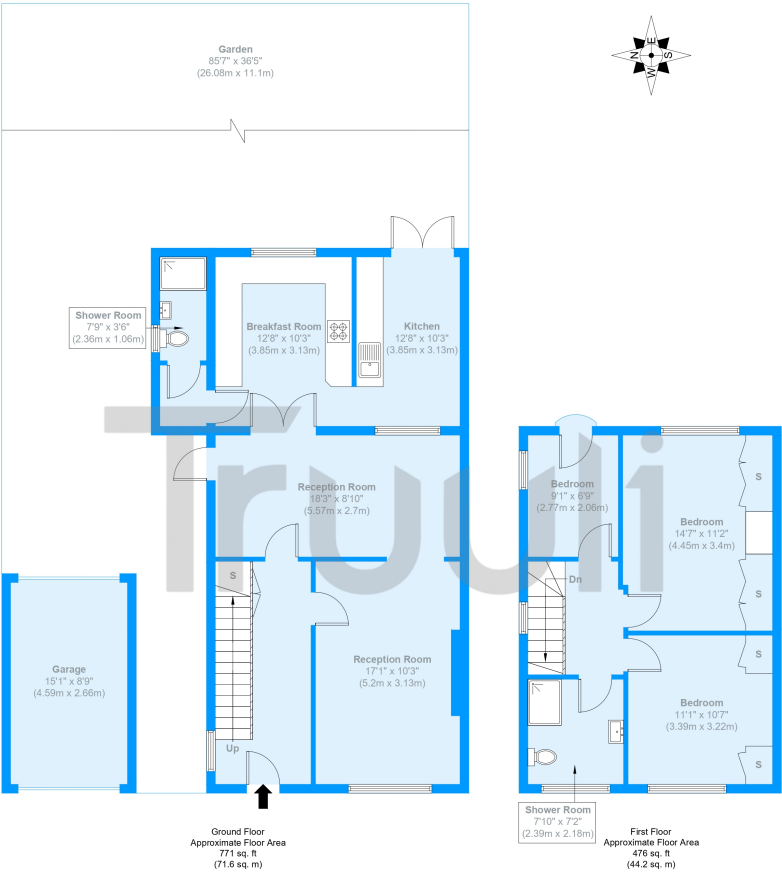

Approximate Gross Internal Area = 115.8 sq m / 1246 sq ft
Garage = 12.2 sq m / 131 sq ft
Total = 128 sq m / 1378 sq ft

The Floor plan is not to scale and measurements and areas shown are approximate and therefore should be used for illustrative purposes only. The plan has been prepared in accordance with the RICS code of Measuring Practice and whilst we have confidence in the information produced it must not be relied on. Maximum lengths and widths are represented on the floor plan. If there is any aspect of particular importance, you should carry out or commission your own inspection of the property.
Copyright © BleuPlan

