



Rushfield, Potters Bar, Hertfordshire, EN6

£2,150 pcm

- 3 BEDROOMS
- LOUNGE/DINING ROOM
- KITCHEN
- DOWNSTAIRS CLOAKROOM
- FIRST FLOOR BATHROOM
- OFF STREET PARKING
- GARDEN

Rushfield, Potters Bar, Hertfordshire, . EN6

£2,150 pcm Freehold

A THREE BEDROOM SEMI DETACHED HOUSE situated in this most sought after location within 0.2 miles of DAME ALICE OWEN. The property has 3 bedrooms and a bathroom on the first floor, and an open plan lounge/dining room on the ground, as well as a kitchen and cloakroom W/C. There is off street parking to the front for two vehicles and there is a garden to the side with a brick built tool store.

Rushfield is within walking distance of a range of local amenities including Cranborne parade shops including a Tesco express. Potters Bar main line station is also within easy reach as is M.25 and A.1m motorway junctions.

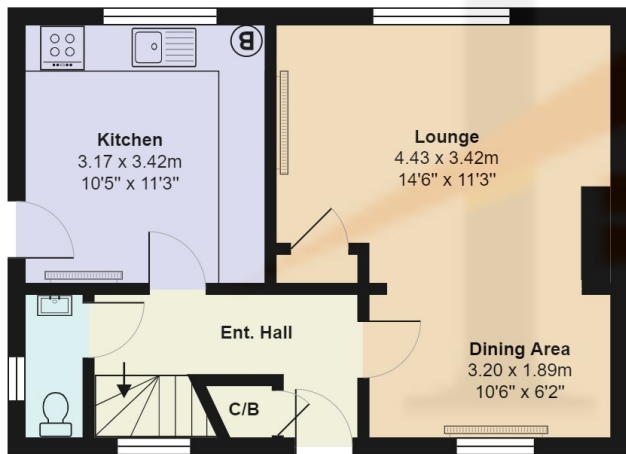

Ground Floor
 Area: 42.5 m² ... 457 ft²

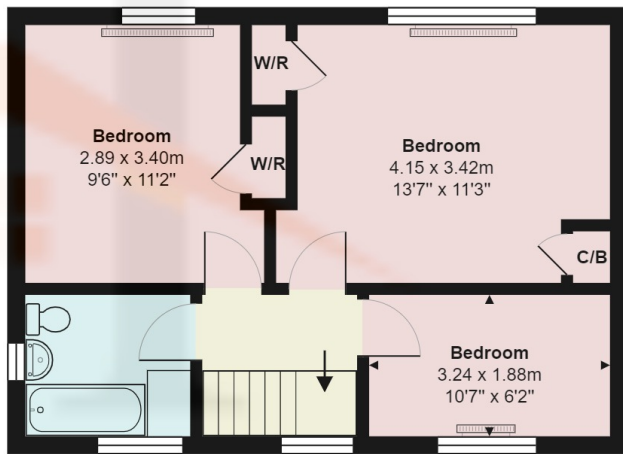

First Floor
 Area: 42.4 m² ... 456 ft²

Rushfield, Hertfordshire EN6

Total Area: 84.9 m² ... 914 ft²

All measurements are approximate and for display purposes only



| Energy Efficiency Rating | | Current | Potential |
|---|--|-------------------------|-----------|
| Very energy efficient - lower running costs | | | |
| (92-100) A | | | |
| (81-91) B | | | 85 |
| (69-80) C | | | |
| (55-68) D | | 59 | |
| (39-54) E | | | |
| (21-38) F | | | |
| (1-20) G | | | |
| Not energy efficient - higher running costs | | | |
| England, Scotland & Wales | | EU Directive 2002/91/EC | |

