

Truuli



London, SE19 3NN
£400,000 Share of Freehold

- Share of freehold
- Well maintained and presented throughout
- Two double bedrooms
- Easy access into Crystal Palace Triangle
- Communal bike store on the road
- Guide price £400,000 - £425,000

London, SE19 3NN

£400,000 Share of Freehold

*** Guide price £400,000 - £425,000 *** We are pleased to present to the market, this delightful ground floor share of freehold flat located on Queen Mary Road Upper Norwood. The flat is located in a serene and sought-after neighbourhood. Boasting a blend of classic charm and modern comfort, this well-maintained property offers an exceptional living experience.

Step inside to discover a beautifully presented living space, the bright and airy living room is complemented by large windows that flood the space with natural light, creating a warm and welcoming ambience.

Ground Floor
642 sq.ft. (59.6 sq.m.) approx.

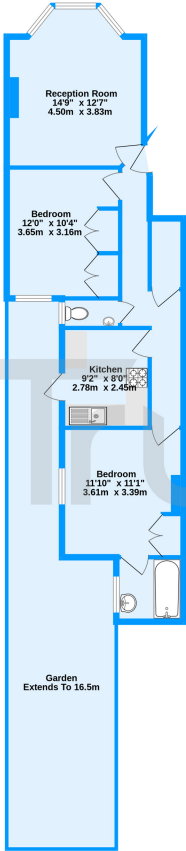

Queen Mary's Road, London, SE19

TOTAL FLOOR AREA : 642 sq.ft. (59.6 sq.m.) approx.
Measurements are approximate. Not to scale. Illustrative purposes only
Made with Metropix ©2024

Energy Efficiency Rating		
	Current	Potential
Very energy efficient - lower running costs		
(92+)		
A		
(81-91)		
B		
(69-80)		
C		
(55-68)	66	76
D		
(39-54)		
E		
(21-38)		
F		
(1-20)		
G		
Not energy efficient - higher running costs		
England, Scotland & Wales	EU Directive 2002/91/EC	

