



5 Cambridge Gardens, Langford, Biggleswade, Bedfordshire, SG18 9SF

£550,000

Individual detached family home located in this popular tree lined road. Offering good sized accommodation with the benefit of a 21FT sitting room, 15FT Kitchen/Breakfast room, 17FT conservatory and three double bedrooms. Although some updating is required this house has great potential to improve/extend and is situated on impressive, mature garden with various area to enjoy including a summer house and extensive vegetable garden. Ample off road parking via driveway and double length garage. NO CHAIN



- INDIVIDUAL DETACHED FAMILY HOME
- SOUGHT AFTER TREE-LINED ROAD
- SITTING ROOM + 17FT CONSERVATORY
- KITCHEN/BREAKFAST ROOM
- DOWNSTAIRS CLOAKROOM/SHOWER ROOM
- THREE DOUBLE BEDROOMS
- 39FT GARAGE/WORKSHOP
- LARGE ESTABLISHED GARDEN WITH SUMMER HOUSE + KITCHEN GARDEN
- CLOSE TO A1 MOTORWAY + RAILWAY STATION (BIGGLESWADE)
- NO CHAIN

Approximate Gross Internal Area
 Ground Floor = 121.5 sq m / 1,308 sq ft
 (Including Garage / Workshop)
 First Floor = 52.0 sq m / 560 sq ft
 Summer House = 7.9 sq m / 85 sq ft
 Total = 181.4 sq m / 1,953 sq ft

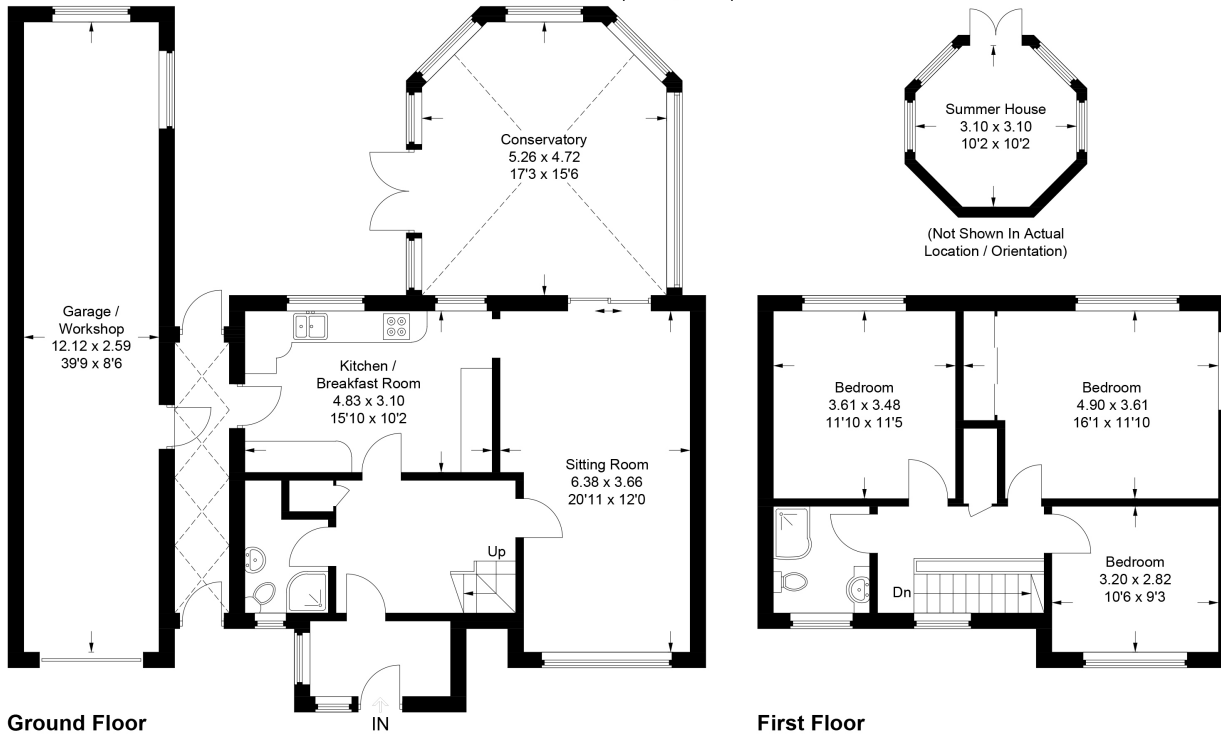

This plan is for layout guidance only. Not drawn to scale unless stated. Windows and door openings are approximate. Whilst every care is taken in the preparation of this plan, please check all dimensions, shapes and compass bearings before making any decisions reliant upon them.
 © CJ Property Marketing Ltd Produced for Lane & Bennetts

