

Peter Lane & Partners, for themselves as agents for the Vendors or Lessors of this property give notice that these particulars are produced in good faith and are to act purely as a guide to the property and do not have the authority to make or give any warranty, guarantee or representation whatsoever in relation to this property.

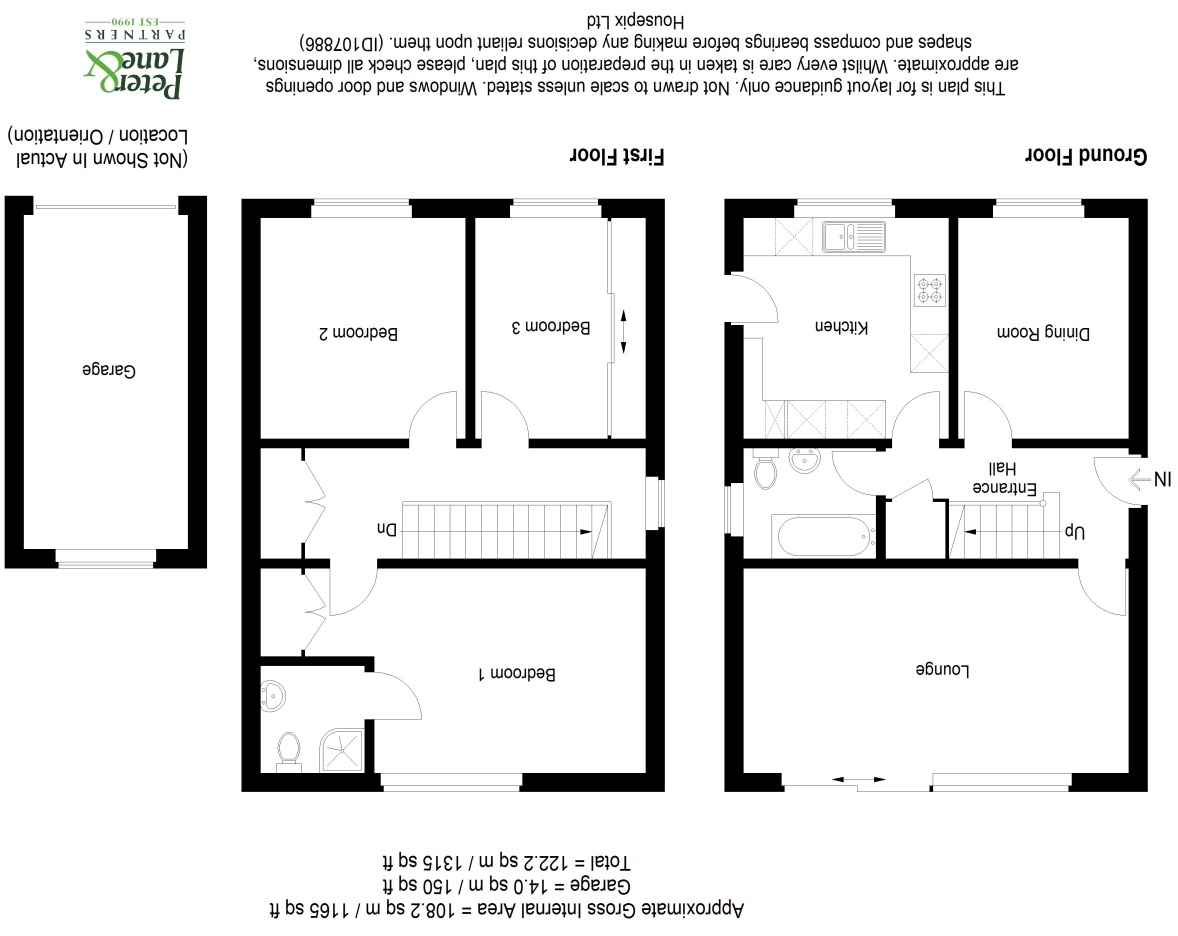

Huntingdon St Neots 32 Market Square St Neots Kimbolton
 Tel: 01480 414800 Tel: 01480 406400 Tel: 01480 860400
 Huntingdon St Neots Kimbolton
 Tel: 01480 414800 Tel: 01480 860400
 60 High Street 24 High Street
 Cashel House
 Mayfair Office
 Tel: 0870 1127099

Huntingdon Office: 01480 414800
 www.peterlane.co.uk Web office open all day every day

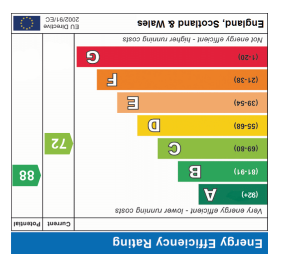

This plan is for layout guidance only. Not drawn to scale unless stated. Windows and door openings are approximate. Whilst every care is taken in the preparation of this plan, please check all dimensions, shapes and compass bearings before making any decisions reliant upon them. (ID107886)



- Detached Family Home
- En Suite And Family Bathroom
- Single Garage
- Established Rear Garden

- Three Bedrooms
- Re-Fitted Kitchen
- Extensive Timber Deck With Bar/Summer House
- Popular Village Location



UPVC Fan Light Stained Glass Panel Door To

Entrance Hall

13' 5" x 5' 10" (4.09m x 1.78m)

Stairs to first floor with understairs storage cupboard, double panel radiator, coving to ceiling, composite flooring.

Kitchen

11' 7" x 10' 7" (3.53m x 3.23m)

Beautifully re-fitted in a range of Shaker style contemporary grey toned cabinets with complementing work surfaces, drawer units, pan drawers, electric and gas cooker points with suspended extractor fitted above, under unit lighting, single drainer one and a half bowl resin sink unit with mono bloc mixer tap, UPVC window to front aspect, appliance spaces, racked larder unit, coving to ceiling, UPVC door to garden aspect, composite flooring.

Family Bathroom

6' 7" x 5' 8" (2.01m x 1.73m)

Re-fitted in a three piece white suite comprising low level WC, pedestal wash hand basin with mixer tap, panel bath with folding screen and mixer tap with independent shower unit fitted over, recessed lighting, coving to ceiling, chrome heated towel rail, contour border tiles, UPVC window to garden aspect, ceramic tiled flooring.

Sitting Room

19' 11" x 10' 10" (6.07m x 3.30m)

Full height UPVC windows and French doors accessing garden terrace to the rear, TV point, telephone point, radiator with decorative cover, additional radiator, coving to ceiling, composite flooring.

Dining Room

11' 7" x 6' 0" (3.53m x 1.83m)

UPVC window to rear aspect, radiator.

First Floor Galleried Landing

17' 7" x 6' 0" (5.36m x 1.83m)

Access to insulated loft space, coving to ceiling, cupboard storage housing gas fired central heating boiler serving hot water system and radiators with shelf space, UPVC window to side aspect, small study area.

Principal Bedroom

17' 5" x 10' 11" (5.31m x 3.33m)

UPVC window to garden aspect, double panel radiator, coving to ceiling, double wardrobe with hanging and shelving, laminate flooring.

En Suite Shower Room

5' 8" x 5' 7" (1.73m x 1.70m)

Fitted in a three piece white suite comprising low level WC, vanity wash hand basin with mixer tap and tiling, screened shower enclosure with independent shower unit fitted over, chrome heated towel rail, composite flooring.

Bedroom 2

11' 5" x 10' 9" (3.48m x 3.28m)

Coving to ceiling, double panel radiator, UPVC window to front aspect, laminate flooring.

Bedroom 3

11' 7" x 6' 0" (3.53m x 1.83m)

UPVC window to front aspect, extensive wardrobe range with hanging and shelving, laminate flooring.

Outside

The front garden has parking provision for several vehicles accessing the **Garage** with up and over door, power, lighting and eaves storage. The rear garden measures 65' 7" x 62' 4" (19.99m x 19.00m) and is substantial and beautifully arranged with an extensive timber deck leading in to a **Bar/Summer House** measuring 12' 4" x 9' 5" (3.76m x 2.87m) with power, lighting, insulation, laminate flooring and double doors access a covered deck to the front, areas of lawn, two timber sheds, outside lighting, a further seating area leading on to constructed raised planters stocked with herbs, outside lighting and gated access to the front enclosed by a combination of brick walling and panel fencing offering a good degree of privacy, established specimen trees and specimen shrubs, a selection of fruit trees incorporating Pear, Cherry and Bramley Cooking Apple, potting shed, greenhouse, a child's wooden playhouse, screened bin store.

Tenure

Freehold

Council Tax Band - D

