SOLE
AGENT

Mayfield

Les Landes Clos | Landes Du Marche | Vale |

This detached bungalow is presented in excellent condition having been recently upgraded by the current owners. The property is hidden away from the main road in a quiet clos which is conveniently located near shops and a cafe, while also near a bus route and within comfortable walking distance of Sausmarez Park and the KGV. The light and spacious accommodation comprises lounge, kitchen/diner, two double bedrooms and a bathroom. To the rear of the property is a good-sized low-maintenance garden. In addition to the garage/workshop, the driveway provides parking for multiple vehicles. This low maintenance home is ideal for those looking to downsize but also offers potential to extend in the future should the purchaser require it.

2 BEDROOMS

1 BATHROOM

1 RECEPTION

£625,000

ESTATE AGENTS & PROPERTY MANAGERS

**Shields
& Rutland**

OPENING DOORS SINCE 1993

PHOTOS



PHOTOS



SPECIFICATIONS

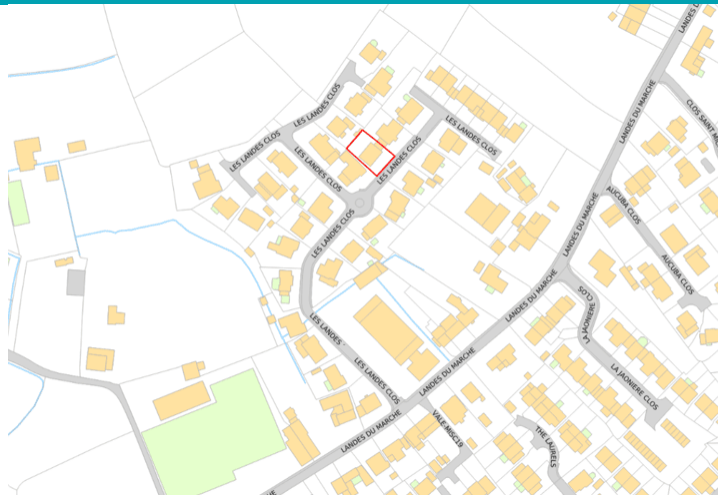

Entrance Hall

4.64m x 1.36m (15' 3" x 4' 6")

Lounge

3.95m x 4.24m (13' 0" x 13' 11")

Kitchen/Diner

4.07m x 3.65m (13' 4" x 12' 0")

Rear Porch

0.91m x 0.84m (3' 0" x 2' 9")

Bedroom 1

3.94m x 3.64m (12' 11" x 11' 11")

Bedroom 2

3.93m x 3.34m (12' 11" x 10' 11")

Shower Room

2.42m x 2.14m (7' 11" x 7' 0")

Garage/Workshop

4.91m x 2.76m (16' 1" x 9' 1")

Garden

To the rear of the property is a good-sized low-maintenance garden.

Parking

In addition to the garage/workshop, the driveway provides parking for multiple vehicles.

PRICE INCLUDES

Curtains, carpets and light fittings.

SPECIAL FEATURES

- uPVC double glazed
- Quiet Clos
- Light and spacious

SERVICES

Mains drain, water and electricity.
Oil fired central heating.

APPLIANCES INCLUDED

- Neff double oven
- Neff four ring hob

SCHOOL CATCHMENT

Hautes Capelles Primary School
and St Sampson High School

GROUND FLOOR

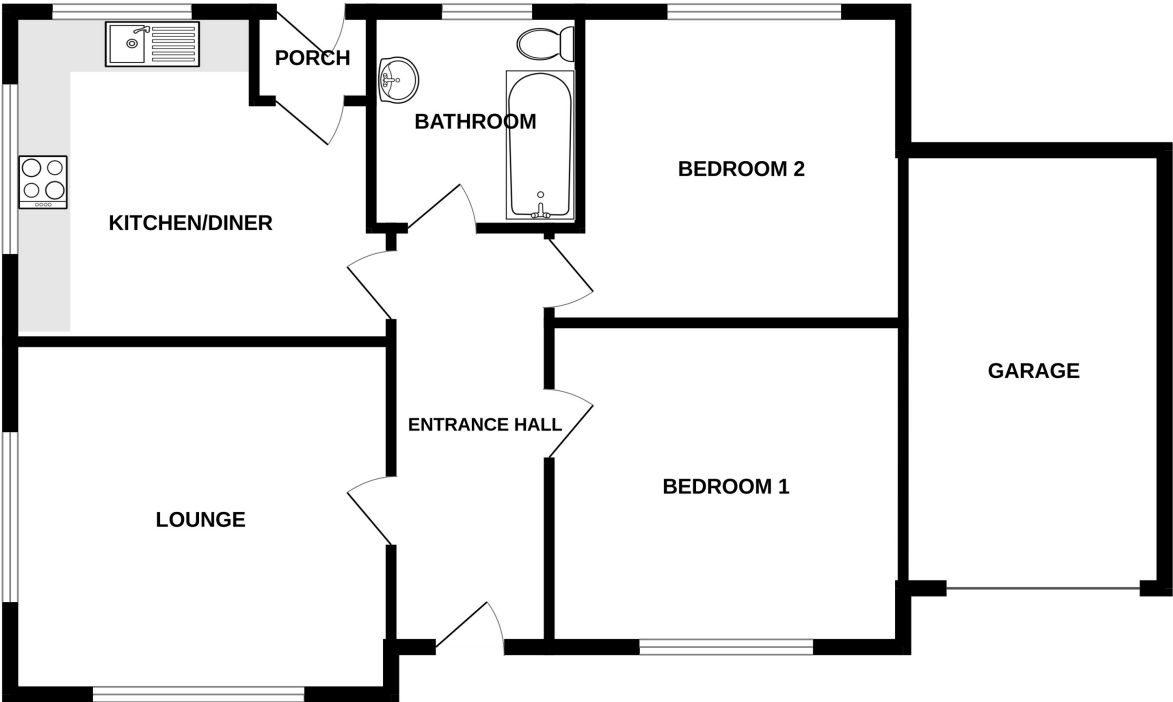

MAYFIELD

Whilst every attempt has been made to ensure the accuracy of the floorplan contained here, measurements of doors, windows, rooms and any other items are approximate and no responsibility is taken for any error, omission or mis-statement. This plan is for illustrative purposes only and should be used as such by any prospective purchaser. The services, systems and appliances shown have not been tested and no guarantee as to their operability or efficiency can be given.
Made with Metropix ©2023