



37, Old School Close

Codicote,
Hertfordshire, SG4 8YJ
£345,000

country
properties

This nicely presented two bedroom staggered terrace house is located in a tucked away location which is extremely convenient for the village centre.

Ground Floor

Entrance lobby

Glazed panelled entrance door to lobby, door to side, door to lounge

Lounge

12' 2" x 11' 8" (3.71m x 3.56m)

Kitchen/breakfast room

11' 8" x 10' 10" (3.56m x 3.30m)

Re fitted kitchen complimented by wooden work surfaces, consisting of base and eye level units with Bosch hob with extractor over, built in oven, integrated sink unit, under stairs cupboard, integrated dishwasher, wood style floor, downlighters, door to garden.

First floor

landing

Recess housing Johnson and Starley gas fired warm air central heating system.

Bedroom One

12' 4" x 11' 8" (3.76m x 3.56m)

Window to front.

Bedroom Two

7' 2" x 6' 9" (2.18m x 2.06m)

Window to rear.

Bathroom

At present arranged as shower room with cubicle, wash hand basin, wc, fully tiled walls, window to rear, downlighters.



Outside

Front of house

To the front the garden is laid to lawn with borders. Visitor parking.

Rear Garden

The secluded rear garden is part laid to decking with flower beds, shrubs, outside tap, close interwoven fencing, gate to rear, with access to garage.

Garage

Single garage en bloc

Agents notes

The heating system is served by a number of warm air vents throughout the house.



Ground Floor

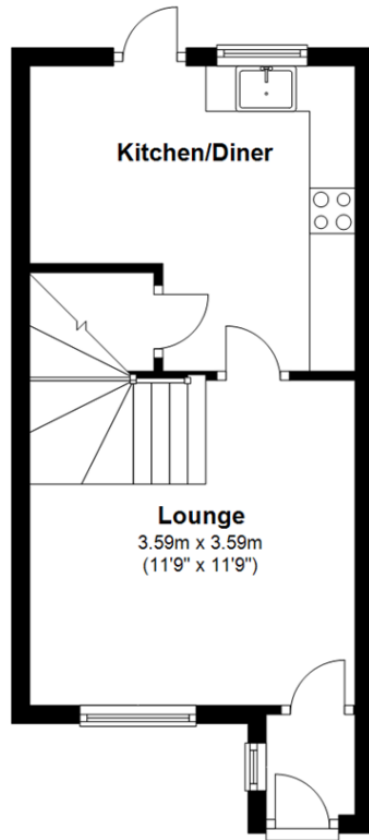

First Floor

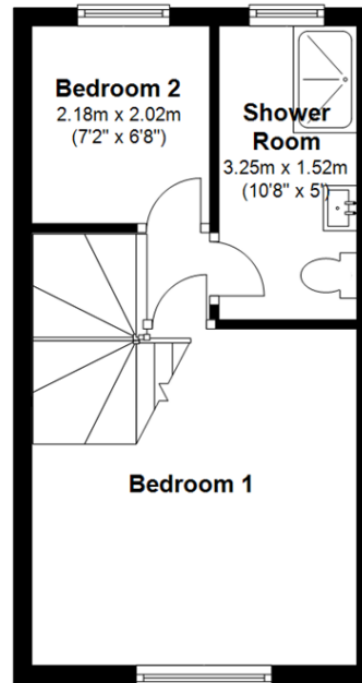

All measurements are approximate and quoted in metric with imperial equivalents and for general guidance only and whilst every attempt has been made to ensure accuracy, they must not be relied on. The fixtures, fittings and appliances referred to have not been tested and therefore no guarantee can be given and that they are in working order. Internal photographs are reproduced for general information and it must not be inferred that any item shown is included with the property. For a free

Viewing by appointment only

Country Properties | 10, High Street | AL6 9EQ

T: 01438 716471 | E: welwyn@country-properties.co.uk

www.country-properties.co.uk

country
properties