

51 Glenfield Road

Dover
CT16 2AL

£190,000 FREEHOLD

Draft Details...FOR SALE THROUGH BURNAP + ABEL.....Price Range £190,000 - £200,000 | Fantastic Three-Bedroom Terraced Home | Chain-Free | Sought-After Location | Sunny Rear Garden | Located in the highly desirable Glenfield Road, Dover, this fantastic three-bedroom terraced home offers spacious and comfortable living, perfect for first-time buyers or growing families. The property features a welcoming lounge, a spacious kitchen, family bathroom and a generous sunny rear garden, ideal for relaxing or entertaining. Upstairs, there are three well-proportioned bedrooms. Additional benefits include double glazing, gas central heating, and a boiler serviced in September 2025, ensuring peace of mind for the new owners. Situated within close proximity to a variety of local schools, shops, and amenities, this chain-free property represents an excellent opportunity to move straight in and make it your own. Don't miss out - contact Burnap + Abel on 01304 279107 to arrange a viewing.



Lounge

13' 0" x 12' 0" (3.96m x 3.66m)

Kitchen/Dining Room

12' 2" x 8' 11" (3.71m x 2.72m)

Bathroom

5' 6" x 4' 9" (1.68m x 1.45m)

Bedroom One

12' 1" x 8' 10" (3.68m x 2.69m)

Bedroom Two

9' 0" x 8' 10" (2.74m x 2.69m)

Bedroom Three

8' 5" x 5' 6" (2.57m x 1.68m)

Garden

Area Information

Glenfield Road is a quiet road with no passing traffic on the outskirts of Dover. It is an ever popular residential street positioned just a short distance from a range of local amenities and transport links.

Dover is a major ferry port town and faces France across the Strait of Dover, the narrowest part of the English Channel. It is home of the Dover Calais ferry through the Port of Dover and is famous for both its White Cliffs and the historic Dover Castle.

Dover’s main commuting roads are the A2 and A20, connecting the town with Canterbury and London. Fast link trains run from Dover Priory to London St Pancras International stations and Ramsgate.

Ground Floor

Approx. 28.0 sq. metres (301.0 sq. feet)

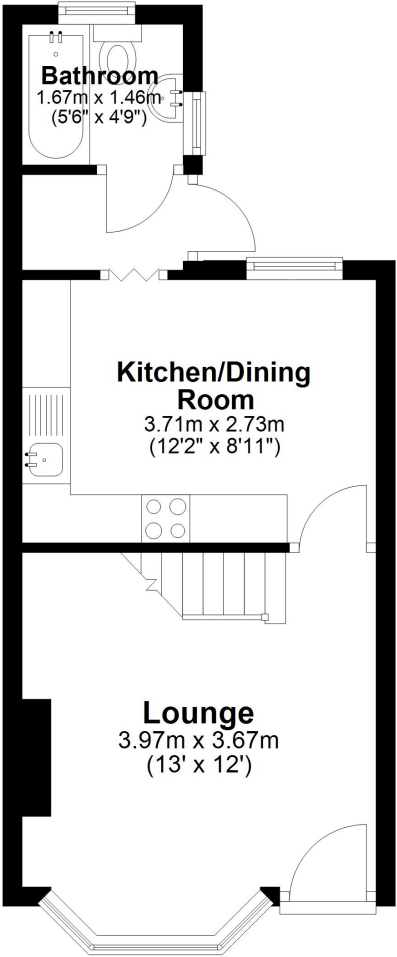

First Floor

Approx. 27.9 sq. metres (300.0 sq. feet)

