

FOR SALE

£160,000 Leasehold



189 Kimbolton Crescent, Stevenage, Hertfordshire. SG2 8RW

- CHAIN FREE
- DOUBLE BEDROOM
- FIRST FLOOR APARTMENT
- FITTED KITCHEN
- BATHROOM

- DOUBLE GLAZING
- GAS CENTRAL HEATING
- COMMUNAL PARKING
- COMMUNAL GARDEN
- COMMUNAL WASHING AREA



PROPERTY DESCRIPTION

Being sold chain free, this first floor, one bedroom maisonette is located in the sought after location off of Hertford Road. The property is a great starter home or investment offering; good size lounge/diner, fitted kitchen, double bedroom, bathroom and study. Outside benefits from ample parking and communal washing lines.

Kimbolton Crescent is situated in South Stevenage, walking distance to lots of amenities whilst also having great transport links

Marymead Medical Practice 0.2 Miles

Local Shops 0.3 Miles

Shephalbury Park Primary School 0.4 Miles

Knebworth Train Station 0.8 Miles

A1(m) Junction 7 1.2 Miles

Stevenage Town Centre 1.9 Miles



ROOM DESCRIPTIONS

FIRST FLOOR APARTMENT

ENTRANCE HALLWAY

Front door to the side aspect. Doors leading to all rooms. Storage cupboard housing the hot water tank.

LOUNGE/DINING AREA

4.14m x 3.56m (13' 7" x 11' 8")

Bay window to front aspect. Radiator.

KITCHEN

2.46m x 2.97m (8' 1" x 9' 9")

Fitted with a range of wall and base units with work surface over, stainless steel sink with mixer tap. Space for Cooker, Fridge/Freezer and Washing Machine. Wall mounted boiler.

Window to front aspect. Radiator.

MASTER DOUBLE BEDROOM

4.17m x 2.92m (13' 8" x 9' 7")

Window to Rear Aspect. Radiator.

BATHROOM

Bathroom comprising of bath with mixer tap, wash hand basin and W/C. Window to front aspect. Radiator,

OFFICE/STORAGE ROOM

1.8m x 1.75m (5' 11" x 5' 9")

Window to front aspect.

COMMUNAL GARDENS

Communal gardens surround the property, as well as, a communal washing area.

AGENTS NOTES

LEASE INFORMATION

Years Left TBC

Ground Rent TBC

Service Charge TBC



FLOORPLAN

KALM
- ESTATE AGENTS -

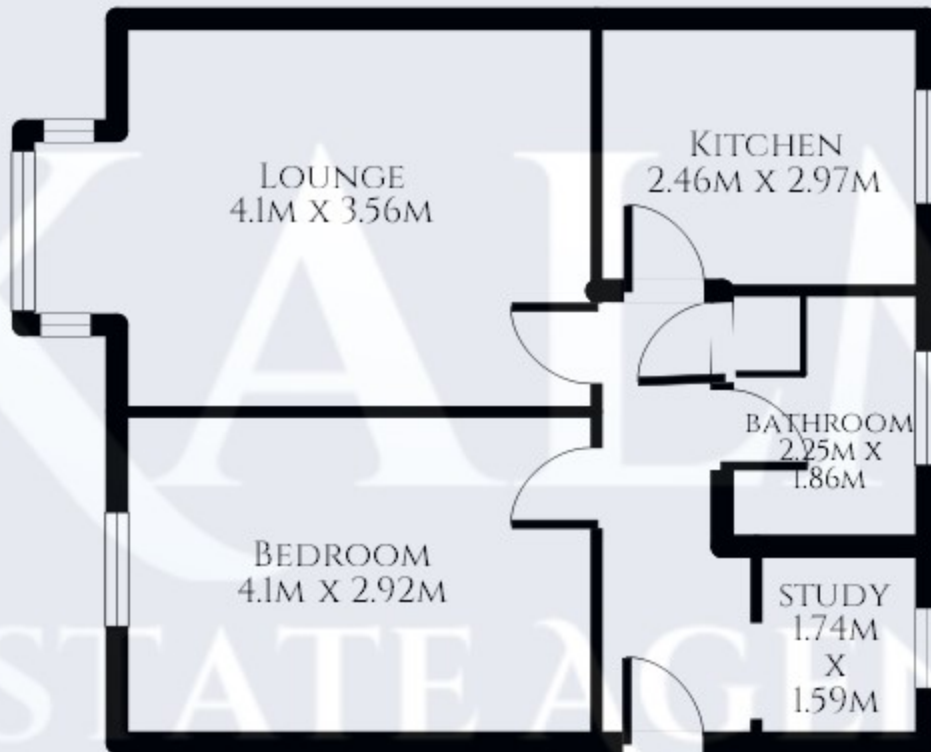

FIRST FLOOR

Stevenage
29, Shephall Green, Stevenage, SG2 9XS
01438 572020
linzi.davis@kalmestateagents.co.uk