



- Sought After Village Of Bocking
- Good Range Of Village Amenities
- Garage & Driveway Parking
- Ground Floor Cloakroom
- Three Double Bedroom Property
- Well Presented
- Single Storey Extension With Velux Window
- Two Reception Rooms
- Overlooking A Well Maintained Greensward
- EV Charging Point

22 Peter Taylor Avenue, Braintree, Essex. CM7 5GD.

Michaels Property Consultants are delighted to bring to the market this well presented and deceptively spacious three DOUBLE bedroom house, occupying a fabulous position within this riverside development, which is located within the ever sought after village of Bocking. Overlooking a well maintained greensward, we feel this contemporary and fortunately positioned family home lends itself perfectly to a buyer seeking a low maintenance purchase.



Property Details.

Ground Floor

Entrance Hall

Kitchen



8' 9" MAX x 8' 9" (2.67m x 2.67m)

Cloakroom

Living Area



12' 4" x 12' 4" (3.76m x 3.76m)

Dining Area



11' 2" x 9' 3" MAX (3.40m x 2.82m)

First Floor

Bedroom One



12' 7" x 9' 7" (3.84m x 2.92m)

Property Details.

Bedroom Two



12' 4" x 8' 9" (3.76m x 2.67m)

Bedroom Three



12' 5" x 7' 3" (3.78m x 2.21m)

Family Bathroom



Outside

Rear Garden



Under-Cover Parking To The Front Of The Dwelling

Garage To The Rear Of The Dwelling

Property Details.

Floorplans

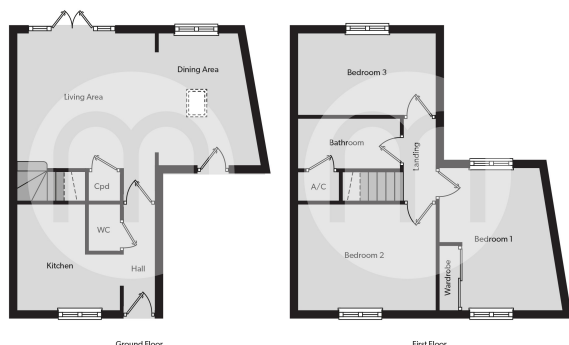

Location

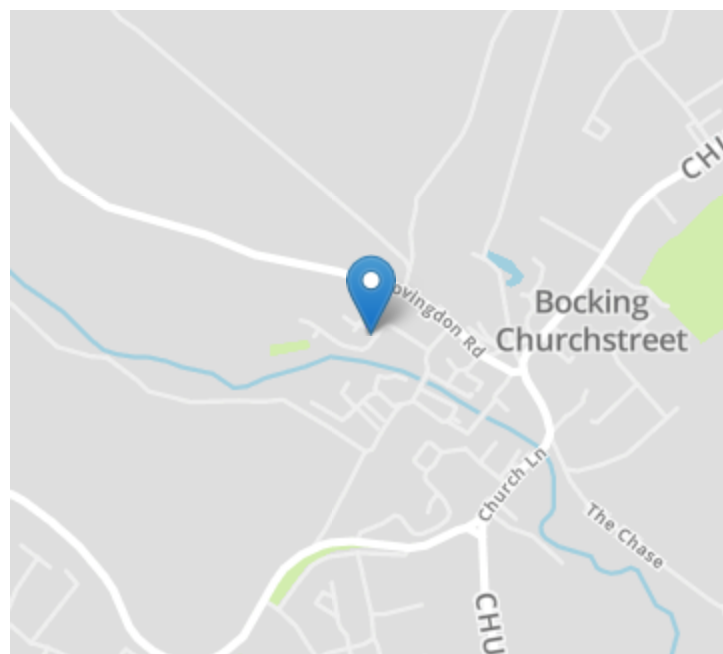

Energy Ratings

We have not carried out a structural survey and the services, appliances and specific fittings have not been tested. All photographs, measurements, floor plans and distances referred to are given as a guide only and should not be relied upon for the purchase of carpets or any other fixtures or fittings. Gardens, roof terraces, balconies and communal gardens as well as tenure and lease details cannot have their accuracy guaranteed for intending purchasers. Lease details, service ground rent (where applicable) are given as a guide only and should be checked and confirmed by your solicitor prior to exchange of contracts.