



## 75 Farnsworth Court, West Parkside, London. SE10 0RU.

£375,000

\*\*\*HUGE PRICE REDUCTION\*\*\*

Spacious two bedroom, two bathroom apartment located on the popular Greenwich Millennium Village development. This generously proportioned property offers light and airy accommodation and a private patio area. The property also benefits from a secure allocated parking space and is offered chain free.

The development is located minutes from North Greenwich tube station (Jubilee Line), the Emirates Cable Cars and the O2 with the many attractions within, including bars and restaurants. Other notable amenities within walking distance include, schools, the river bus, local retail park and supermarkets.

Viewing by appointment with 1st avenue.

**Call: 020 8293 8600**

1st avenue, 128 Metcalfe Court, West Parkside, London SE10 0EL  
email: [info@1stavenue.co.uk](mailto:info@1stavenue.co.uk)

# 75 Farnsworth Court, West Parkside, London, . SE10 0RU.

£375,000

**1stavenue**  
Real Estate Services

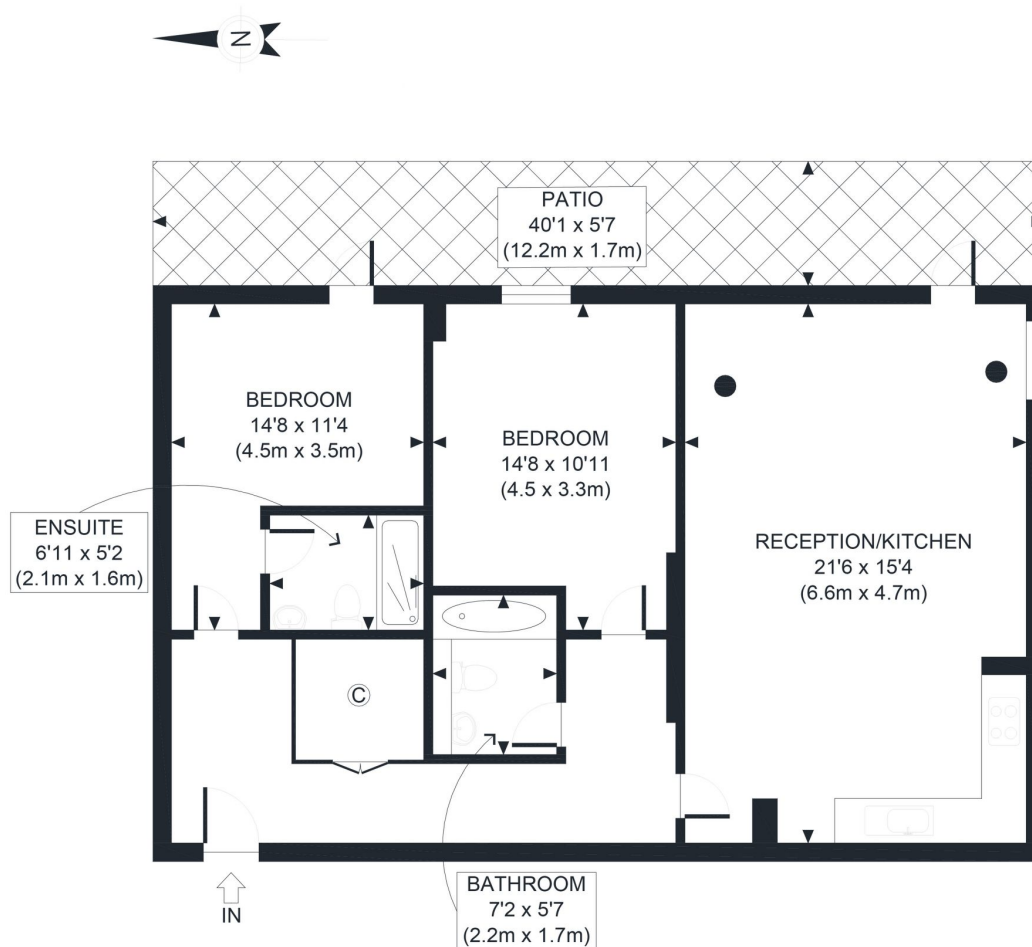

GROUND FLOOR  
GROSS INTERNAL  
FLOOR AREA 932 SQ FT

APPROX. GROSS INTERNAL FLOOR AREA 932 SQ FT / 87 SQM

Disclaimer: Floor plan measurements are approximate and are for illustrative purposes only. While we do not doubt the floor plan accuracy and completeness, you or your advisors should conduct a careful, independent investigation of the property in respect of monetary valuation

Copyright photoplan360

Viewing by appointment with 1st avenue.

**Call: 020 8293 8600**

1st avenue, 128 Metcalfe Court, West Parkside, London SE10 0EL  
email: [info@1stavenue.co.uk](mailto:info@1stavenue.co.uk)

**1stavenue**  
Real Estate Services