

47 Farmwood Close, Newport. NP19 9BR
£199,950
Tenure Freehold

- NO CHAIN
- IN NEED OF A BIT OF UPDATING
- SEMI DETACHED HOUSE
- 3 BEDROOMS

- LIVING / DINING ROOM
- FIRST FLOOR BATHROOM
- REAR GARDEN BACKING ONTO WOODLAND

NO CHAIN!! 3 BEDROOM, SEMI DETACHED HOUSE IN CONVENIENT LOCATION CLOSE TO JUNCTION 24 OF THE M4 WITH LIVING/DINING ROOM, KITCHEN, BATHROOM & GOOD SIZE REAR GARDEN

Situated just off Chepstow Road is this three bedroom, semi detached family home, located close to all local amenities, popular schools, bus routes, shopping at Newport Retail Park, world class leisure facilities at the Celtic Manor Resort whilst also having the easiest of access to junction 24 of the M4 making it perfect for commuting.

In need of a little updating with accommodation briefly comprising, to the ground floor: Entrance Hallway, Living Room opening to Dining Room & Kitchen. On the first floor: 3 Bedrooms all with fitted wardrobes & Bathroom. Outside to the front, steps lead up to the front door with flowers and shrubs with a side access door. To the rear: An tiered garden with patio area and steps up to further levels backing on to woodland.

The property further benefits from having a gas combi boiler, upvc double glazing throughout and is being offered for sale with no onward chain.

Services:

Council Tax Band:



GROUND FLOOR 486.67 sq. ft.
(45.21 sq. m.)

1ST FLOOR 442.14 sq. ft.
(41.08 sq. m.)

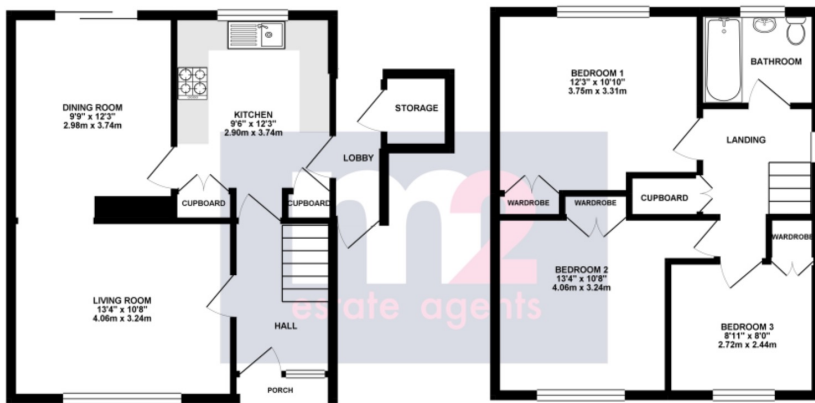

TOTAL FLOOR AREA : 928.82 sq. ft. (86.29 sq. m.) approx.

Whilst every attempt has been made to ensure the accuracy of the floorplan contained here, measurements of doors, windows, rooms and any other items are approximate and no responsibility is taken for any error, omission or mis-statement. This plan is for illustrative purposes only and should be used as such by any prospective purchaser. The services, systems and appliances shown have not been tested and no guarantee as to their operability or efficiency can be given.
Made with Metropix ©2023

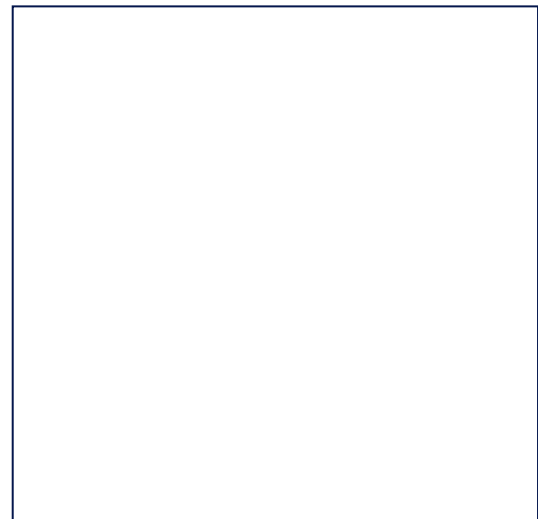
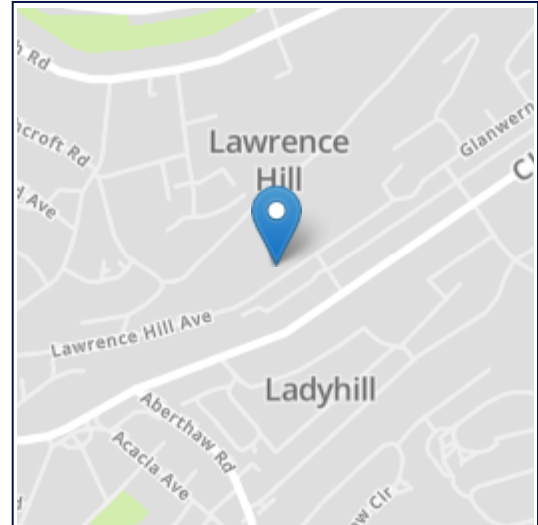

All room sizes are approximate. Electrical installations, plumbing, central heating and drainage installations are noted on the basis of a visual inspection only. They have not been tested and no warranty of condition or fitness for purpose is implied in their inclusion. Potential purchasers are warned that they must make their own enquiries as to the condition of the appliances, installations or any element of the structure or fabric of the property.

M2 Estate Agents for themselves and for the Vendors and Lessors of this property whose agents they are give notice that, (i) the particulars are set out as a general outline only for the guidance of the intended Purchasers or Lessors, and do not constitute part of an offer or contract (ii) all descriptions, dimensions, reference to condition and necessary permissions for the use and occupation and other details are given without responsibility and any intending Purchasers or Tenants should not rely on them as statements or representations of fact but satisfy themselves by inspection or otherwise as to the correctness of each of them (iii) no person in the employment of M2 Estate Agents has any authority to make or give any representation or warranty whatever in relation to this property.